

Section 10

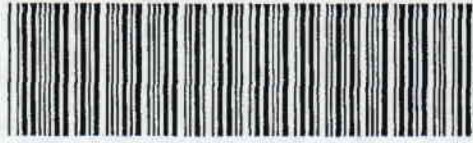

Site-Plan

Includes:

- a. Survey and Legal Description on the next following page
- b. Site Plans

Project No: 2005060002

Project Name:

HERITAGE BAY GOLF COURSE BOX#1967741

Application No: SDP-2005-AR-7904

OLD SDP NO:

Approval Date: 06/29/05

Township: 48S

Range: 26E

Section: 13/23/24

SITE DEVELOPMENT PLANS FOR
HERITAGE BAY
GOLF COURSE
 SECTIONS 13, 23 AND 24, TOWNSHIP 48 SOUTH, RANGE 26 EAST,
 COLLIER COUNTY, FLORIDA

A DEVELOPMENT BY
BAYVEST, LLC.
 10491 SIX MILE CYPRESS PARKWAY
 FORT MYERS, FL 33912
 (239) 278-1177

SIP 2014-001 REV 3
 DATE: 05/06/2014 THE DESIGN
 DRAWING DATE: 05/06/2014

A LEGAL DESCRIPTION

TRACTS GC-1, GC-2, GC-3, GC-4, GC-5,
 GC-6, GC-7, GC-8, GC-9, GC-10 OF
 HERITAGE BAY AS RECORDED IN PLAT BOOK 43,
 PAGES 18 THROUGH 40 OF THE PUBLIC
 RECORDS OF COLLIER COUNTY, FLORIDA.

LEGEND

ABBREVIATIONS

- CB BACK OF CURB or BACK OF UTILITY
- CO END OF PAVEMENT
- DR DRAINAGE PARALLEL
- L LAKE
- MA MAINTENANCE EASEMENT
- SR COUNTY W/ILEY EASEMENT
- TA TOWNSHIP
- EL. H. ELEV. ELEVATION
- EN EASEMENT
- FF FINISH
- IP INTERSECTION POINT
- INT NATIONAL QUOTED VERTICAL CURVE
- PL POINT OF VERTICAL INTERSECTION
- RC RIGHT OF WAY
- ST STREET
- W W/ILEY
- SP SPLITTY PILE
- FD FLORIDA DEPARTMENT OF TRANSPORTATION
- TEL. of PPA TELEPHONE NUMBER & LIGHT
- UT UNITED TELEPHONE OF FLORIDA
- W WATER LINE
- S SEWER LINE
- P PROPERTY LINE
- DM DIMENSIONED METAL PIPE
- DM DIMENSIONED CAST IRON PIPE
- DM DIMENSIONED POLYESTER PIPE
- DM DIMENSIONED POLYETHYLENE GLASS REINFORCED COMPOSITE PIPE
- DM DIMENSIONED HIGH DENSITY POLYETHYLENE
- DM DIMENSIONED ELECTRICAL REINFORCED COMPOSITE PIPE
- DM DIMENSIONED STORM WARE
- ST STORM WARE
- ST STREET LEFT or STREET RIGHT

SYMBOLS

- AIR RELEASE VALVE, COMPLETE
- IN-LINE VALVE W/ BOX
- FIRE HYDRANT, COMPLETE
- BLOW-OFF W/ BACTERIAL SAMPLE POINT
- BACTERIAL SAMPLE POINT
- BLOW-OFF
- PIP. PLUS
- WATER METER
- ERECTION METEOR
- METER
- BACKFLOW PREVENTER ABOVE GROUND METEOR
- SANITARY NEW WARE
- SANITARY SCUM LATERAL & CLEAR-OUT
- PUMP STATION
- STORM WARE & STRUCTURE
- HEADWALL
- CONTROL STRUCTURE
- METERED END/FLARED END SECTION
- PROPOSED ELEVATION
- EXISTING ELEVATION
- EXISTING ELEVATION
- DIRECTION OF DRAINAGE FLOW
- YIELD & DIRECTION OF FLOW
- HANDICAPPED PARKING SPACE
- UNDERDRAIN

NOTE: OPEN SYMBOLS AND DASHED LINES DENOTE EXISTING IMPROVEMENTS

ZONING: HERITAGE BAY PUD (ORD. 03-40)
 FOLIO # 0011818366, 0019012007 & 0019016009



LOCATION MAP

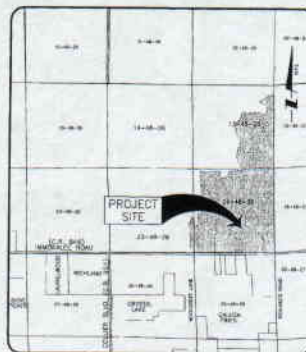

SITE MAP

INDEX TO SHEETS

NO.	DESCRIPTION
1	COURSE SHEET
2	GENERAL PLAN
3	HAZARDOUS WASTE PLAN
4	SITE PLAN-NORTH
5	SITE PLAN-SOUTH
6	PROPOSED UTILITIES
7	STREET PLAN AND CROSS SECTION DETAILS
8	PAVEMENT PLAN AND EROSION CONTROL DETAILS

NO.	DATE	DESCRIPTION
1	05/06/2014	ISSUE FOR PERMIT AND PERMIT AMENDMENTS

STATUS: REVISIONS		
PROJECT ENGINEER	PROJECT DESIGNER	PROJECT SURVEYOR
CHRISTOPHER C. HAYES PE, 8 8026	CHRISTOPHER M. FERRERA CS-19201-01	STEPHEN P. BRINK PSM 43070
CHECKED BY: <i>[Signature]</i>	DATE: 6-27-05	

PROJECT NUMBER
N0442-203-001

DATE	INDEX NUMBER
JUNE 2005	D-0442-133

WilsonMiller

Planners · Engineers · Ecologists · Surveyors · Landscape Architects · Transportation Consultants

WilsonMiller, Inc.

3200 Bailey Ave, Suite 201 - Naples Florida 34105-8507 - Phone 239-449-4040 - Fax 239-262-6484 - Web-Site www.wilsonmiller.com

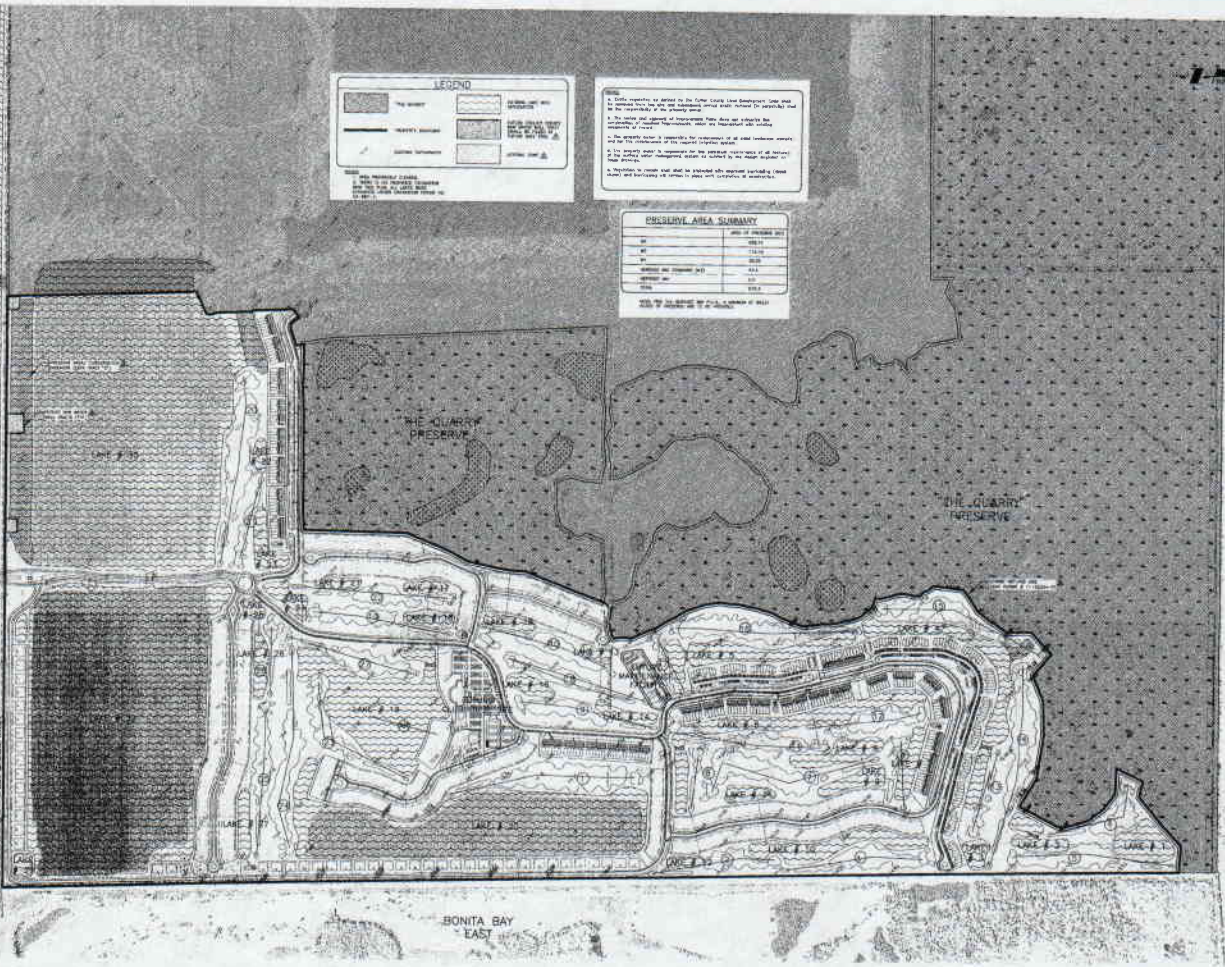

LEGEND

[Symbol]	Prop. Boundary	[Symbol]	Prop. Boundary
[Symbol]	Prop. Boundary	[Symbol]	Prop. Boundary
[Symbol]	Prop. Boundary	[Symbol]	Prop. Boundary

All data reported is derived from the Florida Aerial Photography and is subject to the accuracy of the photography and the accuracy of the ground truth data. The accuracy of the ground truth data is subject to the accuracy of the ground truth data. The accuracy of the ground truth data is subject to the accuracy of the ground truth data.

PRESERVE AREA SUMMARY

NO.	AREA IN ACRES (APX)
01	100.00
02	100.00
03	100.00
04	100.00
05	100.00
06	100.00
07	100.00
08	100.00
09	100.00
10	100.00
11	100.00
12	100.00
13	100.00
14	100.00
15	100.00

A. PROJECT SUMMARY:
HERITAGE BAY GOLF COURSE
SOUTH OF STATE ROAD 220, PALM BEACH COUNTY, FLORIDA

LAND USE SUMMARY - A		
TYPE OF USE	ACRES	PERCENT
RESIDENTIAL	1,287.75	64.38
COMMERCIAL	1,287.75	64.38
OPEN SPACE	1,287.75	64.38
TOTAL	1,287.75	64.38

1. TOTAL GOLF COURSE AREA: 1,287.75 ACRES

TYPE OF USE	ACRES
RESIDENTIAL	1,287.75
COMMERCIAL	1,287.75
OPEN SPACE	1,287.75

GENERAL NOTES:

DESCRIPTION OF WORK:

NO.	DESCRIPTION
1	GENERAL LAYOUT
2	ROADWAY LAYOUT
3	UTILITIES LAYOUT
4	LANDSCAPE LAYOUT
5	CONSTRUCTION LAYOUT

BUILDING HEIGHT STANDARDS:

ZONE	HEIGHT
RESIDENTIAL	35'
COMMERCIAL	35'
OPEN SPACE	35'

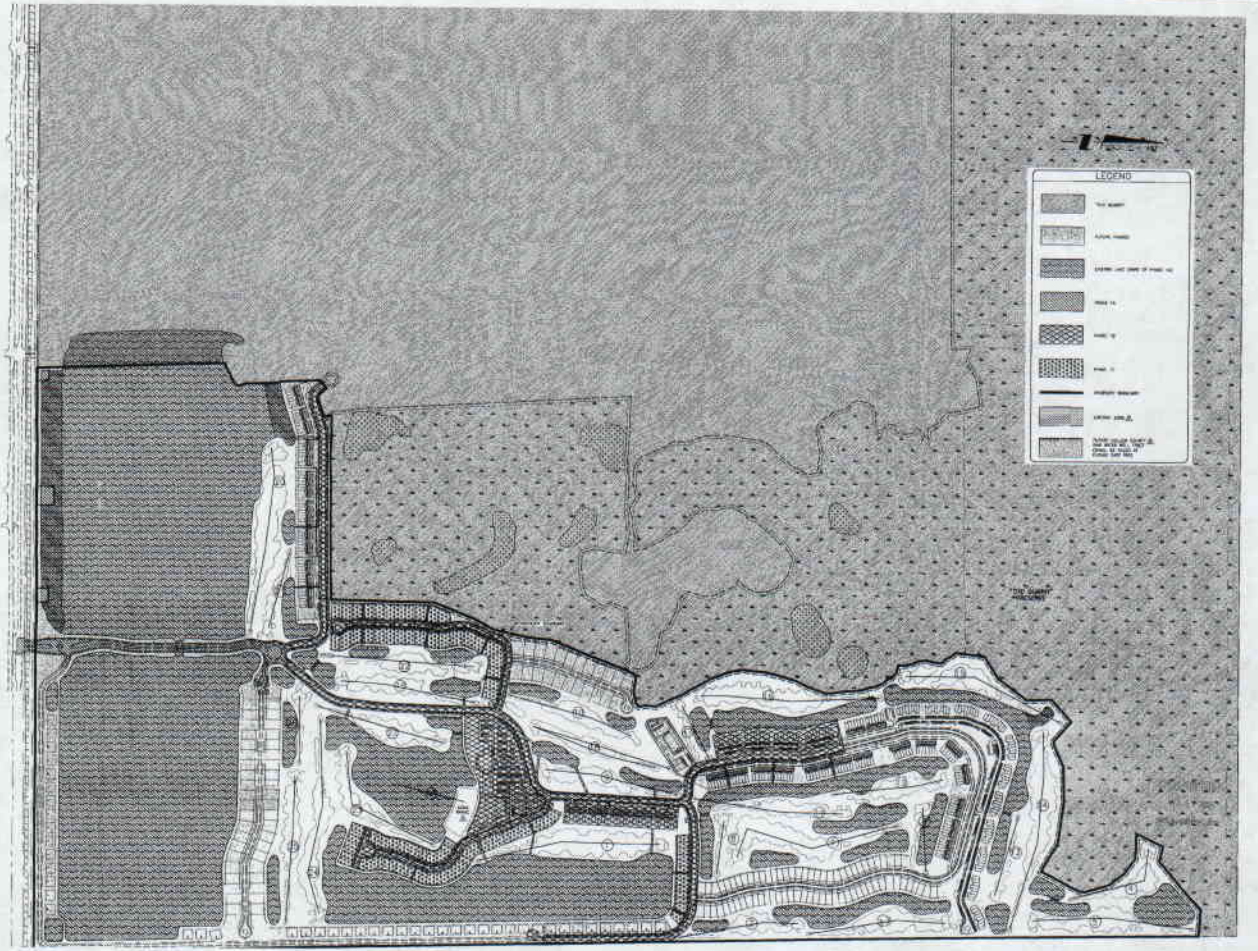



LEGEND

[Pattern]	WETLAND #4 (W4)
[Pattern]	WETLAND #5 (W5)
[Pattern]	WETLAND #6 (W6)
[Pattern]	WETLAND #7 (W7)
[Pattern]	WETLAND #8 (W8)
[Pattern]	WETLAND #9 (W9)
[Pattern]	WETLAND #10 (W10)
[Pattern]	WETLAND #11 (W11)
[Pattern]	WETLAND #12 (W12)
[Pattern]	WETLAND #13 (W13)
[Pattern]	WETLAND #14 (W14)
[Pattern]	WETLAND #15 (W15)
[Pattern]	WETLAND #16 (W16)
[Pattern]	WETLAND #17 (W17)
[Pattern]	WETLAND #18 (W18)
[Pattern]	WETLAND #19 (W19)
[Pattern]	WETLAND #20 (W20)
[Pattern]	WETLAND #21 (W21)
[Pattern]	WETLAND #22 (W22)
[Pattern]	WETLAND #23 (W23)
[Pattern]	WETLAND #24 (W24)
[Pattern]	WETLAND #25 (W25)
[Pattern]	WETLAND #26 (W26)
[Pattern]	WETLAND #27 (W27)
[Pattern]	WETLAND #28 (W28)
[Pattern]	WETLAND #29 (W29)
[Pattern]	WETLAND #30 (W30)
[Pattern]	WETLAND #31 (W31)
[Pattern]	WETLAND #32 (W32)
[Pattern]	WETLAND #33 (W33)
[Pattern]	WETLAND #34 (W34)
[Pattern]	WETLAND #35 (W35)
[Pattern]	WETLAND #36 (W36)
[Pattern]	WETLAND #37 (W37)
[Pattern]	WETLAND #38 (W38)
[Pattern]	WETLAND #39 (W39)
[Pattern]	WETLAND #40 (W40)
[Pattern]	WETLAND #41 (W41)
[Pattern]	WETLAND #42 (W42)
[Pattern]	WETLAND #43 (W43)
[Pattern]	WETLAND #44 (W44)
[Pattern]	WETLAND #45 (W45)
[Pattern]	WETLAND #46 (W46)
[Pattern]	WETLAND #47 (W47)
[Pattern]	WETLAND #48 (W48)
[Pattern]	WETLAND #49 (W49)
[Pattern]	WETLAND #50 (W50)
[Pattern]	WETLAND #51 (W51)
[Pattern]	WETLAND #52 (W52)
[Pattern]	WETLAND #53 (W53)
[Pattern]	WETLAND #54 (W54)
[Pattern]	WETLAND #55 (W55)
[Pattern]	WETLAND #56 (W56)
[Pattern]	WETLAND #57 (W57)
[Pattern]	WETLAND #58 (W58)
[Pattern]	WETLAND #59 (W59)
[Pattern]	WETLAND #60 (W60)
[Pattern]	WETLAND #61 (W61)
[Pattern]	WETLAND #62 (W62)
[Pattern]	WETLAND #63 (W63)
[Pattern]	WETLAND #64 (W64)
[Pattern]	WETLAND #65 (W65)
[Pattern]	WETLAND #66 (W66)
[Pattern]	WETLAND #67 (W67)
[Pattern]	WETLAND #68 (W68)
[Pattern]	WETLAND #69 (W69)
[Pattern]	WETLAND #70 (W70)
[Pattern]	WETLAND #71 (W71)
[Pattern]	WETLAND #72 (W72)
[Pattern]	WETLAND #73 (W73)
[Pattern]	WETLAND #74 (W74)
[Pattern]	WETLAND #75 (W75)
[Pattern]	WETLAND #76 (W76)
[Pattern]	WETLAND #77 (W77)
[Pattern]	WETLAND #78 (W78)
[Pattern]	WETLAND #79 (W79)
[Pattern]	WETLAND #80 (W80)
[Pattern]	WETLAND #81 (W81)
[Pattern]	WETLAND #82 (W82)
[Pattern]	WETLAND #83 (W83)
[Pattern]	WETLAND #84 (W84)
[Pattern]	WETLAND #85 (W85)
[Pattern]	WETLAND #86 (W86)
[Pattern]	WETLAND #87 (W87)
[Pattern]	WETLAND #88 (W88)
[Pattern]	WETLAND #89 (W89)
[Pattern]	WETLAND #90 (W90)
[Pattern]	WETLAND #91 (W91)
[Pattern]	WETLAND #92 (W92)
[Pattern]	WETLAND #93 (W93)
[Pattern]	WETLAND #94 (W94)
[Pattern]	WETLAND #95 (W95)
[Pattern]	WETLAND #96 (W96)
[Pattern]	WETLAND #97 (W97)
[Pattern]	WETLAND #98 (W98)
[Pattern]	WETLAND #99 (W99)
[Pattern]	WETLAND #100 (W100)

NOTES:
1. ALL DIMENSIONS ARE IN FEET UNLESS OTHERWISE SPECIFIED.
2. ALL DIMENSIONS ARE TO CENTERLINE UNLESS OTHERWISE SPECIFIED.
3. ALL DIMENSIONS ARE TO FACE UNLESS OTHERWISE SPECIFIED.
4. ALL DIMENSIONS ARE TO CENTERLINE UNLESS OTHERWISE SPECIFIED.

SEE SHEET 4 FOR CONTINUATION

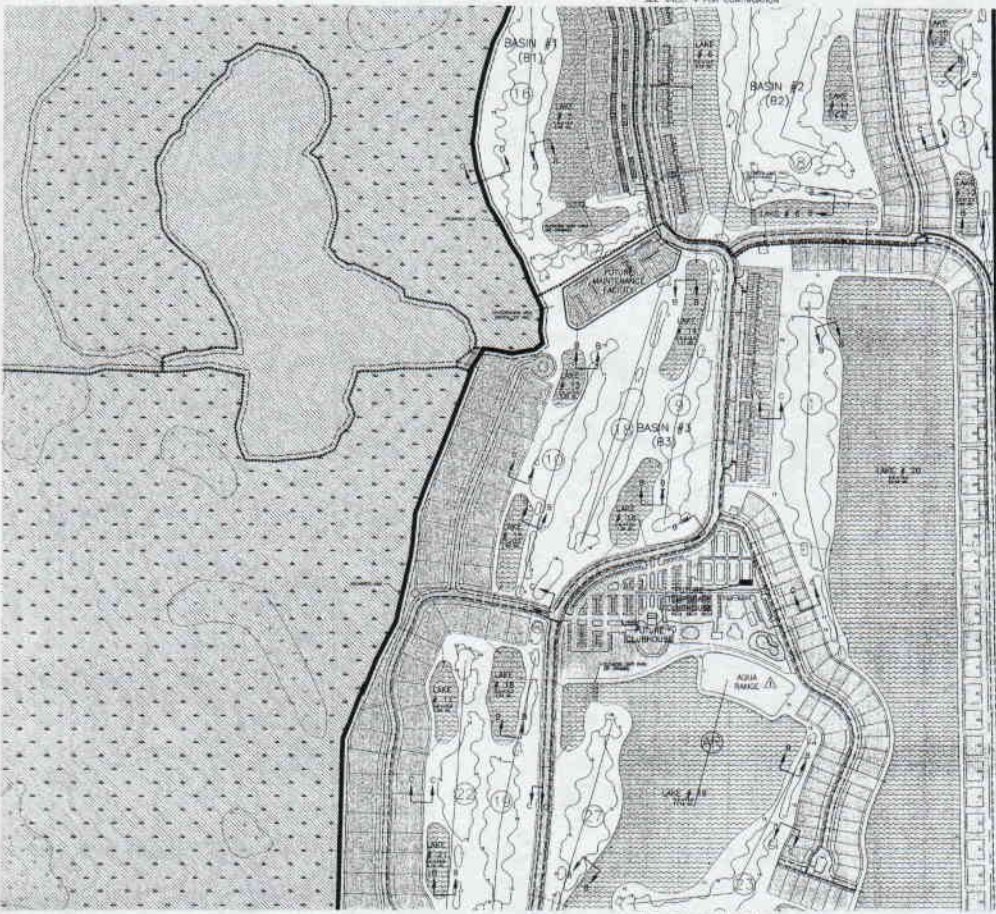

BONITA BAY EAST GOLF CLUB



KEY MAP

LEGEND

- WET AREAS OF THE POND
- WATER AREAS IN NATURAL AREAS
- POND CONSTRUCTION WITH WATER
- POND CONSTRUCTION WITHOUT WATER
- WET SWAMPS
- MARSH SWAMPS

SEE SHEET 8 FOR CONTINUATION

<p>WilsonMiller</p> <p>Survey - Planning - Design - Construction - Transportation</p> <p>11000 West 11th Street, Suite 100, Denver, CO 80202</p>		<p>CLIENT: BAYVEST, LLC.</p> <p>PROJECT: HERITAGE BAY GOLF COURSE</p>	<p>DATE: 11/11/09</p> <p>SCALE: AS SHOWN</p> <p>PROJECT NO: 00443-009-008</p>	<p>SITE: SITE PLAN - MID</p> <p>DATE: 11/11/09</p> <p>SCALE: AS SHOWN</p> <p>PROJECT NO: 00443-009-008</p>
---	--	---	---	--

SEE SHEET 5 FOR CONTINUATION

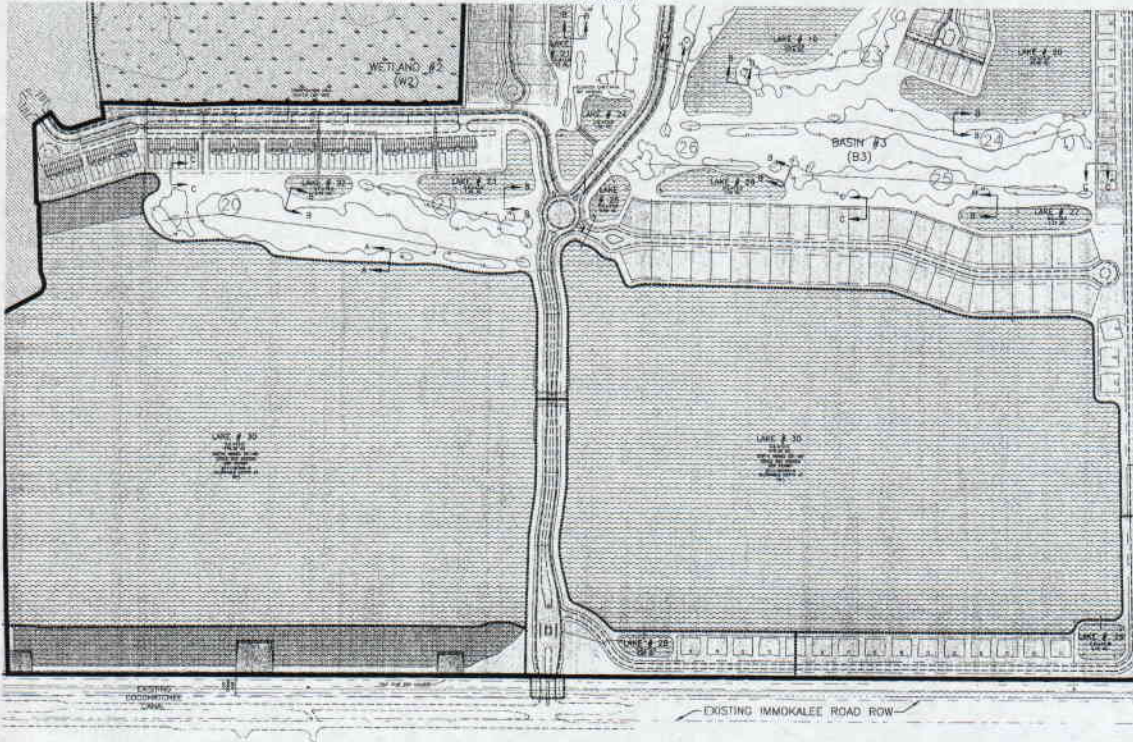

LEGEND

[Symbol]	WETLANDS OF THE STATE
[Symbol]	WATER BODIES OF THE STATE
[Symbol]	WATER BODIES OF THE COUNTY
[Symbol]	WATER BODIES OF THE DISTRICT
[Symbol]	WATER BODIES OF THE FEDERAL GOVERNMENT
[Symbol]	WATER BODIES OF THE STATE
[Symbol]	WATER BODIES OF THE COUNTY
[Symbol]	WATER BODIES OF THE DISTRICT
[Symbol]	WATER BODIES OF THE FEDERAL GOVERNMENT
[Symbol]	WATER BODIES OF THE STATE
[Symbol]	WATER BODIES OF THE COUNTY
[Symbol]	WATER BODIES OF THE DISTRICT
[Symbol]	WATER BODIES OF THE FEDERAL GOVERNMENT

BONITA BAY EAST GOLF CLUB

DATE: 11/11/10
 DRAWN BY: J. J. JONES
 CHECKED BY: J. J. JONES

WilsonMiller Surveying & Engineering, Inc. 11111 North Central Expressway, Suite 100 Dallas, Texas 75243 Phone: (972) 346-1000 Fax: (972) 346-1001		CLIENT: BAYVEST, LLC HERITAGE BAY GOLF COURSE	TITLE: SITE PLAN - SOUTH	PROJECT NO.: 10442-201-001-P1013	SHEET NO.: 133
---	--	---	------------------------------------	--	--------------------------

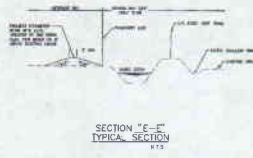
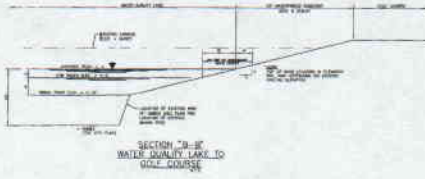
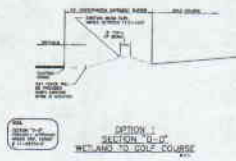
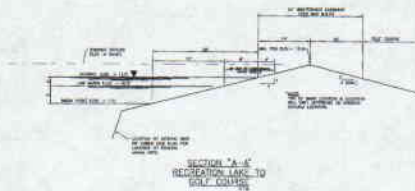

AS NOTED
 1/11/09
 WilsonMiller, Inc.

WilsonMiller <small>Survey • Design • Construction • Construction Administration • Inspection Services</small> Wilson Miller, Inc.		PROJECT: BAYVEST, LLC, HERITAGE BAY GOLF COURSE	SHEET: CROSS-SECTION DETAILS DATE: 11/11/09 SCALE: AS SHOWN	DRAWN BY: [Signature] CHECKED BY: [Signature] DATE: 11/11/09
--	--	---	---	--

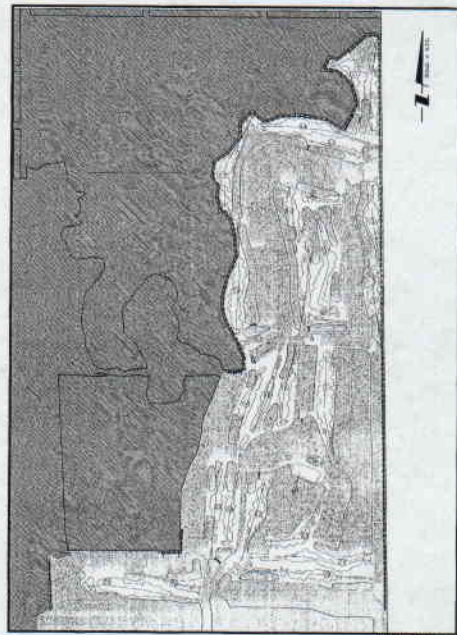
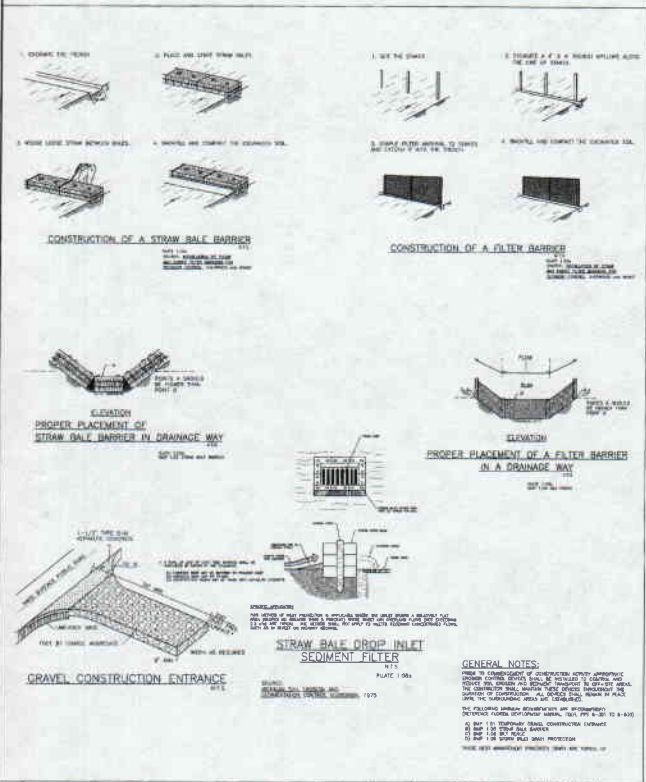

WilsonMiller <small>Surveying • Engineering • Planning • Construction • Environmental</small>		CLIENT: BAYVEST, L.L.C. PROJECT: HERITAGE BAY GOLF COURSE	SHEET: 1 OF 1 DATE: 08/11/11 DRAWN BY: J. BAYNE CHECKED BY: J. BAYNE	TITLE: SILT FENCE PLAN AND EROSION CONTROL DETAILS PROJECT NO: 10443-201-001-EP18 SHEET NO: 0-6462-1-33
---	--	--	---	---