

Section 10



Site-Plan

Includes:

- a. **Survey and Legal Description** on the next following page
- b. Site Plans

Project No: 2005080016

Project Name:

Heritage Bay Maintenance Facility Box #2102658

Application No: SDP-2006-AR-9327

OLD SDP NO:

Approval Date: 08/18/06

Township: 48S

Range: 26E

Section: 13

SITE DEVELOPMENT PLANS FOR
HERITAGE BAY
MAINTENANCE FACILITY
 SECTION 13, TOWNSHIP 48 SOUTH, RANGE 26 EAST,
 COLLIER COUNTY, FLORIDA

A DEVELOPMENT BY
BAYVEST, LLC.
 10491 SIX MILE CYPRESS PARKWAY
 FORT MYERS, FL 33912
 (239) 278-1177

ZONING: HERITAGE BAY PUD (ORD. 03-40)
 FPOID # 45800071540 &
 SURVEY: A PORTION OF 13-48-28 - PARCELS 1 & 2

LEGEND

ABBREVIATIONS

- BOC BACK OF CURB OR BACK OF GUTTER
- EOP EDGE OF PAVEMENT
- DE DRAINAGE EASEMENT
- LME LAKE MAINTENANCE EASEMENT
- UE UTILITY EASEMENT
- CUE COUNTY UTILITY EASEMENT
- EL. OF ELEV. ELEVATION
- IN INVERT
- LF LINEAR FEET
- NVD NATIONAL GEODETIC VERTICAL DATUM
- PVI POINT OF VERTICAL INTERSECTION
- NIC NOT IN CONTRACT
- R/W or ROW RIGHT OF WAY
- SB SPLIT BOXING
- STA STATION
- UT UTILITY POLE
- FDOT FLORIDA DEPARTMENT OF TRANSPORTATION
- CDTV CANAL COLLECTION
- FPL or FPL FLORIDA POWER & LIGHT
- UT UNITED TELEPHONE OF FLORIDA
- BL BASE LINE
- C CENTERLINE
- PL PROPERTY LINE
- CM CORRUGATED METAL PIPE
- DIP DUCTILE IRON PIPE
- PP POLYETHYLENE OR OTHER PIPE
- HP HIGH DENSITY POLYETHYLENE
- RCPP REINFORCED CONCRETE PIPE
- ERCP ELLIPTICAL REINFORCED CONCRETE PIPE
- SM MANHOLE
- STR STORM SEWER STRUCTURE
- X-XX' LT/X' RT FEET LEFT or FEET RIGHT

SYMBOLS

- AIR RELEASE VALVE, COMPLETE
- IN-LINE VALVE W/ BOX
- FIRE HYDRANT, COMPLETE
- B.O.B OFF W/ BACTERIAL SAMPLE POINT
- BACTERIAL SAMPLE POINT
- B.O.B OFF
- PIPE PILE
- WATER METER
- TRIBUTATION METER
- REDUCER
- BACKFLOW PREVENTER/ABOVE GROUND METER
- SANITARY SEWER MANHOLE
- SANITARY SEWER LATERAL & CLEAN-OUT
- PUMP STATION
- STORM SEWER STRUCTURE
- MANHOLE
- U-ENDBALL
- CONTROL STRUCTURE
- MITERED END/PLAED END SECTION
- PROPOSED ELEVATION
- PROPOSED PAVEMENT ELEVATION
- EXISTING ELEVATION
- EXISTING PAVEMENT ELEVATION
- DIRECTION OF DRAINAGE FLOW
- SWALE & DIRECTION OF FLOW
- HANDICAPPED PARKING SPACE
- GREENHAIN

NOTE: OPEN SYMBOLS AND DASHED LINES DENOTE EXISTING IMPROVEMENTS

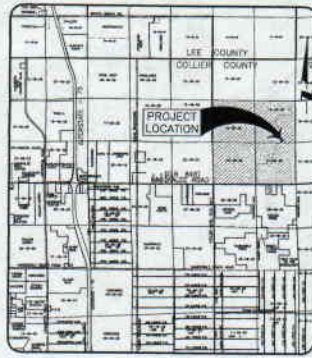

LOCATION MAP



SITE MAP

BASIC CONSTRUCTION TYPE PER FLORIDA BUILDING CODE:

MAINTENANCE BUILDING	TOTAL SQUARE FOOTAGE	NON-AIR CONDITIONED = 0 SF
AIR CONDITIONED = 8,990 SF		
SPRINKLERED BUILDING		
FERTILIZER STORAGE	TOTAL SQUARE FOOTAGE	NON-AIR CONDITIONED = 0 SF
AIR CONDITIONED = 0 SF		
NON-SPRINKLERED BUILDING		
NON-SPRINKLERED BUILDING	TOTAL SQUARE FOOTAGE	NON-AIR CONDITIONED = 1,400 SF
AIR CONDITIONED = 0 SF		
NON-SPRINKLERED BUILDING		
NON-SPRINKLERED BUILDING	TOTAL SQUARE FOOTAGE	NON-AIR CONDITIONED = 1,400 SF
AIR CONDITIONED = 0 SF		
NON-SPRINKLERED BUILDING		

INDEX TO SHEETS

SHEET NO.	DESCRIPTION
1	COVER SHEET
2	ACTUAL
3	WATER, SEWER AND IRRIGATION CONSTRUCTION NOTES AND SPECIFICATIONS
4	ZONING DATA SHEET
5	MASTER SITE PLAN
6	PAVING, DRAINAGE AND CROSS SECTION DETAILS
7	STANDARD WATER MAIN DETAILS
8	STANDARD SANITARY SEWER DETAILS
9	EROSION CONTROL AND SILT FENCE PLAN

STATUS / REVISIONS

ENGINEER OF RECORD CHRISTOPHER C. HAYES P.E. & REGISTERED	PROJECT DESIGNER ANDREW T. HOLLAND EIT	PROJECT SURVEYOR STEPHEN P. EBER P.L.M. & SURV.
---	--	---

PROJECT NUMBER N0442-203-001
DATE MARCH 2006
INDEX NUMBER D-0442-169

WilsonMiller

Planners • Engineers • Ecologists • Surveyors • Landscape Architects • Transportation Consultants
 WilsonMiller, Inc.

3000 Bailey Ave., Suite 200 • Naples, Florida 34105-8507 • Phone 239-649-4040 • Fax 239-253-6494 • Web Site www.wilsonmiller.com

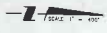
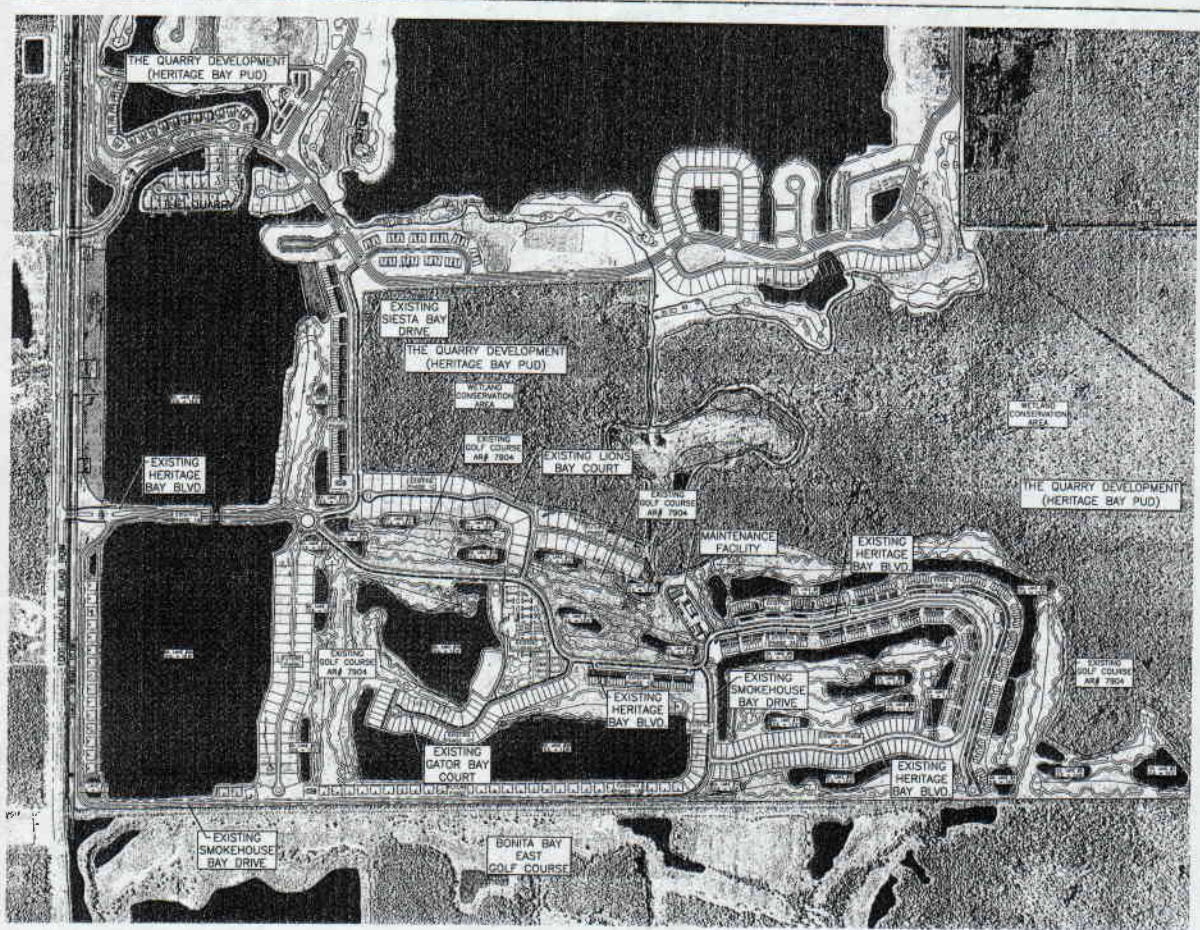

LEGEND	
[Symbol]	EXISTING ROAD
[Symbol]	EXISTING DRIVE
[Symbol]	EXISTING DRIVE
[Symbol]	EXISTING DRIVE

- NOTES**
1. THIS PROJECT IS SUBJECT TO THE COUNTY PLANNING AND DEVELOPMENT DEPARTMENT'S REVIEW AND APPROVAL. THE CLIENT SHALL BE RESPONSIBLE FOR OBTAINING ALL NECESSARY PERMITS AND APPROVALS FROM THE COUNTY PLANNING AND DEVELOPMENT DEPARTMENT.
 2. THE CLIENT SHALL BE RESPONSIBLE FOR OBTAINING ALL NECESSARY PERMITS AND APPROVALS FROM THE COUNTY PLANNING AND DEVELOPMENT DEPARTMENT.
 3. THE CLIENT SHALL BE RESPONSIBLE FOR OBTAINING ALL NECESSARY PERMITS AND APPROVALS FROM THE COUNTY PLANNING AND DEVELOPMENT DEPARTMENT.
 4. THE CLIENT SHALL BE RESPONSIBLE FOR OBTAINING ALL NECESSARY PERMITS AND APPROVALS FROM THE COUNTY PLANNING AND DEVELOPMENT DEPARTMENT.
 5. THE CLIENT SHALL BE RESPONSIBLE FOR OBTAINING ALL NECESSARY PERMITS AND APPROVALS FROM THE COUNTY PLANNING AND DEVELOPMENT DEPARTMENT.
 6. THE CLIENT SHALL BE RESPONSIBLE FOR OBTAINING ALL NECESSARY PERMITS AND APPROVALS FROM THE COUNTY PLANNING AND DEVELOPMENT DEPARTMENT.

NOTES	
1.	EXISTING ROAD
2.	EXISTING DRIVE
3.	EXISTING DRIVE
4.	EXISTING DRIVE

<table border="1"> <tr> <td>DATE</td> <td>DESCRIPTION</td> </tr> <tr> <td> </td> <td> </td> </tr> <tr> <td> </td> <td> </td> </tr> <tr> <td> </td> <td> </td> </tr> </table>	DATE	DESCRIPTION							<p>WilsonMiller</p> <p>PLANNING ENGINEERING ARCHITECTURE</p> <p>1000 N. GULF BLVD., SUITE 1000, TAMPA, FL 33604</p> <p>TEL: 813.288.1100 FAX: 813.288.1101</p> <p>WWW.WILSONMILLER.COM</p>	<p>CLIENT: BAYWEST, LLC.</p> <p>PROJECT: HERITAGE BAY MAINTENANCE FACILITY</p>	<p>DATE: 11/11/11</p> <p>SCALE: AS SHOWN</p> <p>PROJECT NO: 11-001</p> <p>DATE: 11/11/11</p> <p>SCALE: AS SHOWN</p>	<p>TITLE: AERIAL</p> <p>NO. 442-293-001-PLP1C</p> <p>DATE: 11/11/11</p> <p>SCALE: AS SHOWN</p>	<p>DATE: 11/11/11</p> <p>SCALE: AS SHOWN</p> <p>PROJECT NO: 11-001</p> <p>DATE: 11/11/11</p> <p>SCALE: AS SHOWN</p>
DATE	DESCRIPTION												

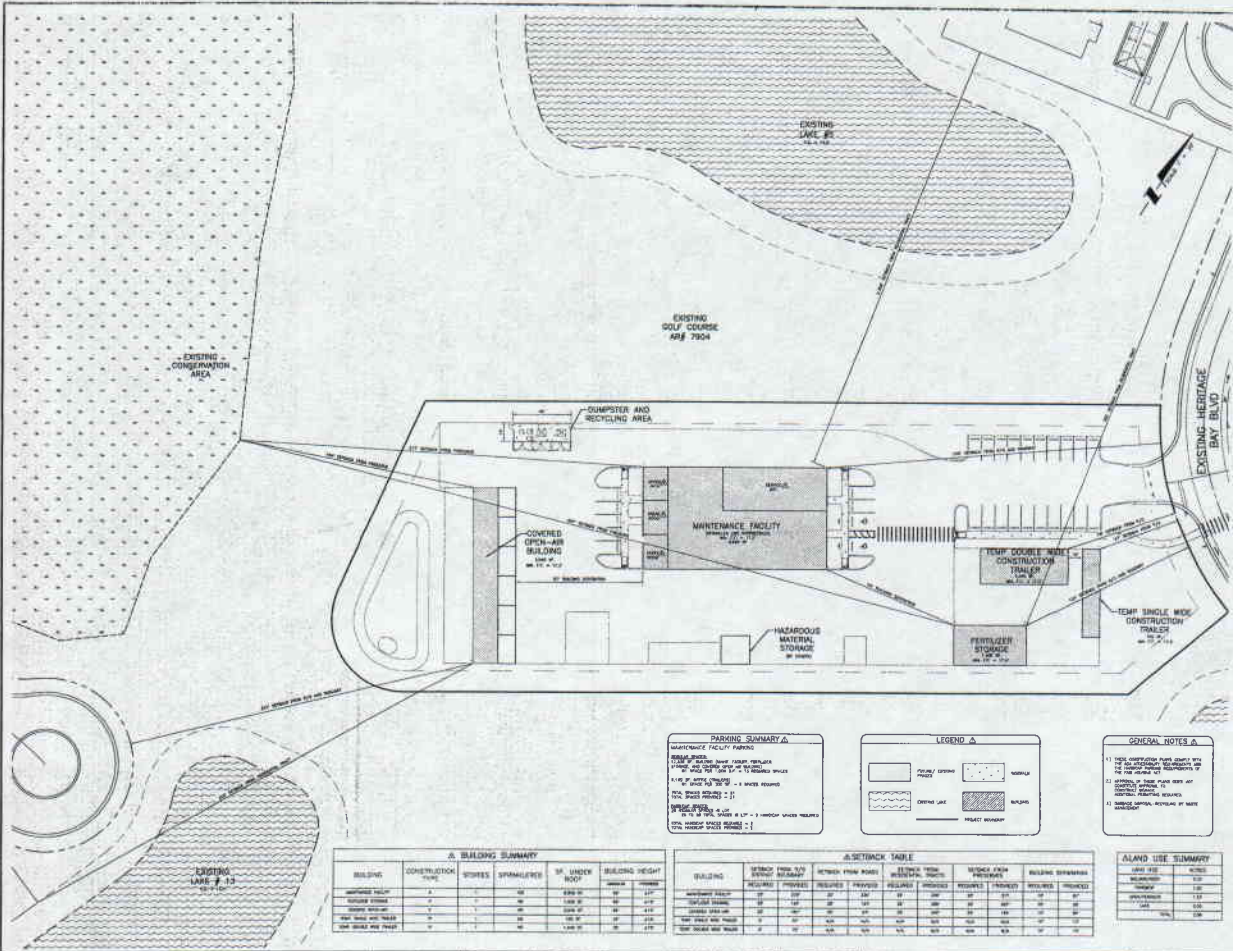

A RECREATIONAL/OPEN SPACE DEVELOPMENT STANDARDS FOR SECTION 3.14 OF HERITAGE BAY P.I.D.

17. Development Standards

- 17.1. The site shall be developed in accordance with the standards set forth in this section.
- 17.2. The site shall be developed in accordance with the standards set forth in this section.
- 17.3. The site shall be developed in accordance with the standards set forth in this section.
- 17.4. The site shall be developed in accordance with the standards set forth in this section.
- 17.5. The site shall be developed in accordance with the standards set forth in this section.
- 17.6. The site shall be developed in accordance with the standards set forth in this section.
- 17.7. The site shall be developed in accordance with the standards set forth in this section.
- 17.8. The site shall be developed in accordance with the standards set forth in this section.
- 17.9. The site shall be developed in accordance with the standards set forth in this section.
- 17.10. The site shall be developed in accordance with the standards set forth in this section.

DEVELOPMENT STANDARDS FOR SECTION 3.14 OF HERITAGE BAY P.I.D.

1.4.4. GENERAL IDENTIFICATION

1.4.4.1. General Identification

- 1.4.4.1.1. The site shall be developed in accordance with the standards set forth in this section.
- 1.4.4.1.2. The site shall be developed in accordance with the standards set forth in this section.
- 1.4.4.1.3. The site shall be developed in accordance with the standards set forth in this section.
- 1.4.4.1.4. The site shall be developed in accordance with the standards set forth in this section.
- 1.4.4.1.5. The site shall be developed in accordance with the standards set forth in this section.
- 1.4.4.1.6. The site shall be developed in accordance with the standards set forth in this section.
- 1.4.4.1.7. The site shall be developed in accordance with the standards set forth in this section.
- 1.4.4.1.8. The site shall be developed in accordance with the standards set forth in this section.
- 1.4.4.1.9. The site shall be developed in accordance with the standards set forth in this section.
- 1.4.4.1.10. The site shall be developed in accordance with the standards set forth in this section.

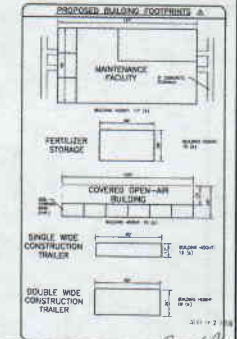

PARKING SUMMARY

MAINTENANCE FACILITY PARKING

1. MAINTENANCE FACILITY PARKING

2. MAINTENANCE FACILITY PARKING

3. MAINTENANCE FACILITY PARKING

4. MAINTENANCE FACILITY PARKING

5. MAINTENANCE FACILITY PARKING

6. MAINTENANCE FACILITY PARKING

7. MAINTENANCE FACILITY PARKING

8. MAINTENANCE FACILITY PARKING

9. MAINTENANCE FACILITY PARKING

10. MAINTENANCE FACILITY PARKING

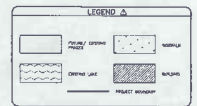

GENERAL NOTES

1. THE SITE SHALL BE DEVELOPED IN ACCORDANCE WITH THE STANDARDS SET FORTH IN THIS SECTION.
2. THE SITE SHALL BE DEVELOPED IN ACCORDANCE WITH THE STANDARDS SET FORTH IN THIS SECTION.
3. THE SITE SHALL BE DEVELOPED IN ACCORDANCE WITH THE STANDARDS SET FORTH IN THIS SECTION.
4. THE SITE SHALL BE DEVELOPED IN ACCORDANCE WITH THE STANDARDS SET FORTH IN THIS SECTION.
5. THE SITE SHALL BE DEVELOPED IN ACCORDANCE WITH THE STANDARDS SET FORTH IN THIS SECTION.
6. THE SITE SHALL BE DEVELOPED IN ACCORDANCE WITH THE STANDARDS SET FORTH IN THIS SECTION.
7. THE SITE SHALL BE DEVELOPED IN ACCORDANCE WITH THE STANDARDS SET FORTH IN THIS SECTION.
8. THE SITE SHALL BE DEVELOPED IN ACCORDANCE WITH THE STANDARDS SET FORTH IN THIS SECTION.
9. THE SITE SHALL BE DEVELOPED IN ACCORDANCE WITH THE STANDARDS SET FORTH IN THIS SECTION.
10. THE SITE SHALL BE DEVELOPED IN ACCORDANCE WITH THE STANDARDS SET FORTH IN THIS SECTION.

BUILDING SUMMARY

BUILDING	CONSTRUCTION TYPE	STORIES	SPANNERS	SF UNDER ROOF	BUILDING HEIGHT
MAINTENANCE FACILITY	A	1	40	8000 SF	10 FT
COVERED OPEN-AIR BUILDING	B	1	40	1000 SF	10 FT
HAZARDOUS MATERIAL STORAGE	C	1	40	1000 SF	10 FT
FERTILIZER STORAGE	D	1	40	1000 SF	10 FT
TEMP DOUBLE WIDE CONSTRUCTION TRAILER	E	1	40	1000 SF	10 FT
TEMP SINGLE WIDE CONSTRUCTION TRAILER	F	1	40	1000 SF	10 FT

SETBACK TABLE

BUILDING	SETBACK FROM SIDE		SETBACK FROM REAR		SETBACK FROM FRONT		SETBACK FROM CORNER	
	REQUIRED	PROPOSED	REQUIRED	PROPOSED	REQUIRED	PROPOSED	REQUIRED	PROPOSED
MAINTENANCE FACILITY	10'	10'	10'	10'	10'	10'	10'	10'
COVERED OPEN-AIR BUILDING	10'	10'	10'	10'	10'	10'	10'	10'
HAZARDOUS MATERIAL STORAGE	10'	10'	10'	10'	10'	10'	10'	10'
FERTILIZER STORAGE	10'	10'	10'	10'	10'	10'	10'	10'
TEMP DOUBLE WIDE CONSTRUCTION TRAILER	10'	10'	10'	10'	10'	10'	10'	10'
TEMP SINGLE WIDE CONSTRUCTION TRAILER	10'	10'	10'	10'	10'	10'	10'	10'

LAND USE SUMMARY

LAND USE	AREA (SQ FT)	PERCENT
MAINTENANCE FACILITY	8000	10.0%
COVERED OPEN-AIR BUILDING	1000	1.25%
HAZARDOUS MATERIAL STORAGE	1000	1.25%
FERTILIZER STORAGE	1000	1.25%
TEMP DOUBLE WIDE CONSTRUCTION TRAILER	1000	1.25%
TEMP SINGLE WIDE CONSTRUCTION TRAILER	1000	1.25%

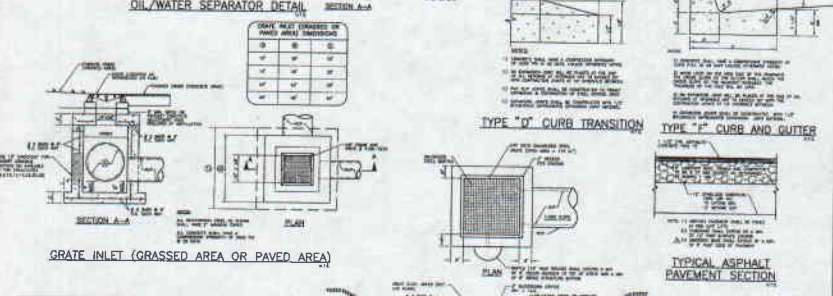
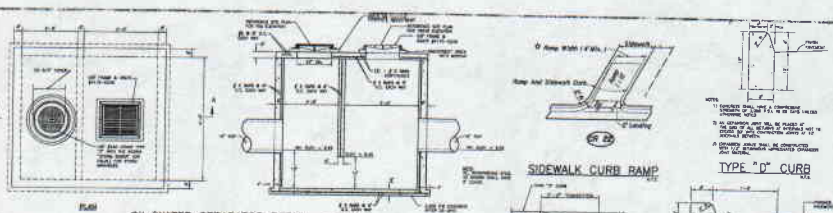
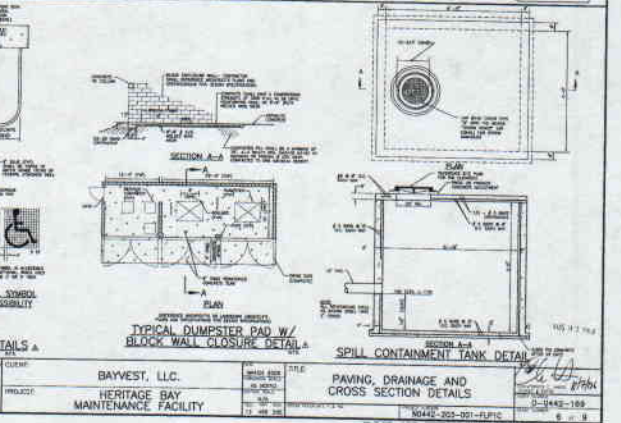
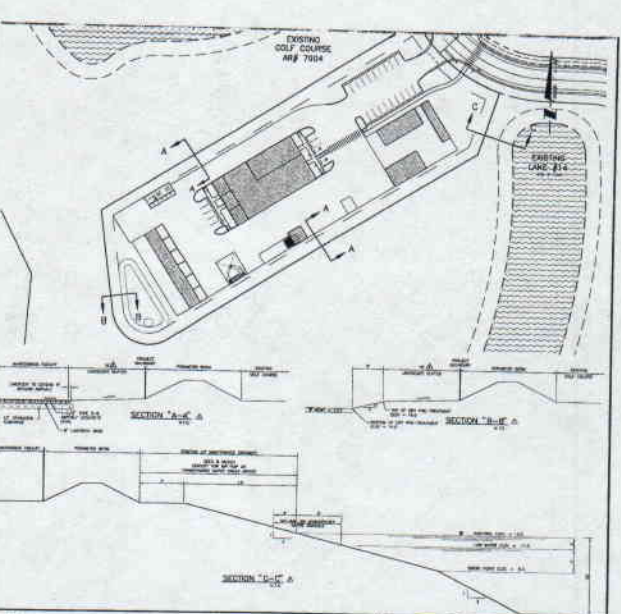
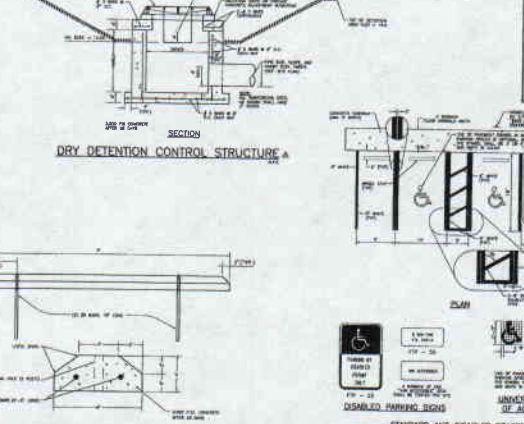
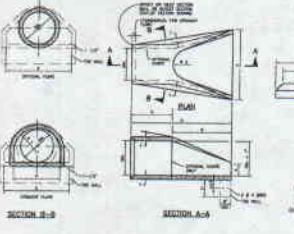

TABLE 1

NO.	DESCRIPTION	QTY	UNIT
1	1/2" x 1/2" x 1/4" GRATE	100	SQ. YD.
2	1/4" THICK CURB	100	LINEAL FT.
3	1/2" THICK CURB	100	LINEAL FT.
4	1/4" THICK CURB	100	LINEAL FT.
5	1/2" THICK CURB	100	LINEAL FT.
6	1/4" THICK CURB	100	LINEAL FT.
7	1/2" THICK CURB	100	LINEAL FT.
8	1/4" THICK CURB	100	LINEAL FT.
9	1/2" THICK CURB	100	LINEAL FT.
10	1/4" THICK CURB	100	LINEAL FT.

DESIGN NOTES:

1. CURB AND GRATE ARE TO BE SET TO THE FINISH GRADE OF THE PAVED AREA.
2. CURB AND GRATE ARE TO BE SET TO THE FINISH GRADE OF THE GRASSED AREA.
3. CURB AND GRATE ARE TO BE SET TO THE FINISH GRADE OF THE SIDEWALK.
4. CURB AND GRATE ARE TO BE SET TO THE FINISH GRADE OF THE DRIVEWAY.
5. CURB AND GRATE ARE TO BE SET TO THE FINISH GRADE OF THE PARKING AREA.
6. CURB AND GRATE ARE TO BE SET TO THE FINISH GRADE OF THE TRAILER AREA.
7. CURB AND GRATE ARE TO BE SET TO THE FINISH GRADE OF THE SERVICE AREA.
8. CURB AND GRATE ARE TO BE SET TO THE FINISH GRADE OF THE LOADING AREA.
9. CURB AND GRATE ARE TO BE SET TO THE FINISH GRADE OF THE UNLOADING AREA.
10. CURB AND GRATE ARE TO BE SET TO THE FINISH GRADE OF THE STORAGE AREA.



<p>WilsonMiller</p> <p>4000 Wilson Miller Blvd., Suite 100, Dallas, TX 75242-1001, Texas 972-350-0001 Fax 972-350-0001</p>		<p>BAYVEST, LLC.</p> <p>HERITAGE BAY MAINTENANCE FACILITY</p>		<p>PAVING, DRAINAGE AND CROSS SECTION DETAILS</p> <p>NO. 442-100-FLPIC</p>	
<p>DESIGNED BY: [Signature]</p> <p>CHECKED BY: [Signature]</p> <p>DATE: 10/10/10</p>	<p>PROJECT NO: 1000000000</p> <p>DATE: 10/10/10</p>	<p>SCALE: AS SHOWN</p>	<p>DATE: 10/10/10</p>	<p>NO. 442-100-FLPIC</p>	<p>6 of 8</p>

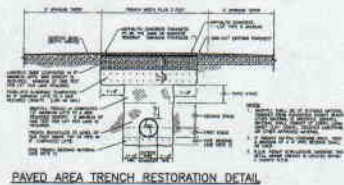

PAVED AREA TRENCH RESTORATION DETAIL

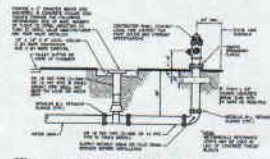

DEAD-END/FLUSHING FIRE HYDRANT DETAIL

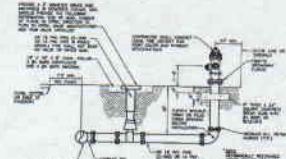

FIRE HYDRANT DETAIL

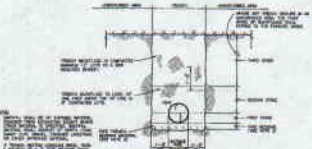

UNPAVED AREA TRENCH RESTORATION DETAIL

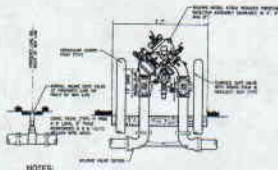

- NOTES:
1. DETECTOR HEAD SHALL BE INSTALLED UPSTREAM OF CHECK VALVE.
 2. DETECTOR HEAD SHALL BE INSTALLED UPSTREAM OF CHECK VALVE.
 3. DETECTOR HEAD SHALL BE INSTALLED UPSTREAM OF CHECK VALVE.
 4. DETECTOR HEAD SHALL BE INSTALLED UPSTREAM OF CHECK VALVE.
 5. DETECTOR HEAD SHALL BE INSTALLED UPSTREAM OF CHECK VALVE.
 6. DETECTOR HEAD SHALL BE INSTALLED UPSTREAM OF CHECK VALVE.
 7. DETECTOR HEAD SHALL BE INSTALLED UPSTREAM OF CHECK VALVE.
 8. DETECTOR HEAD SHALL BE INSTALLED UPSTREAM OF CHECK VALVE.
 9. DETECTOR HEAD SHALL BE INSTALLED UPSTREAM OF CHECK VALVE.
 10. DETECTOR HEAD SHALL BE INSTALLED UPSTREAM OF CHECK VALVE.

COMPACT FIRE SYSTEM DETECTOR CHECK ASSEMBLY DETAIL WITH CONNECTIONS PERMITTED DOWNSTREAM (WILKINS) (4", 6" AND 8")

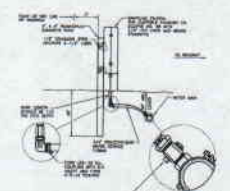

PERMANENT BACTERIAL SAMPLE POINT DETAIL

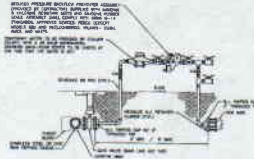

- NOTES:
1. THIS CONNECTION IS TO BE INSTALLED IN ACCORDANCE WITH THE FOLLOWING NOTES.
 2. ALL CONNECTIONS TO BE INSTALLED IN ACCORDANCE WITH THE FOLLOWING NOTES.
 3. ALL CONNECTIONS TO BE INSTALLED IN ACCORDANCE WITH THE FOLLOWING NOTES.
 4. ALL CONNECTIONS TO BE INSTALLED IN ACCORDANCE WITH THE FOLLOWING NOTES.
 5. ALL CONNECTIONS TO BE INSTALLED IN ACCORDANCE WITH THE FOLLOWING NOTES.
 6. ALL CONNECTIONS TO BE INSTALLED IN ACCORDANCE WITH THE FOLLOWING NOTES.
 7. ALL CONNECTIONS TO BE INSTALLED IN ACCORDANCE WITH THE FOLLOWING NOTES.
 8. ALL CONNECTIONS TO BE INSTALLED IN ACCORDANCE WITH THE FOLLOWING NOTES.
 9. ALL CONNECTIONS TO BE INSTALLED IN ACCORDANCE WITH THE FOLLOWING NOTES.
 10. ALL CONNECTIONS TO BE INSTALLED IN ACCORDANCE WITH THE FOLLOWING NOTES.

CONNECTION TO EXISTING WATER MAIN DETAIL (GAP CONFIGURATION)



CROSSOVER DETAIL



NEW & EXISTING PIPE - RESTRAINED JOINT

RESTRAINED JOINT PIPE DIMENSIONS FOR NEW PIPE (IN FEET)

PIPE SIZE (IN)	MINIMUM COVER (IN)	MINIMUM COVER (FEET)
4	18	1.5
6	24	2.0
8	30	2.5
10	36	3.0
12	42	3.5
15	54	4.5
18	66	5.5
21	78	6.5
24	90	7.5
30	108	9.0
36	126	10.5
42	144	12.0
48	162	13.5
54	180	15.0
60	198	16.5
66	216	18.0
72	234	19.5
78	252	21.0
84	270	22.5
90	288	24.0
96	306	25.5
102	324	27.0
108	342	28.5
114	360	30.0
120	378	31.5
126	396	33.0
132	414	34.5
138	432	36.0
144	450	37.5
150	468	39.0
156	486	40.5
162	504	42.0
168	522	43.5
174	540	45.0
180	558	46.5
186	576	48.0
192	594	49.5
198	612	51.0
204	630	52.5
210	648	54.0
216	666	55.5
222	684	57.0
228	702	58.5
234	720	60.0
240	738	61.5
246	756	63.0
252	774	64.5
258	792	66.0
264	810	67.5
270	828	69.0
276	846	70.5
282	864	72.0
288	882	73.5
294	900	75.0
300	918	76.5
306	936	78.0
312	954	79.5
318	972	81.0
324	990	82.5
330	1008	84.0
336	1026	85.5
342	1044	87.0
348	1062	88.5
354	1080	90.0
360	1098	91.5
366	1116	93.0
372	1134	94.5
378	1152	96.0
384	1170	97.5
390	1188	99.0
396	1206	100.5
402	1224	102.0
408	1242	103.5
414	1260	105.0
420	1278	106.5
426	1296	108.0
432	1314	109.5
438	1332	111.0
444	1350	112.5
450	1368	114.0
456	1386	115.5
462	1404	117.0
468	1422	118.5
474	1440	120.0
480	1458	121.5
486	1476	123.0
492	1494	124.5
498	1512	126.0
504	1530	127.5
510	1548	129.0
516	1566	130.5
522	1584	132.0
528	1602	133.5
534	1620	135.0
540	1638	136.5
546	1656	138.0
552	1674	139.5
558	1692	141.0
564	1710	142.5
570	1728	144.0
576	1746	145.5
582	1764	147.0
588	1782	148.5
594	1800	150.0
600	1818	151.5
606	1836	153.0
612	1854	154.5
618	1872	156.0
624	1890	157.5
630	1908	159.0
636	1926	160.5
642	1944	162.0
648	1962	163.5
654	1980	165.0
660	1998	166.5
666	2016	168.0
672	2034	169.5
678	2052	171.0
684	2070	172.5
690	2088	174.0
696	2106	175.5
702	2124	177.0
708	2142	178.5
714	2160	180.0
720	2178	181.5
726	2196	183.0
732	2214	184.5
738	2232	186.0
744	2250	187.5
750	2268	189.0
756	2286	190.5
762	2304	192.0
768	2322	193.5
774	2340	195.0
780	2358	196.5
786	2376	198.0
792	2394	199.5
798	2412	201.0
804	2430	202.5
810	2448	204.0
816	2466	205.5
822	2484	207.0
828	2502	208.5
834	2520	210.0
840	2538	211.5
846	2556	213.0
852	2574	214.5
858	2592	216.0
864	2610	217.5
870	2628	219.0
876	2646	220.5
882	2664	222.0
888	2682	223.5
894	2700	225.0
900	2718	226.5
906	2736	228.0
912	2754	229.5
918	2772	231.0
924	2790	232.5
930	2808	234.0
936	2826	235.5
942	2844	237.0
948	2862	238.5
954	2880	240.0
960	2898	241.5
966	2916	243.0
972	2934	244.5
978	2952	246.0
984	2970	247.5
990	2988	249.0
996	3006	250.5
1002	3024	252.0

PIPE CONFLICT DETAIL

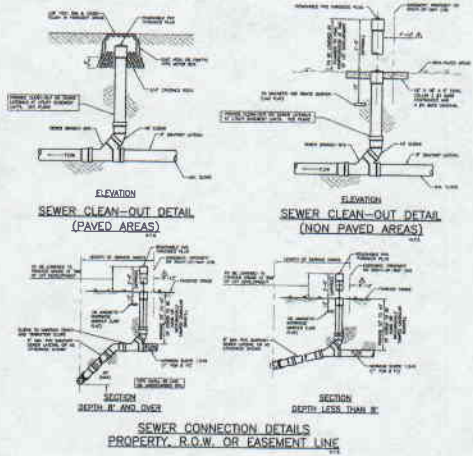

NOTES

1. ALL DIMENSIONS UNLESS OTHERWISE NOTED ARE IN FEET AND INCHES.
2. ALL DIMENSIONS SHALL BE TO FACE UNLESS OTHERWISE NOTED.
3. ALL DIMENSIONS SHALL BE TO CENTER UNLESS OTHERWISE NOTED.
4. ALL DIMENSIONS SHALL BE TO CENTER UNLESS OTHERWISE NOTED.
5. ALL DIMENSIONS SHALL BE TO CENTER UNLESS OTHERWISE NOTED.
6. ALL DIMENSIONS SHALL BE TO CENTER UNLESS OTHERWISE NOTED.
7. ALL DIMENSIONS SHALL BE TO CENTER UNLESS OTHERWISE NOTED.
8. ALL DIMENSIONS SHALL BE TO CENTER UNLESS OTHERWISE NOTED.
9. ALL DIMENSIONS SHALL BE TO CENTER UNLESS OTHERWISE NOTED.
10. ALL DIMENSIONS SHALL BE TO CENTER UNLESS OTHERWISE NOTED.

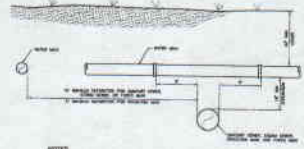

NOTES

1. ALL DIMENSIONS UNLESS OTHERWISE NOTED ARE IN FEET AND INCHES.
2. ALL DIMENSIONS SHALL BE TO FACE UNLESS OTHERWISE NOTED.
3. ALL DIMENSIONS SHALL BE TO CENTER UNLESS OTHERWISE NOTED.
4. ALL DIMENSIONS SHALL BE TO CENTER UNLESS OTHERWISE NOTED.
5. ALL DIMENSIONS SHALL BE TO CENTER UNLESS OTHERWISE NOTED.
6. ALL DIMENSIONS SHALL BE TO CENTER UNLESS OTHERWISE NOTED.
7. ALL DIMENSIONS SHALL BE TO CENTER UNLESS OTHERWISE NOTED.
8. ALL DIMENSIONS SHALL BE TO CENTER UNLESS OTHERWISE NOTED.
9. ALL DIMENSIONS SHALL BE TO CENTER UNLESS OTHERWISE NOTED.
10. ALL DIMENSIONS SHALL BE TO CENTER UNLESS OTHERWISE NOTED.

WilsonMiller <small>Professional Engineering & Surveying</small> <small>Heritage Bay Maintenance Facility</small>		CLIENT: BAYVEST, LLC	TITLE: STANDARD SANITARY SEWER DETAILS
PROJECT: HERITAGE BAY MAINTENANCE FACILITY	DATE: 11/11/11	SCALE: AS SHOWN	PROJECT NO.: 10441-203-001-1211C

11/11/11

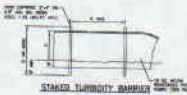
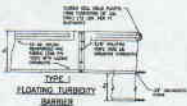

GENERAL NOTES:

1. THIS BARRIER IS TO BE USED TO PREVENT EROSION OF THE SOIL SURFACE AND TO PREVENT THE CARRY-OVER OF SOIL AND SEDIMENT TO THE RECEIVING WATER BODY.
2. THE BARRIER SHALL BE INSTALLED UPSTREAM OF THE RECEIVING WATER BODY AND SHALL BE MAINTAINED AT ALL TIMES.
3. THE BARRIER SHALL BE INSTALLED IN A LINE WITH THE CENTERLINE OF THE RECEIVING WATER BODY.
4. THE BARRIER SHALL BE INSTALLED IN A LINE WITH THE CENTERLINE OF THE RECEIVING WATER BODY.
5. THE BARRIER SHALL BE INSTALLED IN A LINE WITH THE CENTERLINE OF THE RECEIVING WATER BODY.
6. THE BARRIER SHALL BE INSTALLED IN A LINE WITH THE CENTERLINE OF THE RECEIVING WATER BODY.
7. THE BARRIER SHALL BE INSTALLED IN A LINE WITH THE CENTERLINE OF THE RECEIVING WATER BODY.
8. THE BARRIER SHALL BE INSTALLED IN A LINE WITH THE CENTERLINE OF THE RECEIVING WATER BODY.
9. THE BARRIER SHALL BE INSTALLED IN A LINE WITH THE CENTERLINE OF THE RECEIVING WATER BODY.
10. THE BARRIER SHALL BE INSTALLED IN A LINE WITH THE CENTERLINE OF THE RECEIVING WATER BODY.

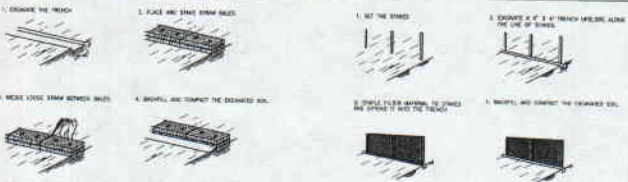
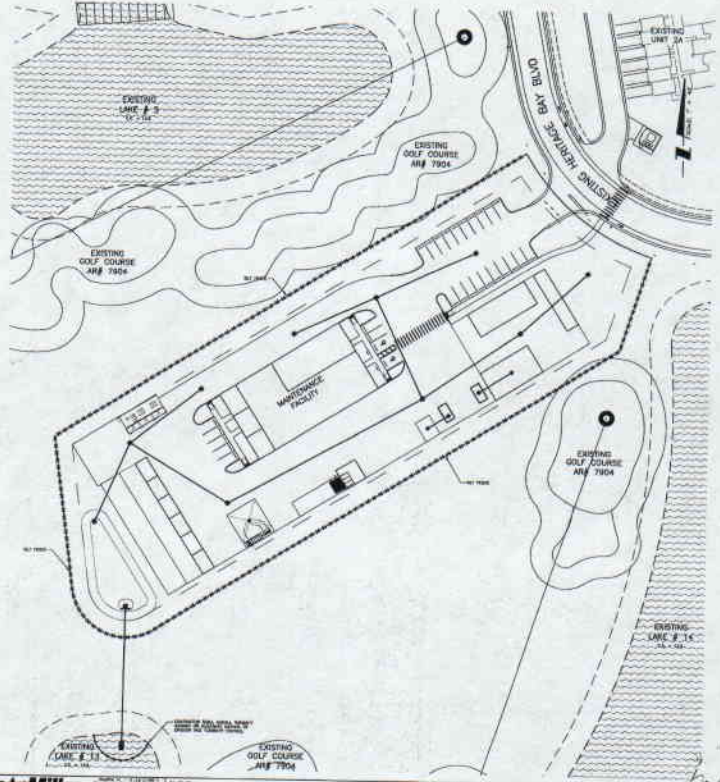

CONSTRUCTION OF A STRAW BALE BARRIER

CONSTRUCTION OF A FILTER BARRIER

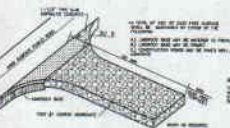

GENERAL NOTES:

1. THE BARRIER SHALL BE INSTALLED IN A LINE WITH THE CENTERLINE OF THE RECEIVING WATER BODY.
2. THE BARRIER SHALL BE INSTALLED IN A LINE WITH THE CENTERLINE OF THE RECEIVING WATER BODY.
3. THE BARRIER SHALL BE INSTALLED IN A LINE WITH THE CENTERLINE OF THE RECEIVING WATER BODY.
4. THE BARRIER SHALL BE INSTALLED IN A LINE WITH THE CENTERLINE OF THE RECEIVING WATER BODY.
5. THE BARRIER SHALL BE INSTALLED IN A LINE WITH THE CENTERLINE OF THE RECEIVING WATER BODY.
6. THE BARRIER SHALL BE INSTALLED IN A LINE WITH THE CENTERLINE OF THE RECEIVING WATER BODY.
7. THE BARRIER SHALL BE INSTALLED IN A LINE WITH THE CENTERLINE OF THE RECEIVING WATER BODY.
8. THE BARRIER SHALL BE INSTALLED IN A LINE WITH THE CENTERLINE OF THE RECEIVING WATER BODY.
9. THE BARRIER SHALL BE INSTALLED IN A LINE WITH THE CENTERLINE OF THE RECEIVING WATER BODY.
10. THE BARRIER SHALL BE INSTALLED IN A LINE WITH THE CENTERLINE OF THE RECEIVING WATER BODY.

WilsonMiller Surveying, Engineering, Architecture, Planning, Environmental 10000 North 10th Street, Suite 100, Scottsdale, AZ 85258 Phone: 480-344-1100, Fax: 480-344-1101, www.wilsonmiller.com		PROJECT: BAYVEST, LLC, HERITAGE BAY MAINTENANCE FACILITY	TITLE: EROSION CONTROL AND SILT FENCE PLAN	DATE: 01/20/2010 DRAWN BY: JLM CHECKED BY: JLM IN CHARGE: JLM
--	--	--	--	--