

PLAN LEGEND:

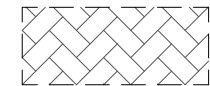

EXISTING PAVERS TO BE REMOVED



INDICATES EXISTING TREES AND PALMS TO REMAIN



INDICATES EXISTING TREES AND PALMS TO REMOVE

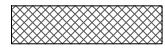

INDICATES EXISTING CONCRETE WALK TO REMOVE



INDICATES EXISTING VEGETATION TO REMOVE



INDICATES EXISTING VEGETATION TO REMAIN

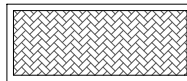

ARCHITECTURAL PAVER SIDEWALK WITH LIMEROCK BASE

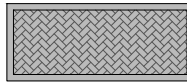

ARCHITECTURAL PAVER SIDEWALK WITH 6" CONCRETE BASE

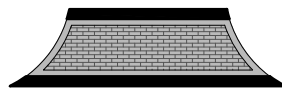

ARCHITECTURAL PAVER CROSSWALK WITH 6" CONCRETE BASE AND 12" X 12" CONCRETE BORDER GRADE/RETAINING BEAMS



INDICATES PROPOSED SITE SIGNAGE, PILLARS TYPE & WALL SUPPORT STRUCTURE

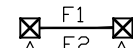

INDICATES PROPOSED PILLARS TYPE AND (F1-48" HT.) OR (F2-72" HT.) SINGLE DECORATIVE FENCE PANELS



INDICATES PROPOSED PILLARS AND 48" HT. DOUBLE PANEL LINE POST DECORATIVE FENCE PANELS



INDICATES PROPOSED (2) 8' L DECORATIVE SWING GATES WITH METAL SUPPORT POST TO LIFT STATION FACILITY

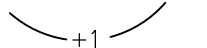

PROPOSED ONE FOOT CONTOURS. BLEND BACK FILL SOIL INTO EXISTING MOUND CONTOURS.



INDICATES PROPOSED DIRECTIONAL SPOT LIGHTS, LINEAR SIGN LIGHTS WITH CONDUITS AND CONDUCTORS

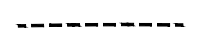

PROPOSED 18" DEPTH RIGID PLASTIC ROOT BARRIER ALONG EDGE OF PAVERS



PROPOSED UNDER PAVER EDGE CONCRETE FOOTING (8" W X 18" D)



PROPOSED ELECTRIC AND/OR IRRIGATION SLEEVING

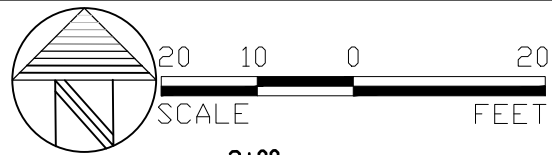

(SEE SHEET LD-16 20 SCALE)

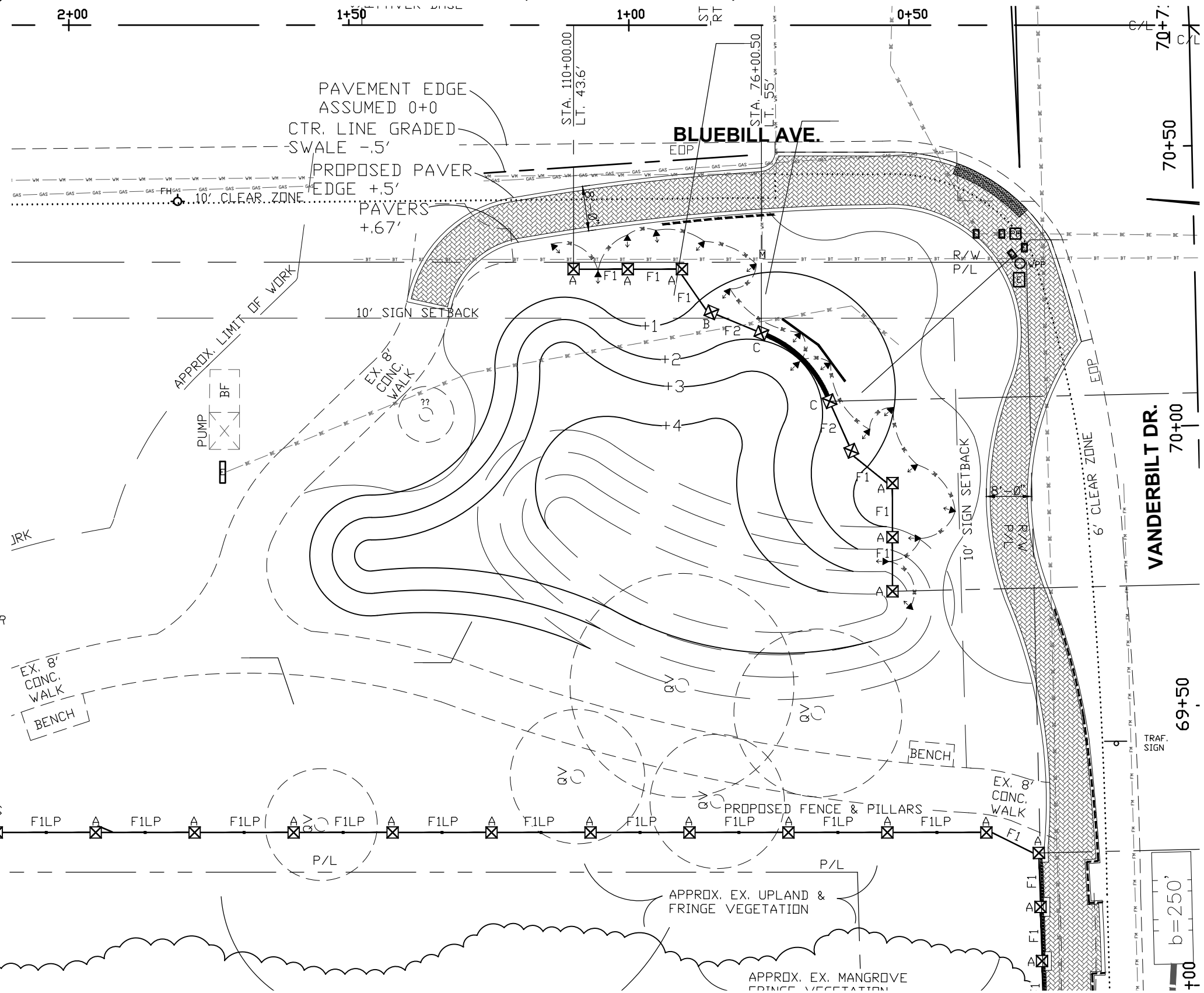

NOTICE: THE OFFICIAL RECORD OF THIS SHEET IS THE ELECTRONIC FILE SIGNED AND SEALED UNDER RULE 61G10-11.011, F.A.C.

DATE	BY	DESCRIPTION	DATE	BY	DESCRIPTION

McGee & Associates
 Landscape Architecture
 DESIGN * ENVIRONMENTAL MANAGEMENT * PLANNING
 5079 Tamiami Trail East * Naples, Florida 34113
 Phone: (239) 417-0707 Fax: (239) 417-0708
 Certificate of Authorization LC-C000098

COLLIER COUNTY BOARD OF COUNTY COMMISSIONERS		
ROAD NO.	COUNTY	FINANCIAL/PROJECT ID
N/A	COLLIER	000-000000

VANDERBILT DRIVE LANDSCAPE IMPROVEMENT PLANS
 SITE PLAN

SHEET NO.
LD-15