

FRONT ELEVATION-SINGLE PIPE

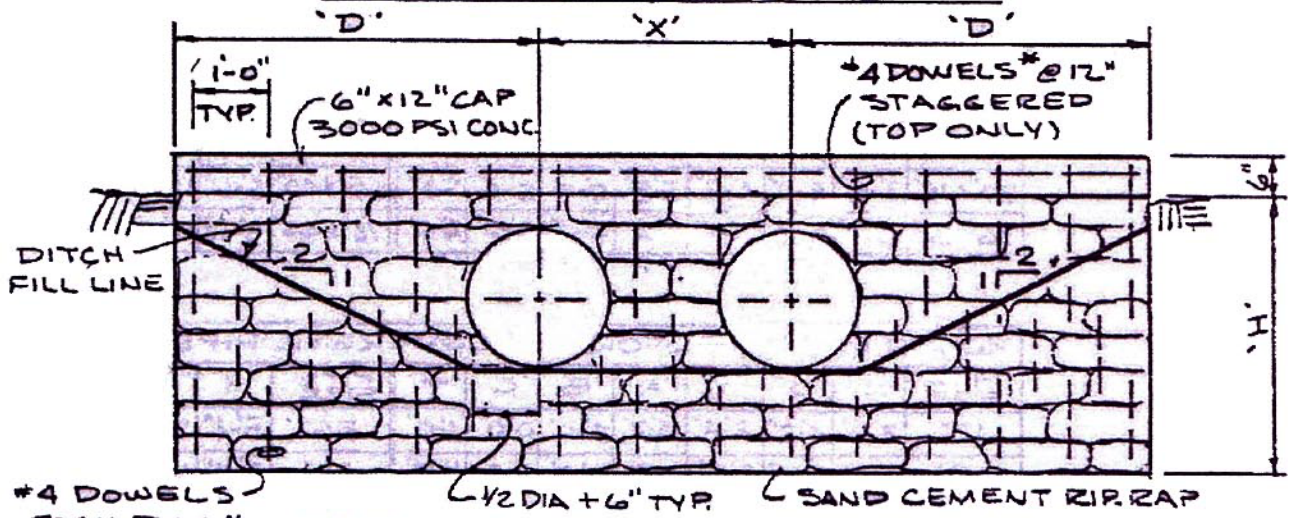

FRONT ELEVATION-MULTIPLE PIPE

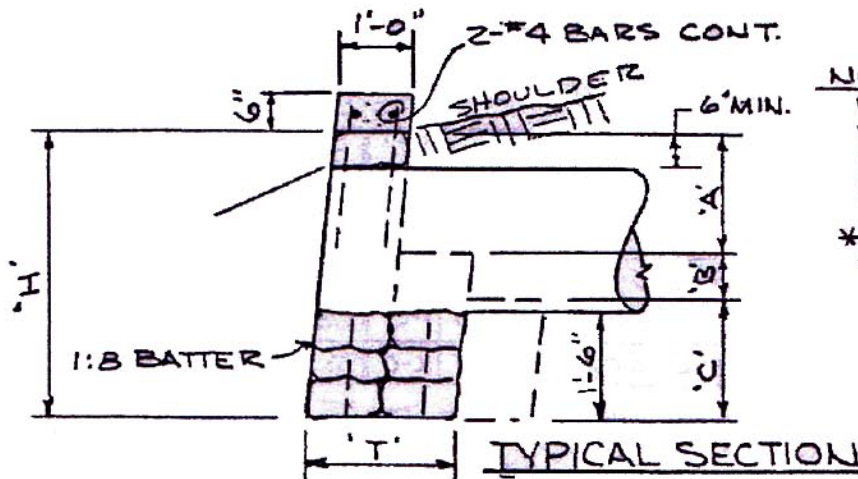

NOTES:

- FILL BAGS WITH DRY CEMENT SAND MIX (RATIO: 4 PARTS SAND / 1 PART CEMENT)
- * MAKE DOWELS FROM #4 REBAR x 24" LONG

plotdate 04/10/03

COLLIER COUNTY
TRANSPORTATION
OPERATIONS DEPARTMENT

REVISION
APPROVED

TITLE:

ENDWALL DETAIL
SAND CEMENT RIP-RAP

SHEET

17 of 31