

A: ROYAL PALMS W/ BROMELIADS IN SHELL

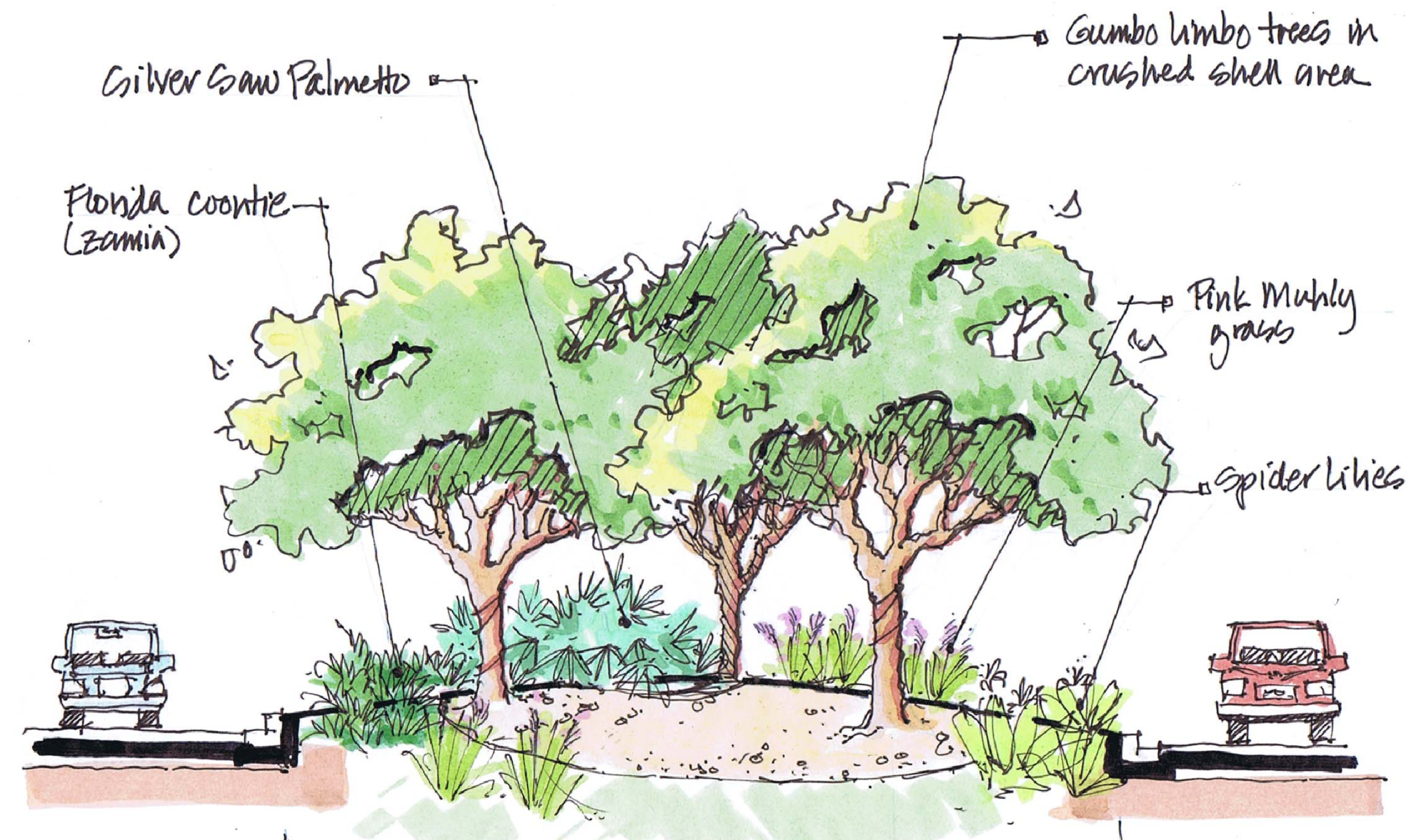

B: GUMBO LIMBO GROUPING @ SHELL AREA

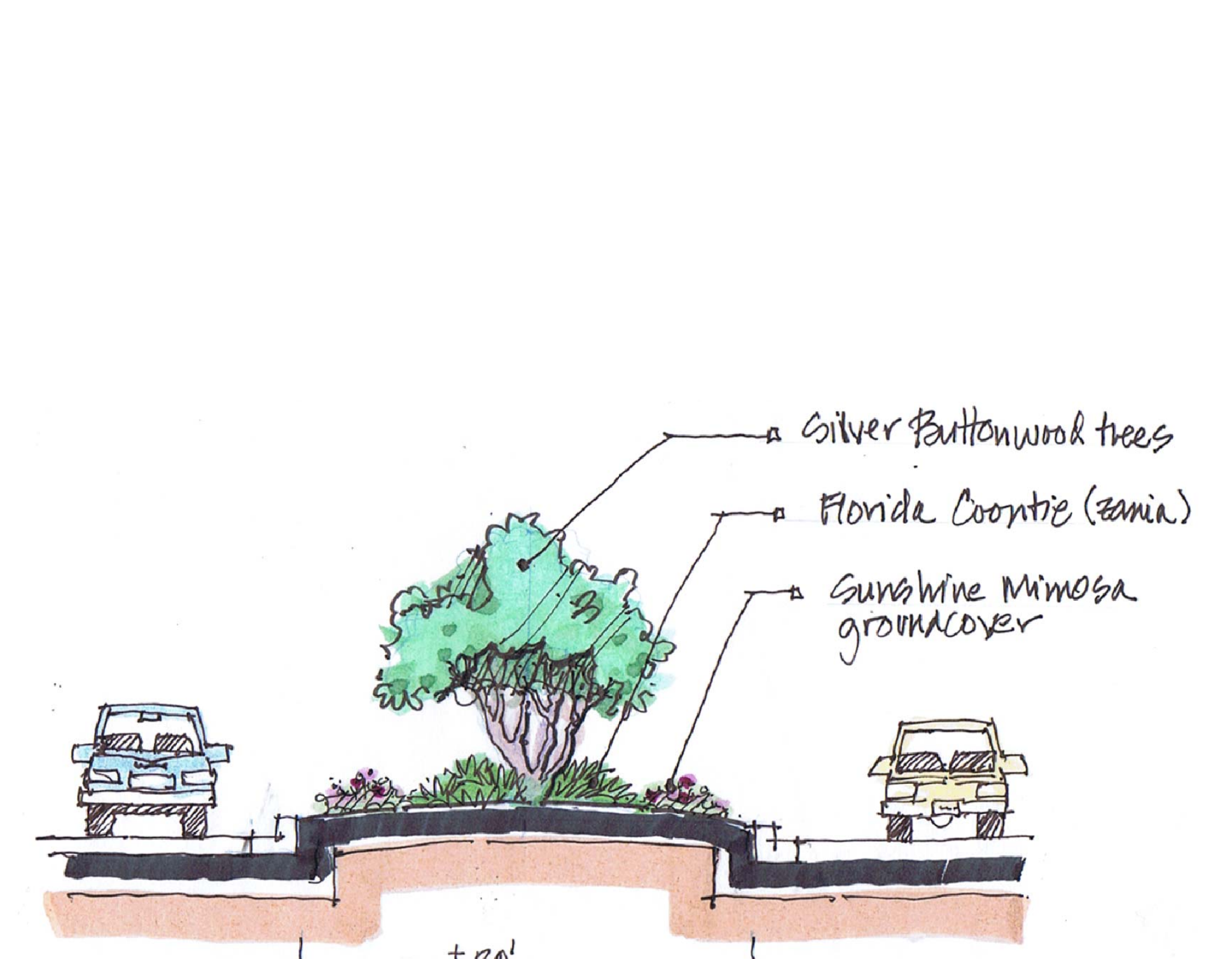

C: SILVER BUTTONWOODS W/ GROUNDCOVERS

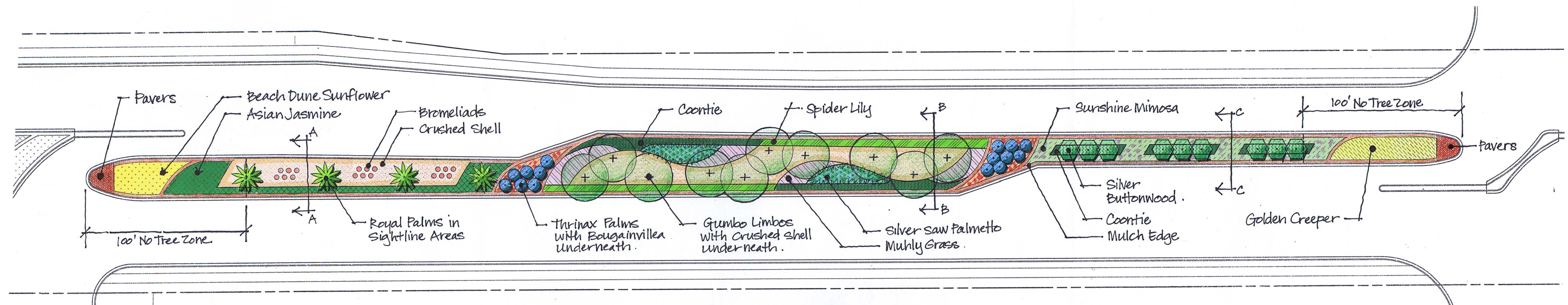

TYPICAL MEDIAN - PLAN VIEW
SCALE: 1" = 30'

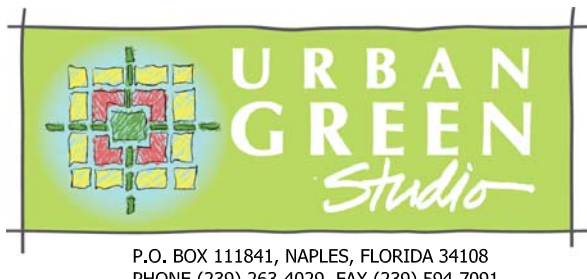

IN COORDINATION WITH:
JAMES C. ABNEY & ASSOCIATES
2984 44TH STREET SW
NAPLES, FL 34110
PHONE (239) 304-8451

PREPARED FOR:
COLLIER COUNTY BOARD OF COUNTY COMMISSIONERS
AND THE RADIO ROAD EAST MSTU ADVISORY COMMITTEE
3301 E. TAMiami TRAIL
NAPLES, FL 34112
PHONE (239) 252-8097

RADIO ROAD EAST
NAPLES, FLORIDA

REV	DATE	DESCRIPTION

SCALE: AS NOTED
DATE: NOVEMBER 2, 2011
PROJECT #:

LANDSCAPE RENDERINGS

60% PLANS

DAYNA L. FENDRICK, RLA #0001224

SHEET #
LP101