

ACTIVITY CENTER #8

AIRPORT-PULLING ROAD (C.R. 31) - GOLDEN GATE PARKWAY (C.R. 886)
Collier County, Florida

THIS IS A MASTER PLANNED ACTIVITY CENTER.
ACCORDINGLY, THE CONFIGURATION AND ACREAGE
NOTE: ALLOCATION VARIES FROM OTHER ACTIVITY CENTERS.

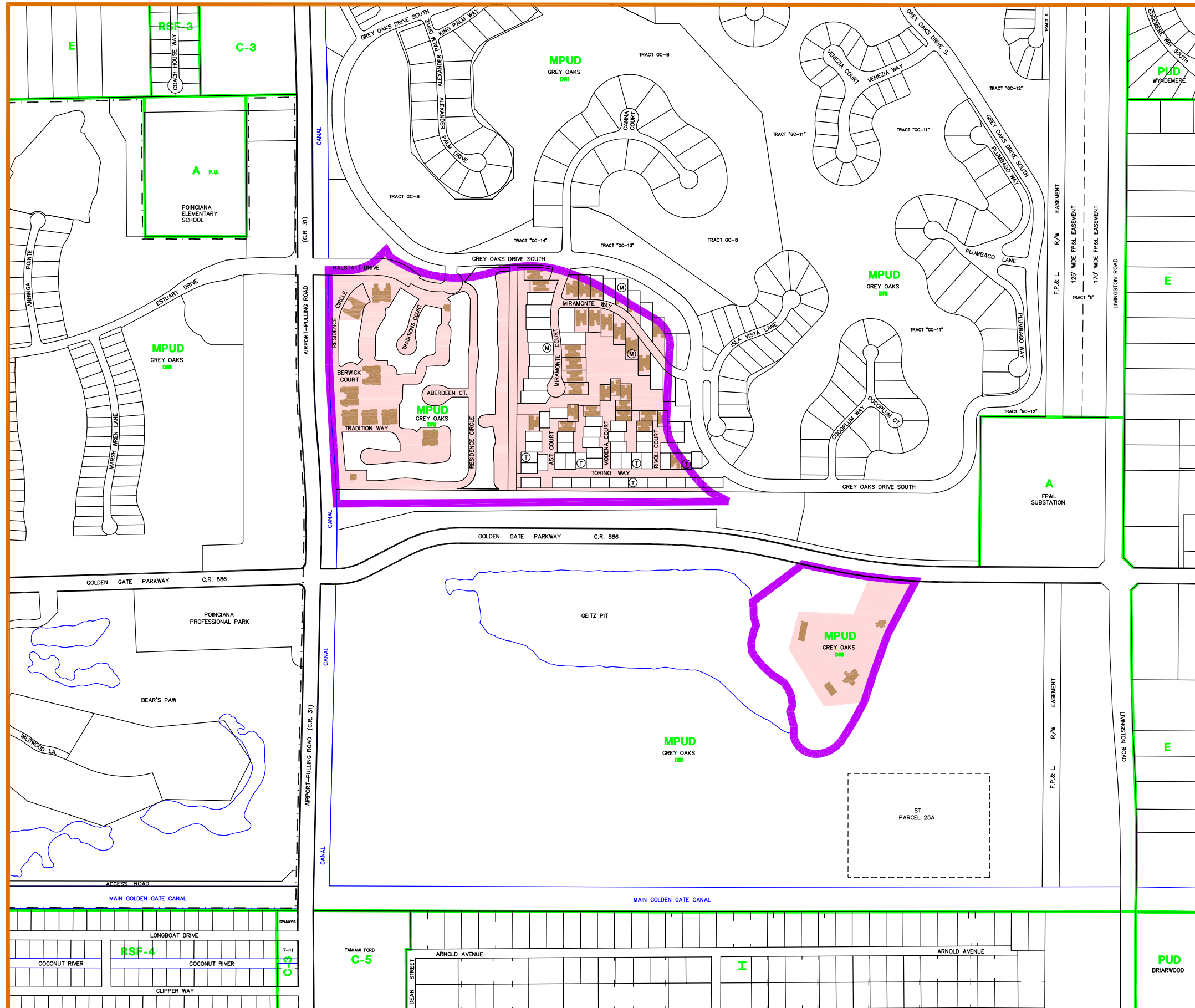

LEGEND	
	ACTIVITY CENTER BOUNDARY
	RSF-3 EXISTING ZONING
	DEVELOPED LAND USE
	EXISTING BUILDINGS AND STRUCTURES

NOTE: DEVELOPED LAND USE, EXISTING BUILDINGS AND STRUCTURES SAMPLED FROM 2010 AERIAL PHOTO

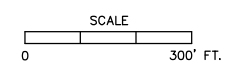

PREPARED BY: GIS/CAD MAPPING SECTION
GROWTH MANAGEMENT DIVISION / PLANNING AND REGULATION
FILE: AC8-2010.DWG DATE: 12/2010