

DRAFT

GOLDEN GATE AREA FUTURE LAND USE MAP

LEGEND

URBAN DESIGNATION	ESTATES DESIGNATION	AGRICULTURAL/RURAL DESIGNATION
MIXED USE DISTRICT	MIXED USE DISTRICT	RURAL SETTLEMENT AREA DISTRICT
URBAN RESIDENTIAL SUBDISTRICT	RESIDENTIAL ESTATES SUBDISTRICT	
HIGH DENSITY RESIDENTIAL SUBDISTRICT	CONDITIONAL USES SUBDISTRICT	
DOWNTOWN CENTER COMMERCIAL SUBDISTRICT	NEIGHBORHOOD CENTER SUBDISTRICT	
COMMERCIAL DISTRICT	COMMERCIAL DISTRICT	OVERLAYS AND SPECIAL FEATURES
MIXED USE ACTIVITY CENTER SUBDISTRICT	GOLDEN GATE PARKWAY INSTITUTIONAL SUBDISTRICT	SOUTHERN GOLDEN GATE ESTATES NATURAL RESOURCE PROTECTION AREA OVERLAY
GOLDEN GATE URBAN COMMERCIAL INFILL SUBDISTRICT	MISSION SUBDISTRICT	RESIDENTIAL DENSITY BAND
SANTA BARBARA COMMERCIAL SUBDISTRICT	COMMERCIAL DISTRICT	
GOLDEN GATE PARKWAY PROFESSIONAL OFFICE COMMERCIAL SUBDISTRICT	INTERCHANGE ACTIVITY CENTER SUBDISTRICT (AS DESCRIBED IN THE FUTURE LAND USE ELEMENT IN THE OMP.)	
COLLIER BOULEVARD COMMERCIAL SUBDISTRICT	PINE RIDGE ROAD MIXED USE SUBDISTRICT	
	RANDALL BOULEVARD COMMERCIAL SUBDISTRICT	
	COMMERCIAL WESTERN ESTATES INFILL SUBDISTRICT	
	GOLDEN GATE ESTATES COMMERCIAL INFILL SUBDISTRICT	

NOTE: THIS MAP CANNOT BE INTERPRETED WITHOUT THE GOALS, OBJECTIVES, POLICIES AND LAND USE DESIGNATION DESCRIPTION SECTION OF THE GOLDEN GATE AREA MASTER PLAN.

T 47 S

T 48 S

T 49 S

T 50 S

T 51 S

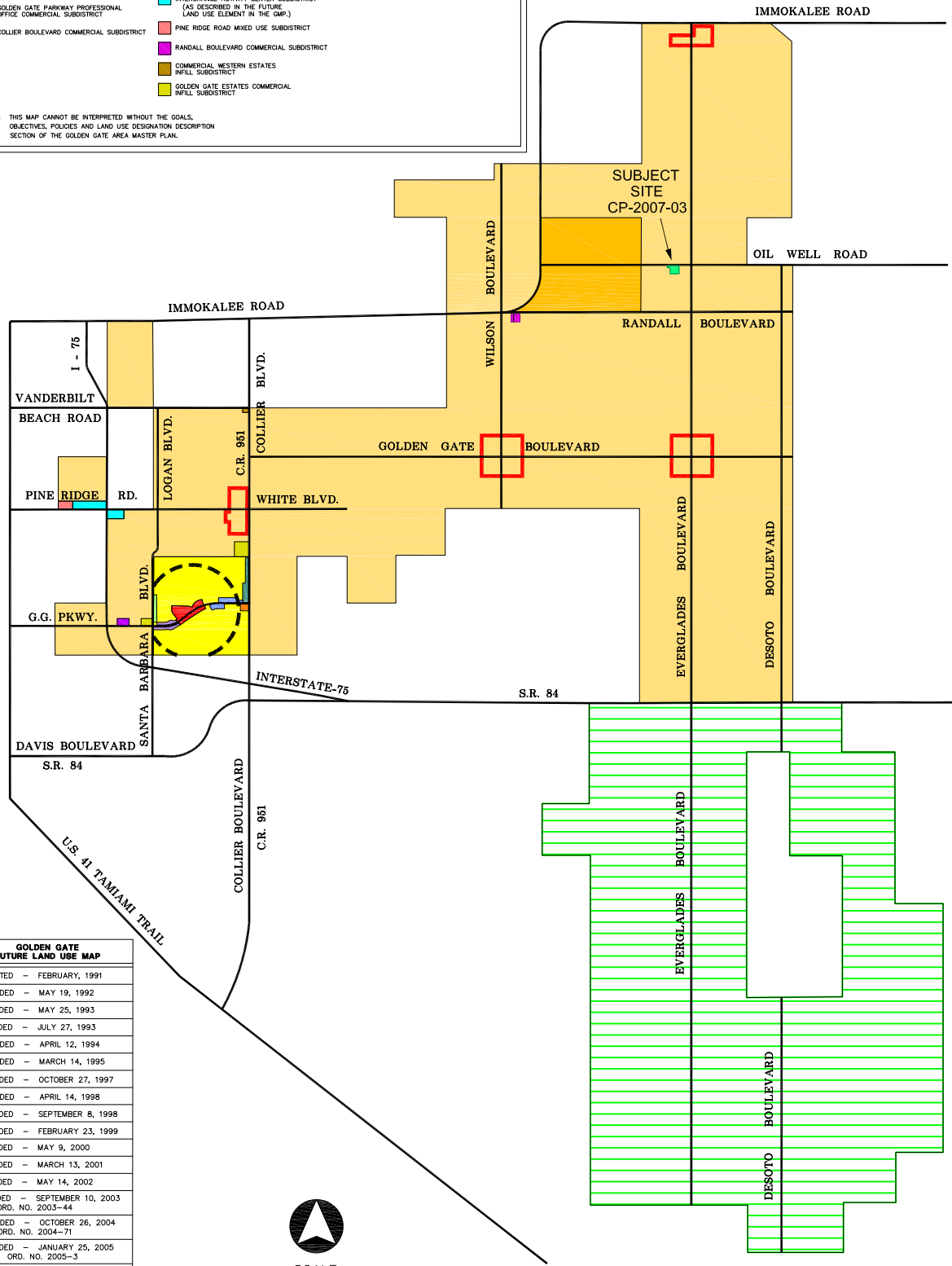

GOLDEN GATE FUTURE LAND USE MAP	
ADOPTED	- FEBRUARY, 1991
AMENDED	- MAY 19, 1992
AMENDED	- MAY 25, 1993
AMENDED	- JULY 27, 1993
AMENDED	- APRIL 12, 1994
AMENDED	- MARCH 14, 1995
AMENDED	- OCTOBER 27, 1997
AMENDED	- APRIL 14, 1998
AMENDED	- SEPTEMBER 8, 1998
AMENDED	- FEBRUARY 23, 1999
AMENDED	- MAY 9, 2000
AMENDED	- MARCH 13, 2001
AMENDED	- MAY 14, 2002
AMENDED	- SEPTEMBER 10, 2003 ORD. NO. 2003-44
AMENDED	- OCTOBER 26, 2004 ORD. NO. 2004-71
AMENDED	- JANUARY 25, 2005 ORD. NO. 2005-3
AMENDED	- JANUARY 25, 2007 ORD. NO. 2007-19
AMENDED	- DECEMBER 4, 2007 ORD. NO. 2007-77
AMENDED	- OCTOBER 14, 2008 ORD. NO. 2008-59



SCALE

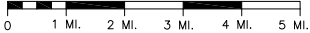

PREPARED BY: GIS/CAD MAPPING SECTION
 COMMUNITY DEVELOPMENT AND ENVIRONMENTAL SERVICES DIVISION
 DATE: 9/2009 FILE: CP-2007-3.DWG

R 26 E

R 27 E

R 28 E