

DRAFT

NORTH BELLE MEADE OVERLAY MAP

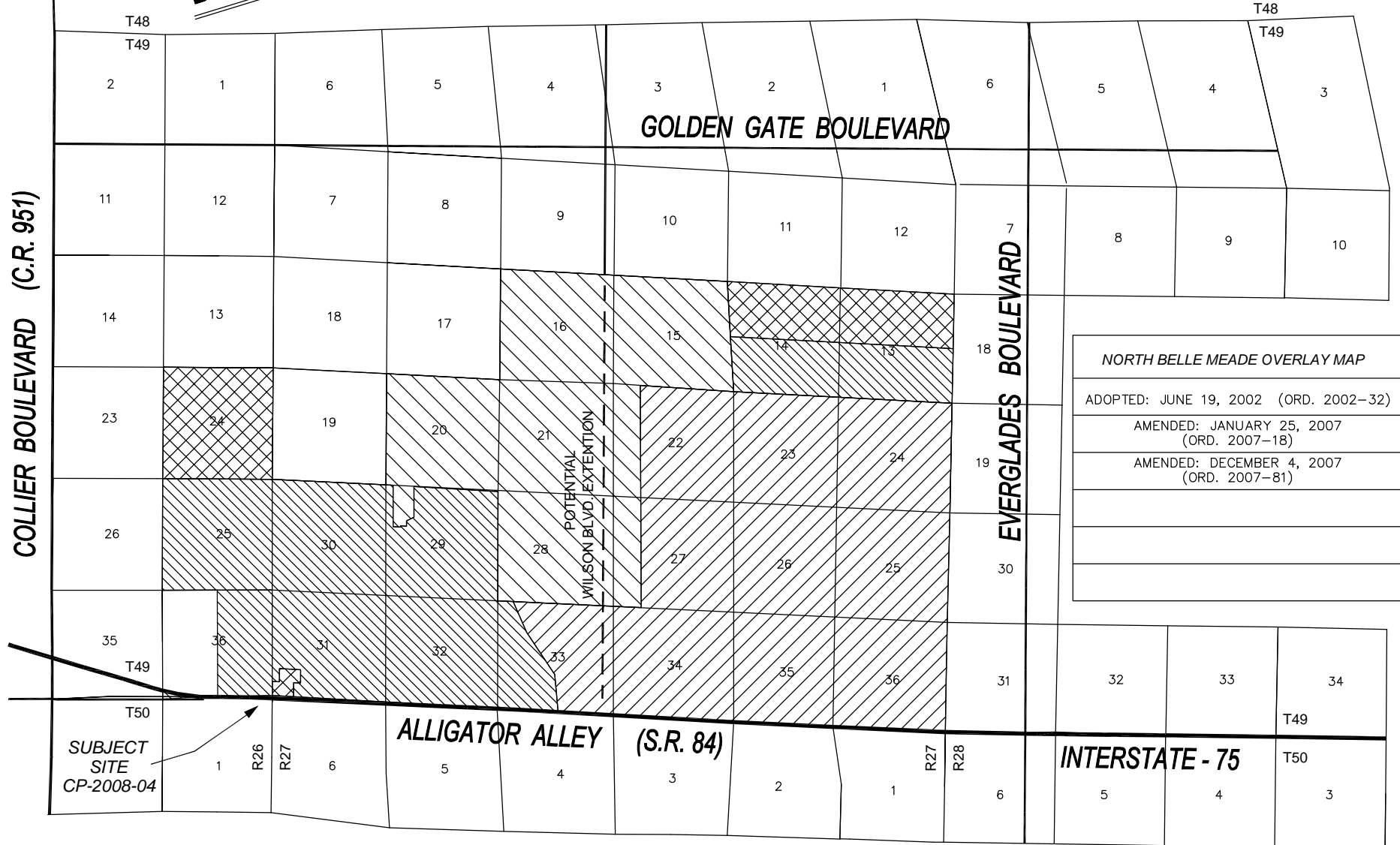

NORTH BELLE MEADE OVERLAY MAP	
ADOPTED: JUNE 19, 2002 (ORD. 2002-32)	
AMENDED: JANUARY 25, 2007 (ORD. 2007-18)	
AMENDED: DECEMBER 4, 2007 (ORD. 2007-81)	

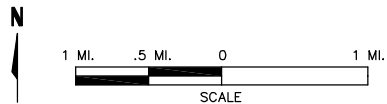

LEGEND			
	SENDING		NEUTRAL
	NRPA SENDING		RECEIVING

PREPARED BY: GRAPHICS AND TECHNICAL SUPPORT SECTION
 COMMUNITY DEVELOPMENT AND ENVIRONMENTAL SERVICES DIVISION
 DATE: 8/2009 FILE: CP-2008-4A.DWG

NOTE: THIS MAP CANNOT BE INTERPRETED WITHOUT THE GOALS, OBJECTIVES AND POLICIES OF THE COLLIER COUNTY GROWTH MANAGEMENT PLAN.