

DRAFT

GOLDEN GATE AREA FUTURE LAND USE MAP

LEGEND

URBAN DESIGNATION	ESTATES DESIGNATION	AGRICULTURAL/RURAL DESIGNATION
MIXED USE DISTRICT	MIXED USE DISTRICT	RURAL SETTLEMENT AREA DISTRICT
HIGH DENSITY RESIDENTIAL SUBDISTRICT	RESIDENTIAL ESTATES SUBDISTRICT	OVERLAYS AND SPECIAL FEATURES
DOWNTOWN CENTER COMMERCIAL SUBDISTRICT	CONDITIONAL USES SUBDISTRICT	SOUTHERN GOLDEN GATE ESTATES NATURAL RESOURCE PROTECTION AREA OVERLAY
COMMERCIAL DISTRICT	NEIGHBORHOOD CENTER SUBDISTRICT	RESIDENTIAL DENSITY BAND
MIXED USE ACTIVITY CENTER SUBDISTRICT	GOLDEN GATE PARKWAY INSTITUTIONAL SUBDISTRICT	
GOLDEN GATE URBAN COMMERCIAL INFILL SUBDISTRICT	COMMERCIAL DISTRICT	
SANTA BARBARA COMMERCIAL SUBDISTRICT	INTERCHANGE ACTIVITY CENTER SUBDISTRICT (AS DESCRIBED IN THE FUTURE LAND USE ELEMENT IN THE OMP.)	
GOLDEN GATE PARKWAY PROFESSIONAL OFFICE COMMERCIAL SUBDISTRICT	PINE RIDGE ROAD MIXED USE SUBDISTRICT	
COLLIER BOULEVARD COMMERCIAL SUBDISTRICT	RANDALL BOULEVARD COMMERCIAL SUBDISTRICT	
	COMMERCIAL WESTERN ESTATES INFILL SUBDISTRICT	
	GOLDEN GATE ESTATES COMMERCIAL INFILL SUBDISTRICT	
	ESTATES SHOPPING CENTER SUBDISTRICT	

NOTE: THIS MAP CANNOT BE INTERPRETED WITHOUT THE GOALS, OBJECTIVES, POLICIES AND LAND USE DESIGNATION DESCRIPTION SECTION OF THE GOLDEN GATE AREA MASTER PLAN.

T 47 S
T 48 S
T 49 S
T 50 S
T 51 S

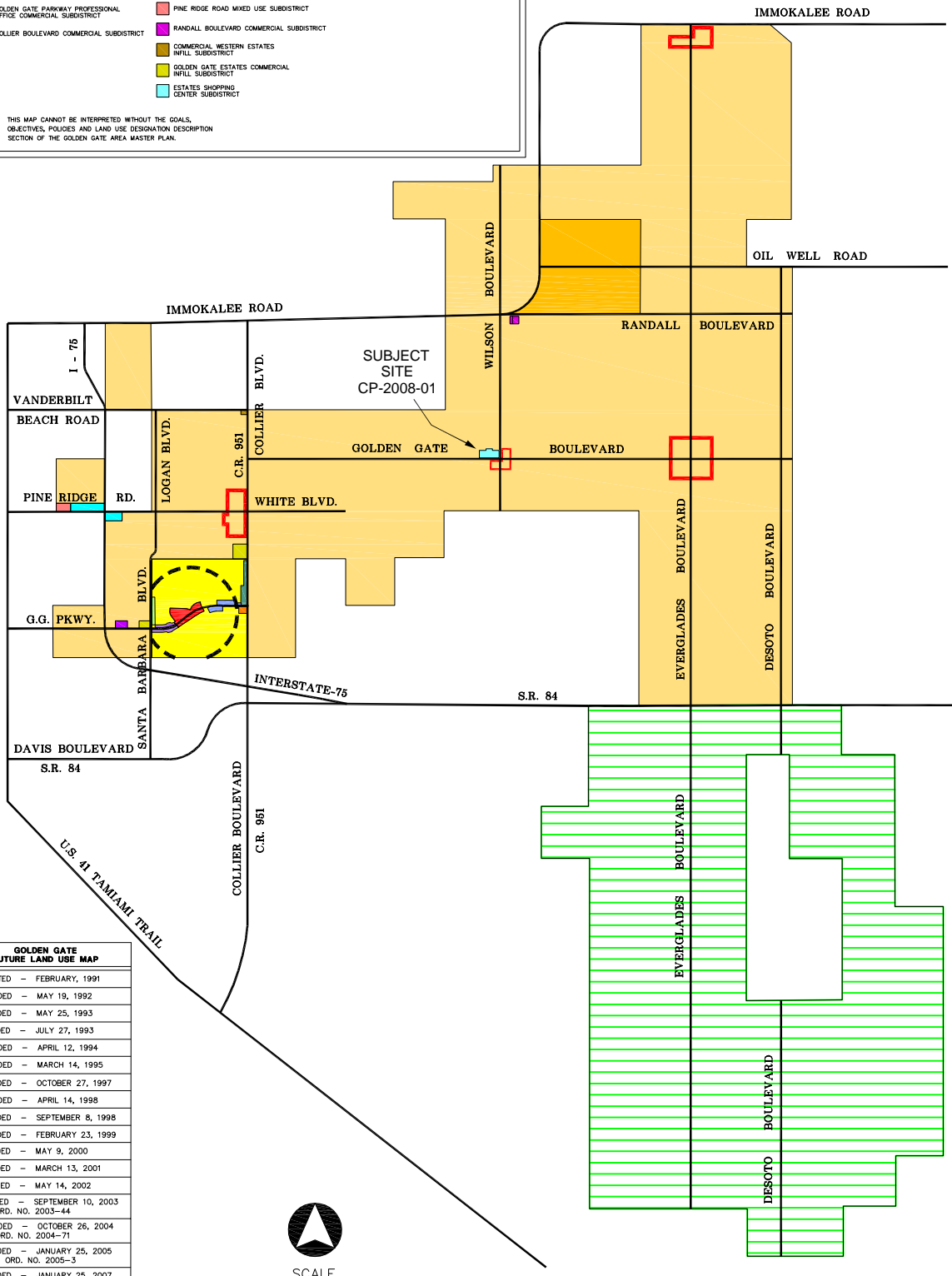

GOLDEN GATE FUTURE LAND USE MAP	
ADOPTED	- FEBRUARY, 1991
AMENDED	- MAY 19, 1992
AMENDED	- MAY 25, 1993
AMENDED	- JULY 27, 1993
AMENDED	- APRIL 12, 1994
AMENDED	- MARCH 14, 1995
AMENDED	- OCTOBER 27, 1997
AMENDED	- APRIL 14, 1998
AMENDED	- SEPTEMBER 8, 1998
AMENDED	- FEBRUARY 23, 1999
AMENDED	- MAY 9, 2000
AMENDED	- MARCH 13, 2001
AMENDED	- MAY 14, 2002
AMENDED	- SEPTEMBER 10, 2003
ORD. NO. 2003-44	
AMENDED	- OCTOBER 26, 2004
ORD. NO. 2004-71	
AMENDED	- JANUARY 25, 2005
ORD. NO. 2005-3	
AMENDED	- JANUARY 25, 2007
ORD. NO. 2007-19	
AMENDED	- DECEMBER 4, 2007
ORD. NO. 2007-77	
AMENDED	- OCTOBER 14, 2008
ORD. NO. 2008-59	



SCALE

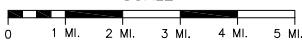

PREPARED BY: GIS/CAD MAPPING SECTION
COMMUNITY DEVELOPMENT AND ENVIRONMENTAL SERVICES DIVISION
DATE: 9/2009 FILE: CP-2008-1.DWG

R 26 E | R 27 E | R 28 E