

GOLDEN GATE AREA FUTURE LAND USE MAP

LEGEND

URBAN DESIGNATION

MIXED USE DISTRICT

- URBAN RESIDENTIAL SUBDISTRICT
- HIGH DENSITY RESIDENTIAL SUBDISTRICT
- DOWNTOWN CENTER COMMERCIAL SUBDISTRICT

COMMERCIAL DISTRICT

- MIXED USE ACTIVITY CENTER SUBDISTRICT
- GOLDEN GATE URBAN COMMERCIAL INFILL SUBDISTRICT
- SANTA BARBARA COMMERCIAL SUBDISTRICT
- GOLDEN GATE PARKWAY PROFESSIONAL OFFICE COMMERCIAL SUBDISTRICT
- COLLIER BOULEVARD COMMERCIAL SUBDISTRICT

ESTATES DESIGNATION

MIXED USE DISTRICT

- RESIDENTIAL ESTATES SUBDISTRICT
- CONDITIONAL USES SUBDISTRICT
- NEIGHBORHOOD CENTER SUBDISTRICT

COMMERCIAL DISTRICT

- GOLDEN GATE PARKWAY INSTITUTIONAL SUBDISTRICT
- INTERCHANGE ACTIVITY CENTER SUBDISTRICT (AS DESCRIBED IN THE FUTURE LAND USE ELEMENT IN THE GMP.)
- PINE RIDGE ROAD MIXED USE SUBDISTRICT
- RANDALL BOULEVARD COMMERCIAL SUBDISTRICT
- COMMERCIAL WESTERN ESTATES INFILL SUBDISTRICT
- GOLDEN GATE ESTATES COMMERCIAL INFILL SUBDISTRICT

AGRICULTURAL/RURAL DESIGNATION

- RURAL SETTLEMENT AREA DISTRICT

OVERLAYS AND SPECIAL FEATURES

- SOUTHERN GOLDEN GATE ESTATES NATURAL RESOURCE PROTECTION AREA OVERLAY
- RESIDENTIAL DENSITY BAND

NOTE: THIS MAP CANNOT BE INTERPRETED WITHOUT THE GOALS, OBJECTIVES, POLICIES AND LAND USE DESIGNATION DESCRIPTION SECTION OF THE GOLDEN GATE AREA MASTER PLAN.

T 47 S
T 48 S
T 49 S
T 50 S
T 51 S

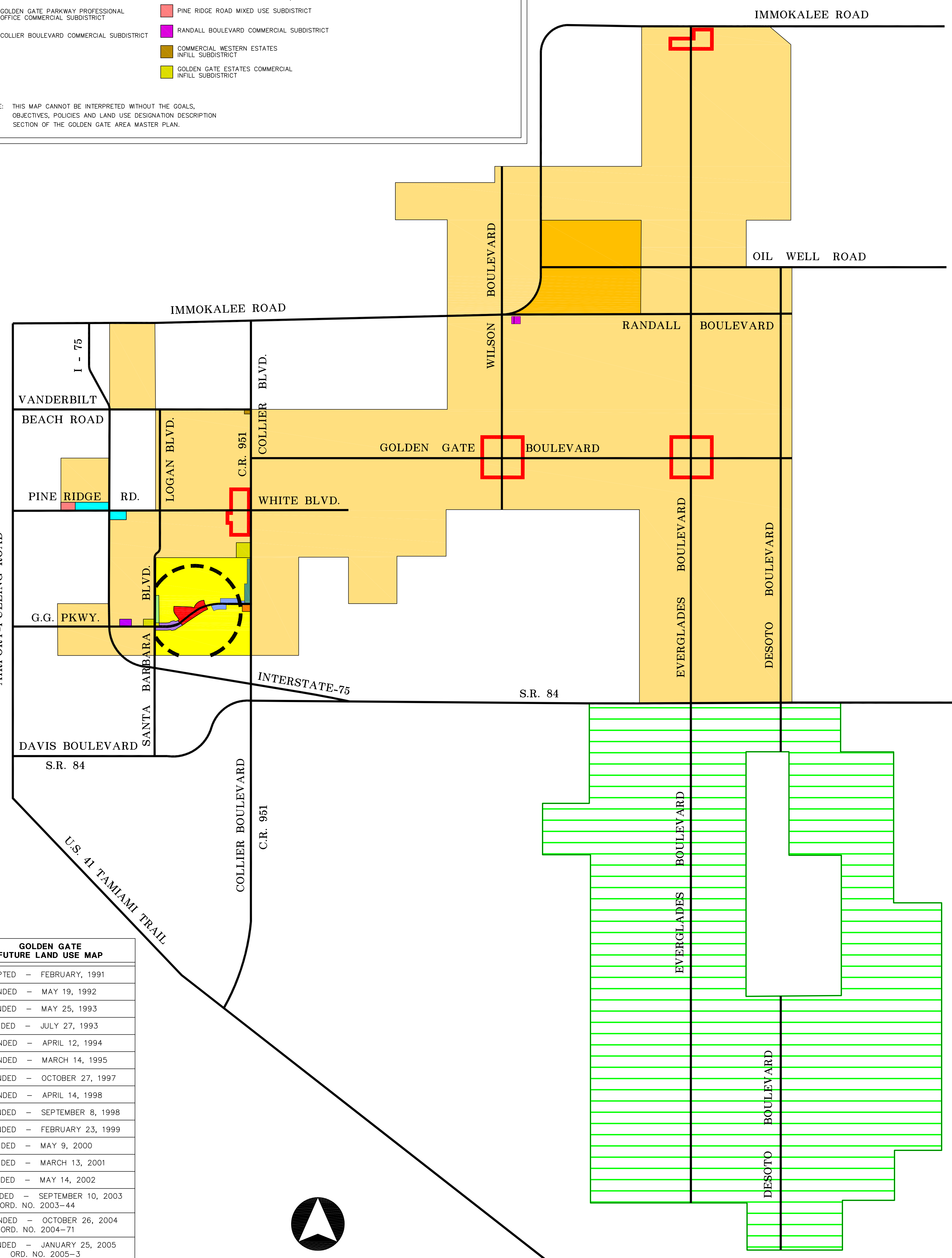

GOLDEN GATE FUTURE LAND USE MAP	
ADOPTED	- FEBRUARY, 1991
AMENDED	- MAY 19, 1992
AMENDED	- MAY 25, 1993
AMENDED	- JULY 27, 1993
AMENDED	- APRIL 12, 1994
AMENDED	- MARCH 14, 1995
AMENDED	- OCTOBER 27, 1997
AMENDED	- APRIL 14, 1998
AMENDED	- SEPTEMBER 8, 1998
AMENDED	- FEBRUARY 23, 1999
AMENDED	- MAY 9, 2000
AMENDED	- MARCH 13, 2001
AMENDED	- MAY 14, 2002
AMENDED	- SEPTEMBER 10, 2003 ORD. NO. 2003-44
AMENDED	- OCTOBER 26, 2004 ORD. NO. 2004-71
AMENDED	- JANUARY 25, 2005 ORD. NO. 2005-3
AMENDED	- JANUARY 25, 2007 ORD. NO. 2007-19
AMENDED	- DECEMBER 4, 2007 ORD. NO. 2007-77
AMENDED	- OCTOBER 14, 2008 ORD. NO. 2008-59

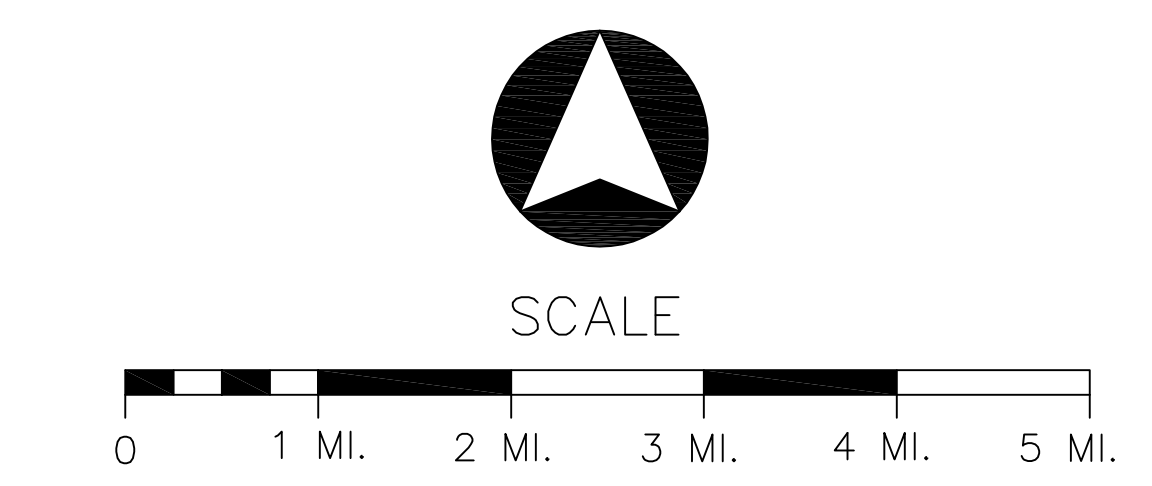

PREPARED BY: GIS/CAD MAPPING SECTION
COMMUNITY DEVELOPMENT AND ENVIRONMENTAL SERVICES DIVISION
DATE: 10/2008 FILE: GGFLU-2008-2-1.DWG

R 26 E | R 27 E | R 28 E