

TR-1
Collier County 2030 Constrained Financially Feasible Plan

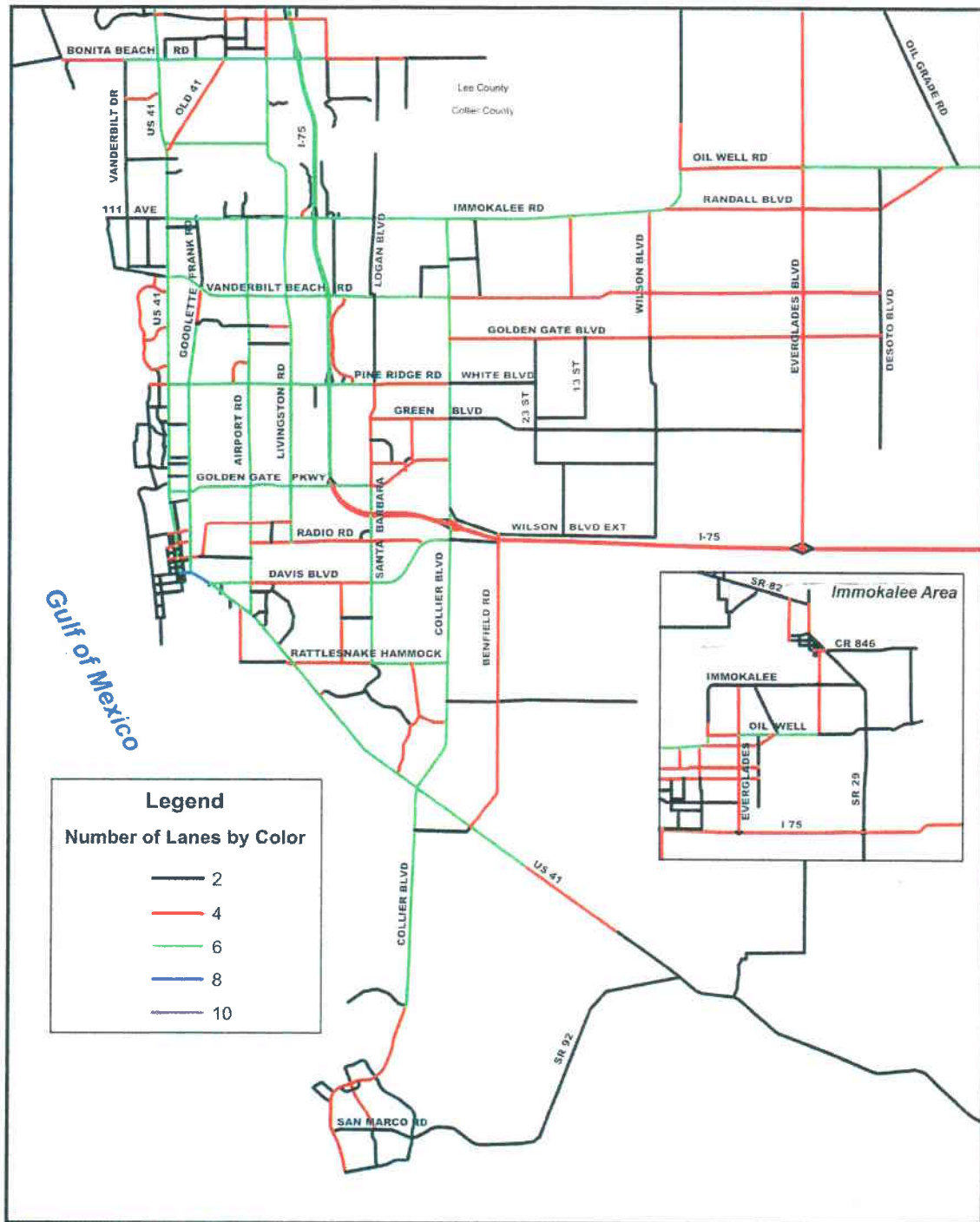

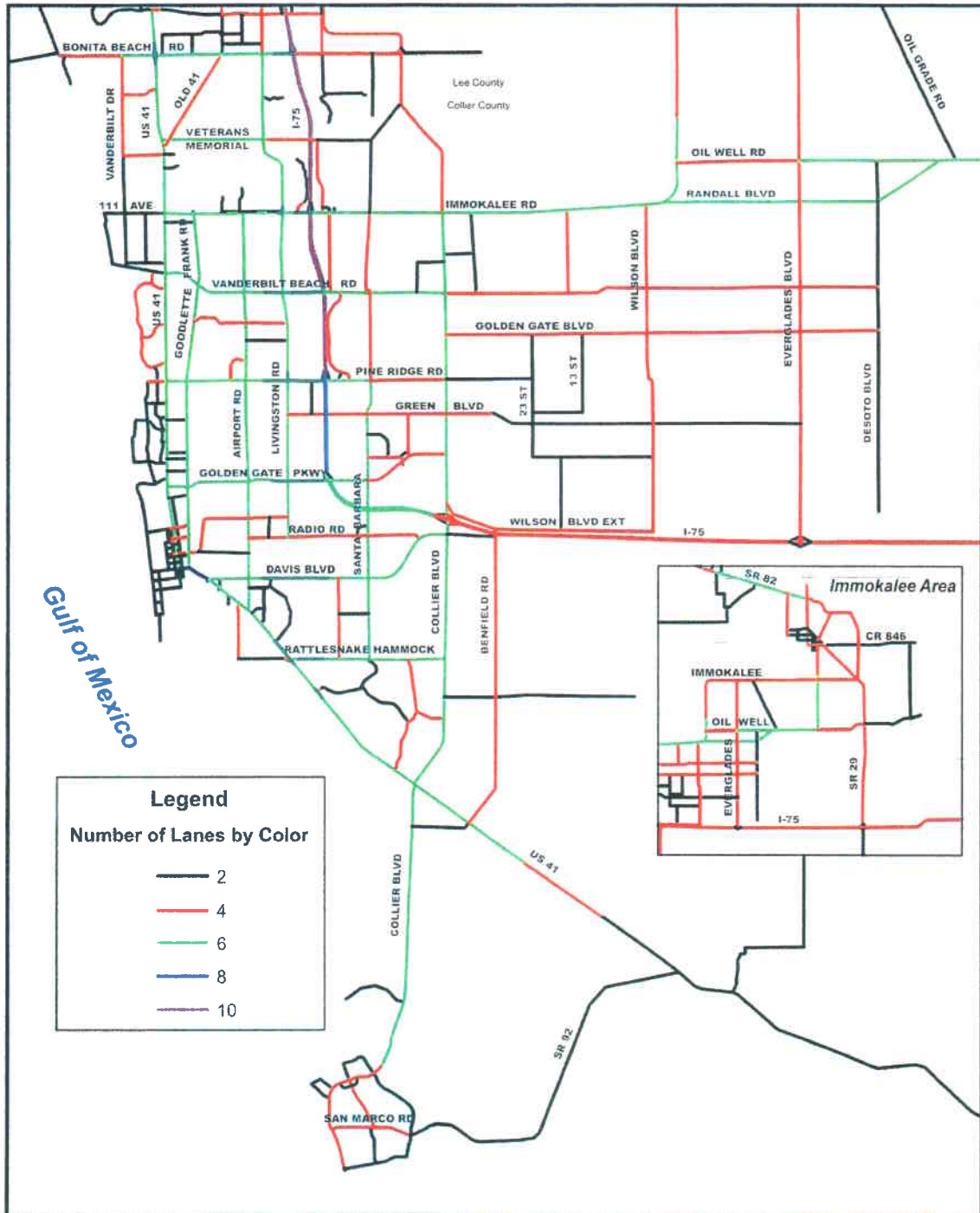

TR-2
Collier County 2030 Highway Needs Plan



R 25 E R 26 E R 27 E R 28 E R 29 E R 30 E R 31 E R 32 E R 33 E R 34 E

2007 - 2017 FUTURE LAND USE MAP Collier County Florida

DETAILS OF THE RLSA OVERLAY AREA ARE SHOWN ON THE FUTURE LAND USE MAP TITLED: "COLLIER COUNTY RURAL & AGRICULTURAL AREA ASSESSMENT STEWARDSHIP OVERLAY MAP"

DRAFT

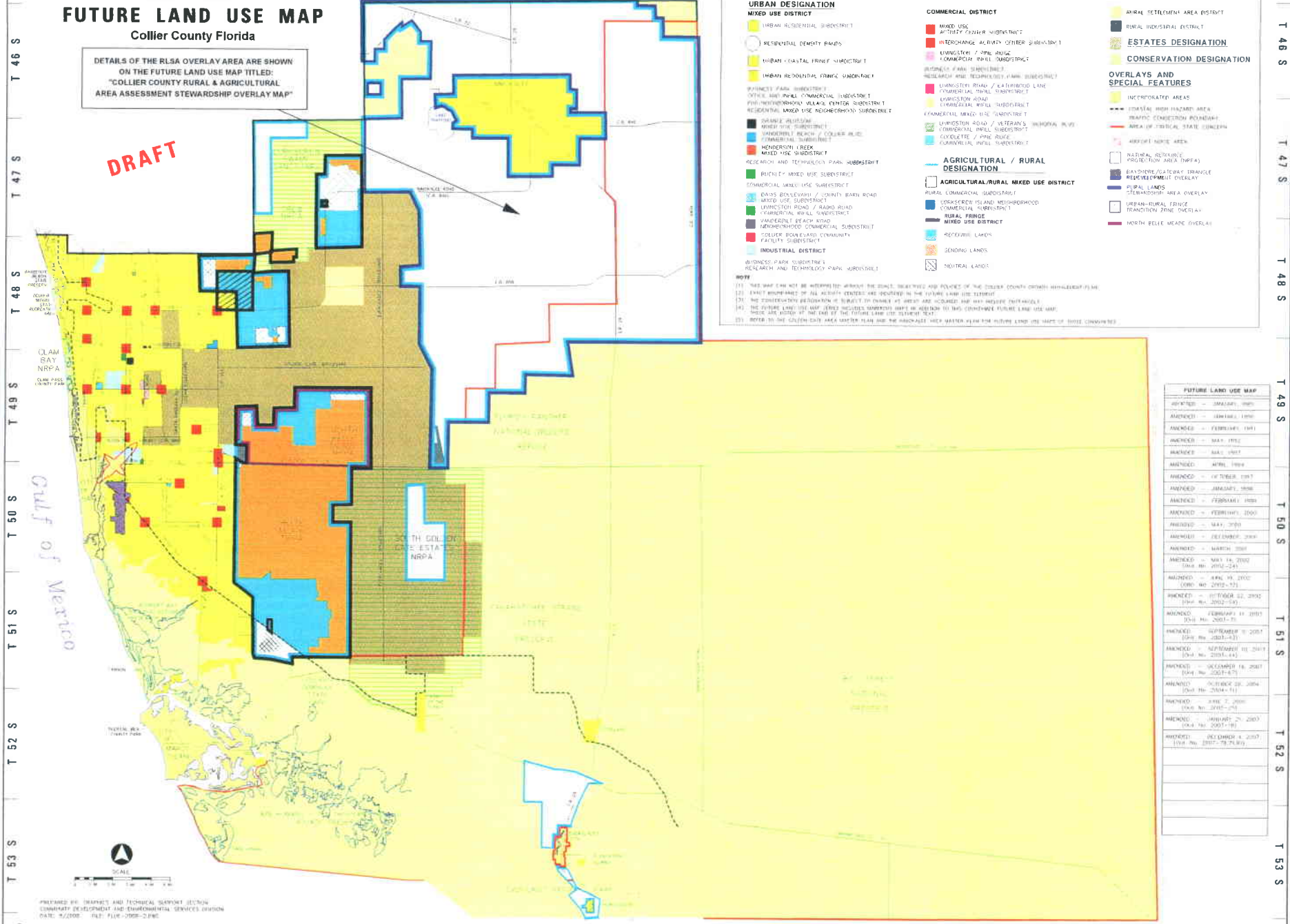

URBAN DESIGNATION

- MIXED USE DISTRICT
 - URBAN RESIDENTIAL SUBDISTRICT
 - RESIDENTIAL DENSITY BANDS
 - URBAN / COASTAL FRINGE SUBDISTRICT
 - URBAN RESIDENTIAL FRINGE SUBDISTRICT
 - WATERFRONT PARK SUBDISTRICT
 - OFFICE AND BUSINESS COMMERCIAL SUBDISTRICT
 - FINANCIAL/INFORMATIONAL/CLARIS CENTER SUBDISTRICT
 - RESIDENTIAL MIXED USE NEIGHBORHOOD SUBDISTRICT
 - UNIVERSITY DISTRICT
 - UNIVERSITY BEACH / COLLIER BEACH COMMERCIAL SUBDISTRICT
 - HENDERSON BEACH MIXED USE SUBDISTRICT
 - RESEARCH AND TECHNOLOGY PARK SUBDISTRICT
 - BIO-TECH MIXED USE SUBDISTRICT
 - EMPLOYMENT MIXED USE SUBDISTRICT
 - DAVIS BOULEVARD / COUNTY BARN ROAD MIXED USE SUBDISTRICT
 - UNIVERSITY ROAD / RADIO ROAD COMMERCIAL MIXED USE SUBDISTRICT
 - UNIVERSITY BEACH ROAD NEIGHBORHOOD COMMERCIAL SUBDISTRICT
 - COLLEGE ROAD/CLARIS COMMUNITY FACILITY SUBDISTRICT
- INDUSTRIAL DISTRICT
 - BUSINESS PARK SUBDISTRICT
 - RESEARCH AND TECHNOLOGY PARK SUBDISTRICT

COMMERCIAL DISTRICT

- MIXED USE
- INTERCHANGE ALLEYWAY OTHER SUBDISTRICT
- UNIVERSITY / PINE RIDGE COMMERCIAL MIXED USE SUBDISTRICT
- UNIVERSITY ROAD / CALHOUN LANE COMMERCIAL MIXED USE SUBDISTRICT
- UNIVERSITY ROAD COMMERCIAL MIXED USE SUBDISTRICT
- UNIVERSITY BEACH COMMERCIAL MIXED USE SUBDISTRICT
- UNIVERSITY BEACH / VETERAN'S MEMORIAL PLAZA COMMERCIAL MIXED USE SUBDISTRICT
- COVELETTE / PINE RIDGE COMMERCIAL MIXED USE SUBDISTRICT

AGRICULTURAL / RURAL DESIGNATION

- AGRICULTURAL/RURAL MIXED USE DISTRICT
 - RURAL COMMERCIAL SUBDISTRICT
 - UNDEVELOPED ISLAND NEIGHBORHOOD COMMERCIAL SUBDISTRICT
 - RURAL FRINGE MIXED USE DISTRICT
 - RECREATION LANDS
 - SEMI-RURAL LANDS
 - NEUTRAL LANDS

CONSERVATION DESIGNATION

- RURAL SETTLEMENT AREA DISTRICT
- RURAL INDUSTRIAL DISTRICT

ESTATES DESIGNATION

- CONSERVATION DESIGNATION

OVERLAYS AND SPECIAL FEATURES

- INCORPORATED AREAS
- UNDESIRABLE HIGH HAZARD AREA
- TRAFFIC CONGESTION BOUNDARY
- AREA OF FEDERAL STATE CONCERN
- AIRPORT NOISE AREA
- NATIONAL SEASHORE PROTECTION AREA (NSPPA)
- BEACHSIDE/STATEWAY BRIDGE
- RECREATION OVERLAY
- RURAL LANDS STEWARDSHIP AREA OVERLAY
- URBAN-RURAL FRINGE TRANSITION ZONE OVERLAY
- NORTH BELLE MEADE OVERLAY

NOTE

- THIS MAP IS NOT BE INTERPRETED WITHOUT THE SMALL SCALE MAP AND POLYCE OF THE COLLIER COUNTY OFFICIAL MAPS/LEGEND (P. 10)
- EXISTING BOUNDARIES OF ALL AERIAL CENTER ARE SHOWN IN THE FUTURE LAND USE DESIGNATION
- THE FUTURE LAND USE MAP SHOWS DESIGNATIONS BASED ON CURRENT AND PLANNED DEVELOPMENT PATTERNS. THESE ARE SUBJECT TO THE FUTURE LAND USE DESIGNATION
- REFER TO THE COLLIER COUNTY AREA MASTER PLAN AND THE AMENDED HIGH WATER PLAN FOR FUTURE LAND USE MAPS OF THESE CONTOURS

FUTURE LAND USE MAP	
APPROVED	JANUARY 1985
AMENDED	JANUARY 1986
AMENDED	FEBRUARY 1987
AMENDED	MAY 1988
AMENDED	MAY 1989
AMENDED	APRIL 1989
AMENDED	OCTOBER 1987
AMENDED	JANUARY 1988
AMENDED	FEBRUARY 1988
AMENDED	FEBRUARY 1988
AMENDED	MAY 1988
AMENDED	DECEMBER 1988
AMENDED	MARCH 1989
AMENDED	MARCH 1989
AMENDED	MAY 14, 2002 (CMA No. 2002-24)
AMENDED	APRIL 10, 2002 (CMA No. 2002-22)
AMENDED	NOVEMBER 22, 2002 (CMA No. 2002-23)
AMENDED	FEBRUARY 14, 2003 (CMA No. 2003-01)
AMENDED	SEPTEMBER 11, 2003 (CMA No. 2003-03)
AMENDED	SEPTEMBER 10, 2003 (CMA No. 2003-04)
AMENDED	OCTOBER 16, 2003 (CMA No. 2003-05)
AMENDED	NOVEMBER 10, 2004 (CMA No. 2004-01)
AMENDED	JUNE 2, 2005 (CMA No. 2005-02)
AMENDED	NOVEMBER 2, 2005 (CMA No. 2005-03)
AMENDED	DECEMBER 4, 2007 (CMA No. 2007-78, 79, 80)

PREPARED BY: PLANNING AND TECHNICAL SUPPORT SECTION
COMMUNITY DEVELOPMENT AND ENVIRONMENTAL SERVICES DIVISION
DATE: 8/2/08 FILE: FLM-0808-2.FMG

R 25 E R 26 E R 27 E R 28 E R 29 E R 30 E R 31 E R 32 E R 33 E R 34 E

T 46 S
T 47 S
T 48 S
T 49 S
T 50 S
T 51 S
T 52 S
T 53 S

EXHIBIT "A"

PETITION CPSP-2006-13

R 25 E

R 26 E

MAP FLUE-10

EXISTING ZONING CONSISTENT WITH FLUE BY POLICY 5.9, 5.10, 5.11, 5.12 COLLIER COUNTY, FLORIDA TOWNSHIP 49, RANGE 25 & 26

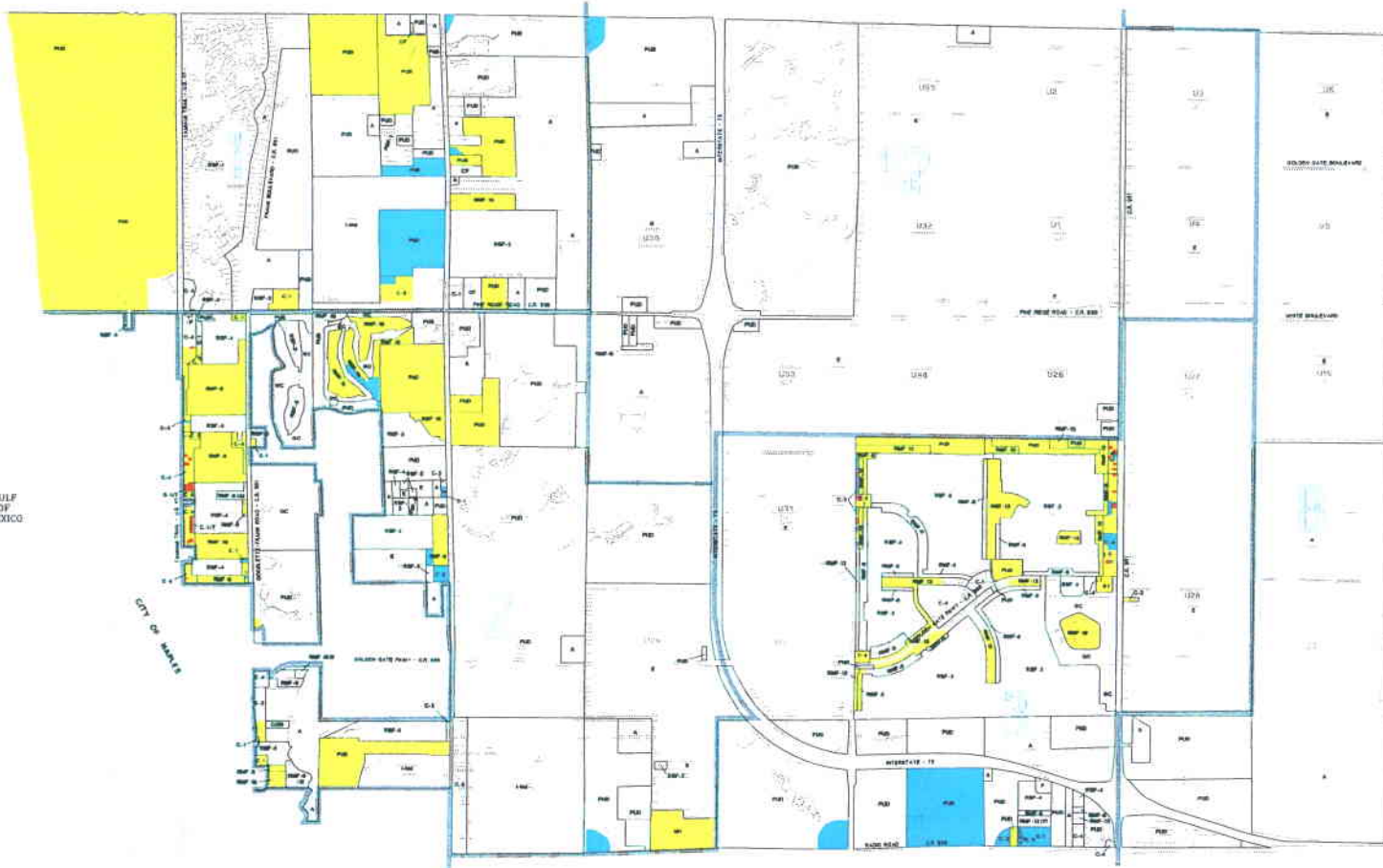

T 49 S

T 49 S

GULF OF MEXICO

CITY OF NAPLES



SCALE
0 1/2 MI. 1 MI.

LEGEND:

- EXEMPTION OR COMPLETION EXEMPTION
- APPLICABLE PROPERTY
- COMMERCIAL UNDEVELOPED
- INDUSTRIAL UNDEVELOPED AND INDUSTRIAL CORPUSCULES ALIGNED TO INDUSTRIAL DEVELOPMENT OR ZONING

REVISED - JANUARY 23, 2007
SHE. NO. 3007-18

PREPARED BY: GRAPHICS AND RECORDS SUPPORT SECTION
FOR THE COMMUNITY PLANNING SECTION, COLLIER COUNTY
COMMUNITY DEVELOPMENT AND ENVIRONMENTAL SERVICES DIVISION
DATE: 1/23/07 FILE: EX-1-11-2006.DWG

R 25 E

R 26 E

R 25 E

R 26 E

MAP FLUE-II

EXISTING ZONING CONSISTENT WITH FLUE BY POLICY 5.9, 5.10, 5.11, 5.12 COLLIER COUNTY, FLORIDA TOWNSHIP 50, RANGE 25 & 26

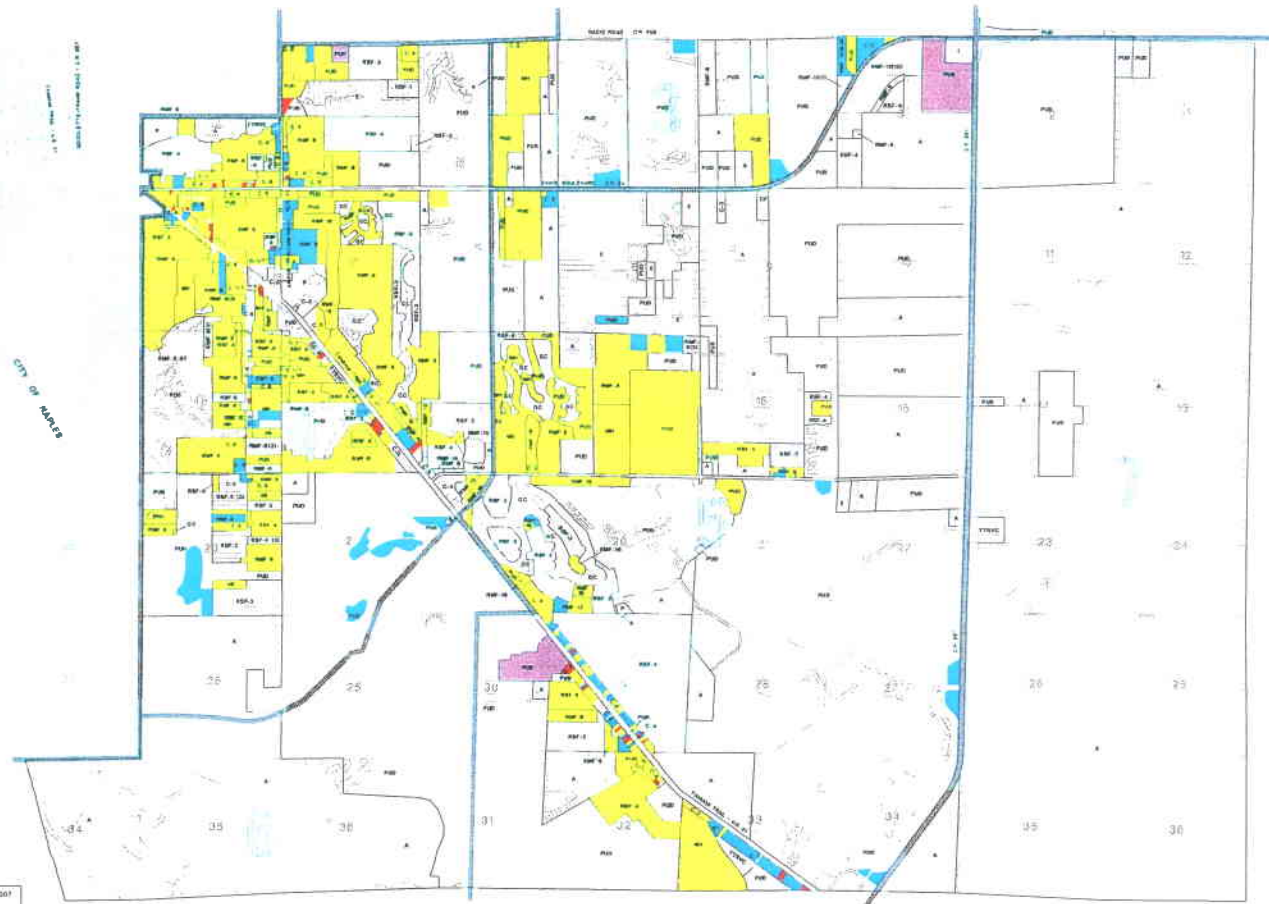

T 50 S

CULP OF MEXICO

CITY OF NAUDES

T 50 S



SCALE
0 1/2 MI 1 MI

LEGEND	
	EXEMPT BY COMPATIBILITY EXCEPTION
	IMPEDER PROPERTY
	CONVICTION UNDER FEDERAL
	INDUSTRIAL UNDER FEDERAL AND INDUSTRIAL EXPANSION, SUBJECT TO INDUSTRIAL DESIGNATION BY ZONING

REVISED - JANUARY 22, 2007
O.W. No. 2007-18

PREPARED BY: GRADUATE AND TECHNICAL SUPPORT SECTION
FOR THE COMPREHENSIVE PLANNING SECTION, COLLIER COUNTY
COMMUNITY DEVELOPMENT AND ENVIRONMENTAL SERVICES DIVISION
DATE: 2/2008 P.L.C. E-13-5-11-2008.DWG

R 25 E

R 26 E

COLLIER COUNTY RURAL & AGRICULTURAL AREA ASSESSMENT
STEWARDSHIP OVERLAY MAP

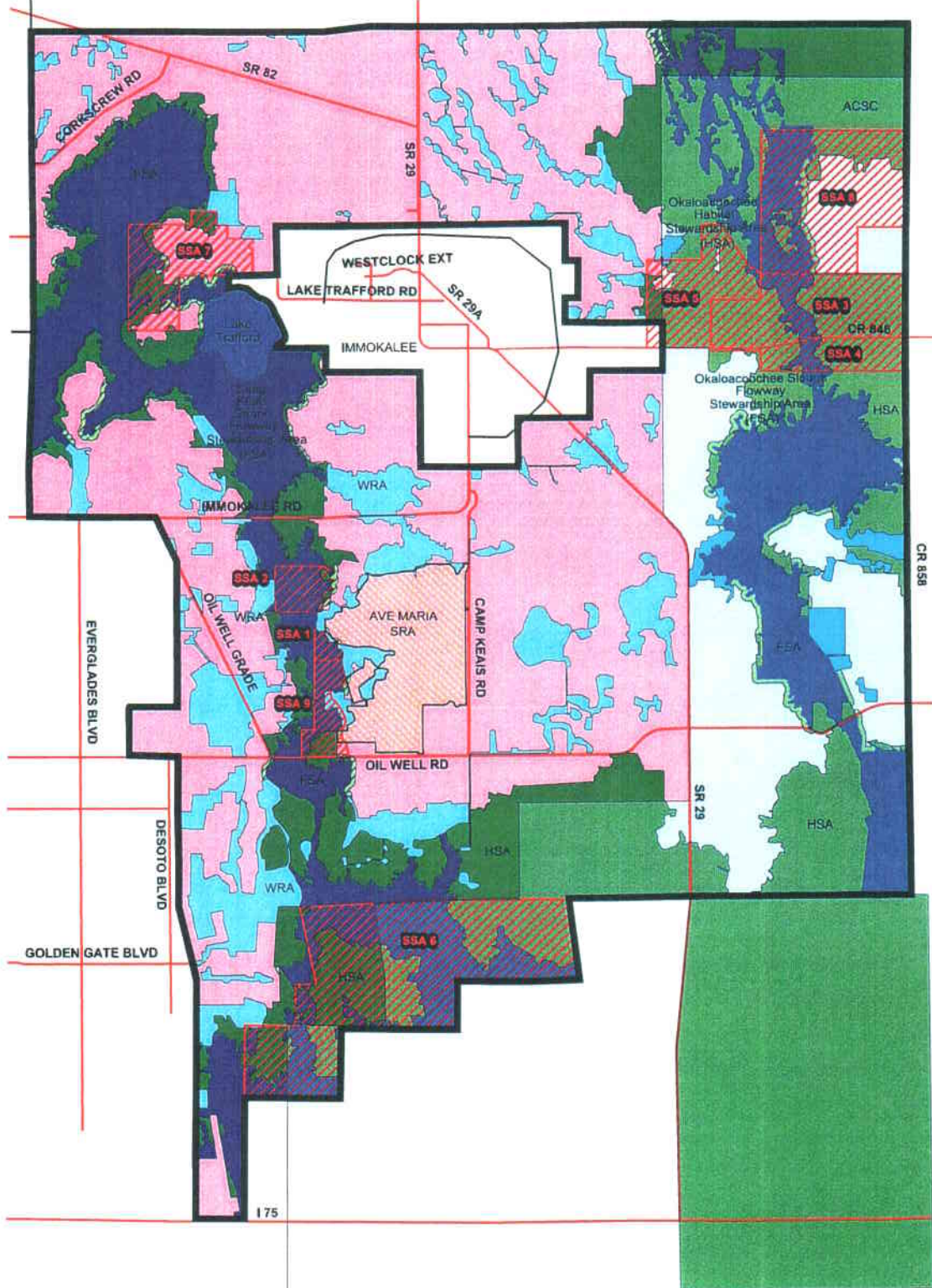

AMENDED - JANUARY 25, 2007
Ord. No. 2007-18

legend

- Open
- Water Retention Area (WRA)
- Flowway Stewardship Area (FSA)
- Habitat Stewardship Area (HSA)
- 500ft Restoration Zone
- Big Cypress National Forest
- Area of Critical State Concern
- Stewardship Receiving Area (SRA)
- Stewardship Sanding Area (SSA)

PREPARED BY: OFFICE OF GRAPHICS AND TECHNICAL SUPPORT
COMMUNITY DEVELOPMENT AND ENVIRONMENTAL SERVICES DIVISION
DATE: 3/2008 FILE: CCRASOM-2008.DWG

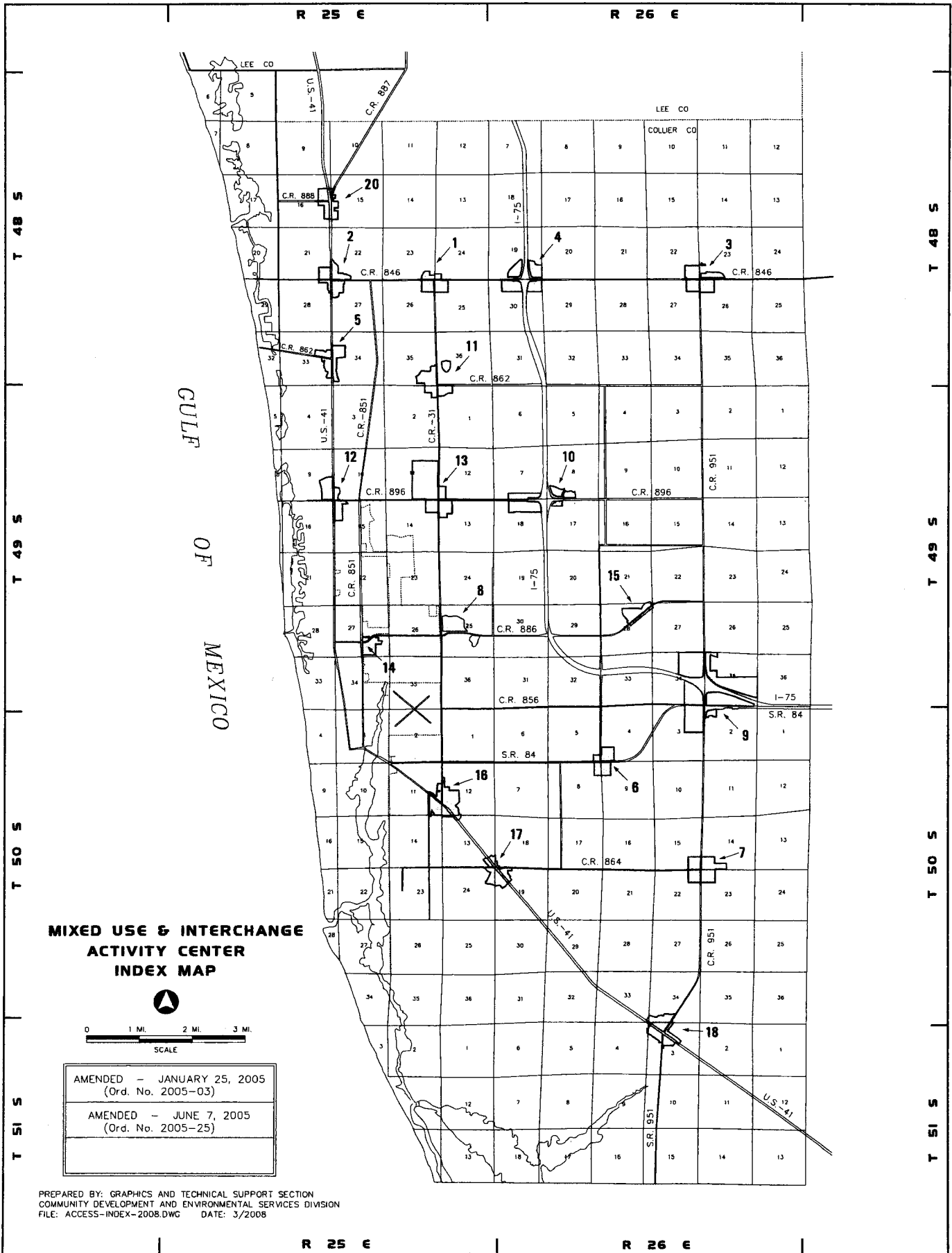

**MIXED USE & INTERCHANGE
ACTIVITY CENTER
INDEX MAP**

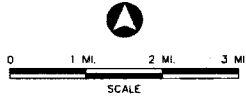

AMENDED - JANUARY 25, 2005 (Ord. No. 2005-03)
AMENDED - JUNE 7, 2005 (Ord. No. 2005-25)

PREPARED BY: GRAPHICS AND TECHNICAL SUPPORT SECTION
COMMUNITY DEVELOPMENT AND ENVIRONMENTAL SERVICES DIVISION
FILE: ACCESS-INDEX-2008.DWG DATE: 3/2008

FUTURE LAND USE MAP
RIVERS AND FLOODPLAINS
Collier County Florida

LEGEND	
1. COCOHATCHEE RIVER	11. PUMPKIN RIVER
2. ROCK CREEK	12. LITTLE WOOD RIVER
3. GORDON RIVER	13. WOOD RIVER
4. HALDEMAN CREEK	14. FAKAHATCHEE RIVER
5. HENDERSON CREEK	15. EAST RIVER
6. JOHN STEVENS CREEK	16. PARADISE RIVER
7. BIG MARCO RIVER	17. FERGUSON RIVER
8. ROYAL PALM HAMMOCK CREEK	18. BARRON RIVER
9. BLACK WATER RIVER	19. HALFWAY CREEK
10. WHITNEY RIVER	20. TURNER RIVER
[Symbol] 100 YEAR FLOODPLAIN	

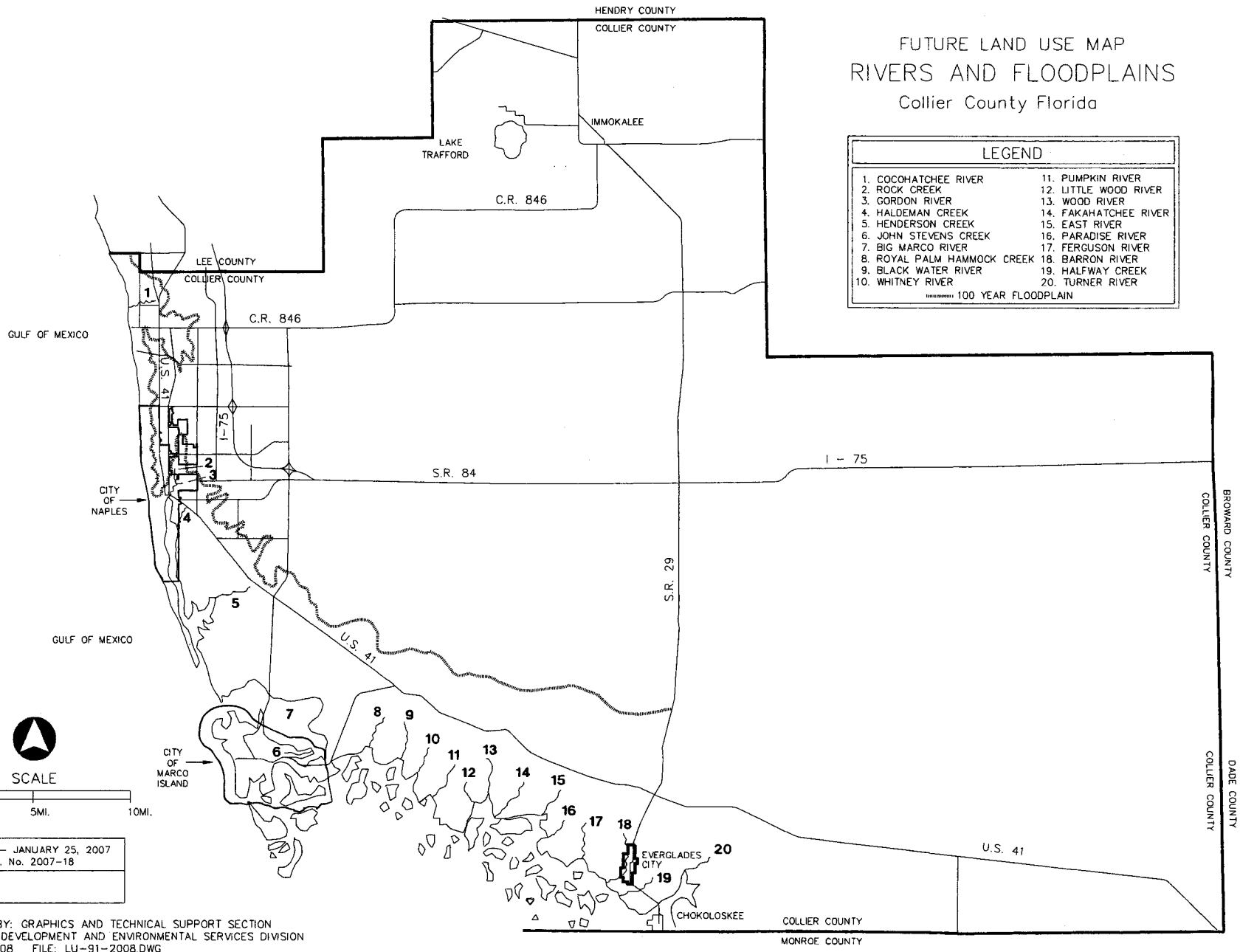

SCALE

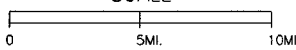

ADOPTED - JANUARY 25, 2007
Ord. No. 2007-18

PREPARED BY: GRAPHICS AND TECHNICAL SUPPORT SECTION
COMMUNITY DEVELOPMENT AND ENVIRONMENTAL SERVICES DIVISION
DATE: 3/2008 FILE: LU-91-2008.DWG

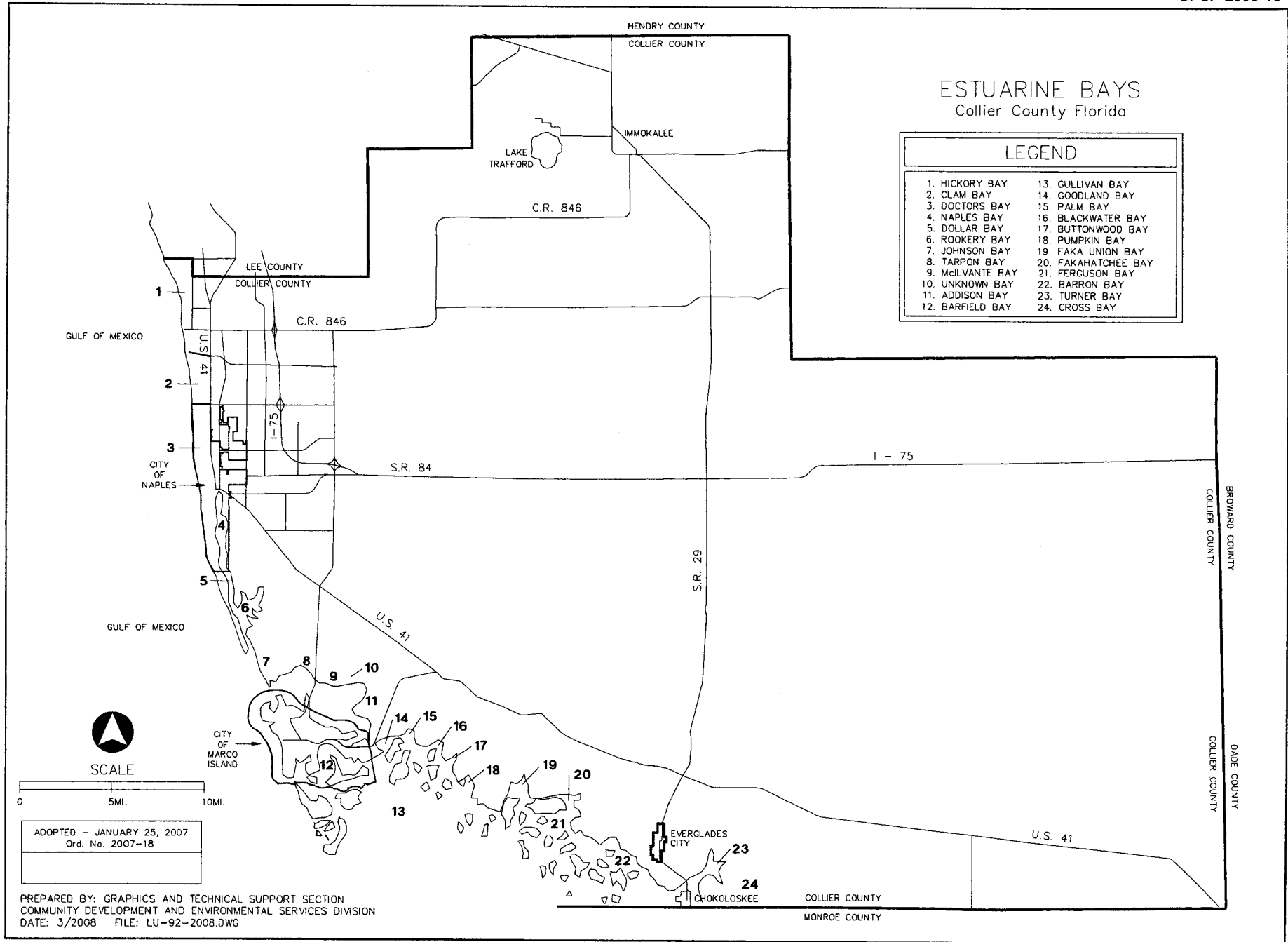

FUTURE LAND USE MAP SOILS Western Collier County, Florida

LEGEND

SOILS OF THE MANMADE AREAS

1. URBANIZED - UDORTMENTS - BASINGER ASSOCIATION

SOILS OF THE TIDAL AREAS

2. DURBIN - WULFERT - CANAVERAL ASSOCIATION

3. KESSON - ANGLOTE - PECKISH ASSOCIATION

SOILS OF THE SWAMPS, PRAIRIES AND FRESHWATER MARSHES

4. OCHOPEE - PENNSUCO ASSOCIATION

5. RIVERA - BOCA - COPELAND ASSOCIATION

6. WINDER - RIVERA - CHOBEE ASSOCIATION

SOILS OF THE FLATWOODS, SLOUGHS AND HAMMOCKS

7. PINEDA - BOCA - HALLDALE ASSOCIATION

8. IMMOKALEE - BASINGER - OLDSMAR ASSOCIATION

9. HOLOPAW - BASINGER - IMMOKALEE ASSOCIATION

10. WABASSO - WINDER - HOLOPAW ASSOCIATION

PLEASE NOTE THAT THIS LEGEND AND ATTACHED GENERAL SOILS MAP ARE PRELIMINARY DRAFTS. MINOR ADJUSTMENTS ARE LIKELY BEFORE PUBLICATION.

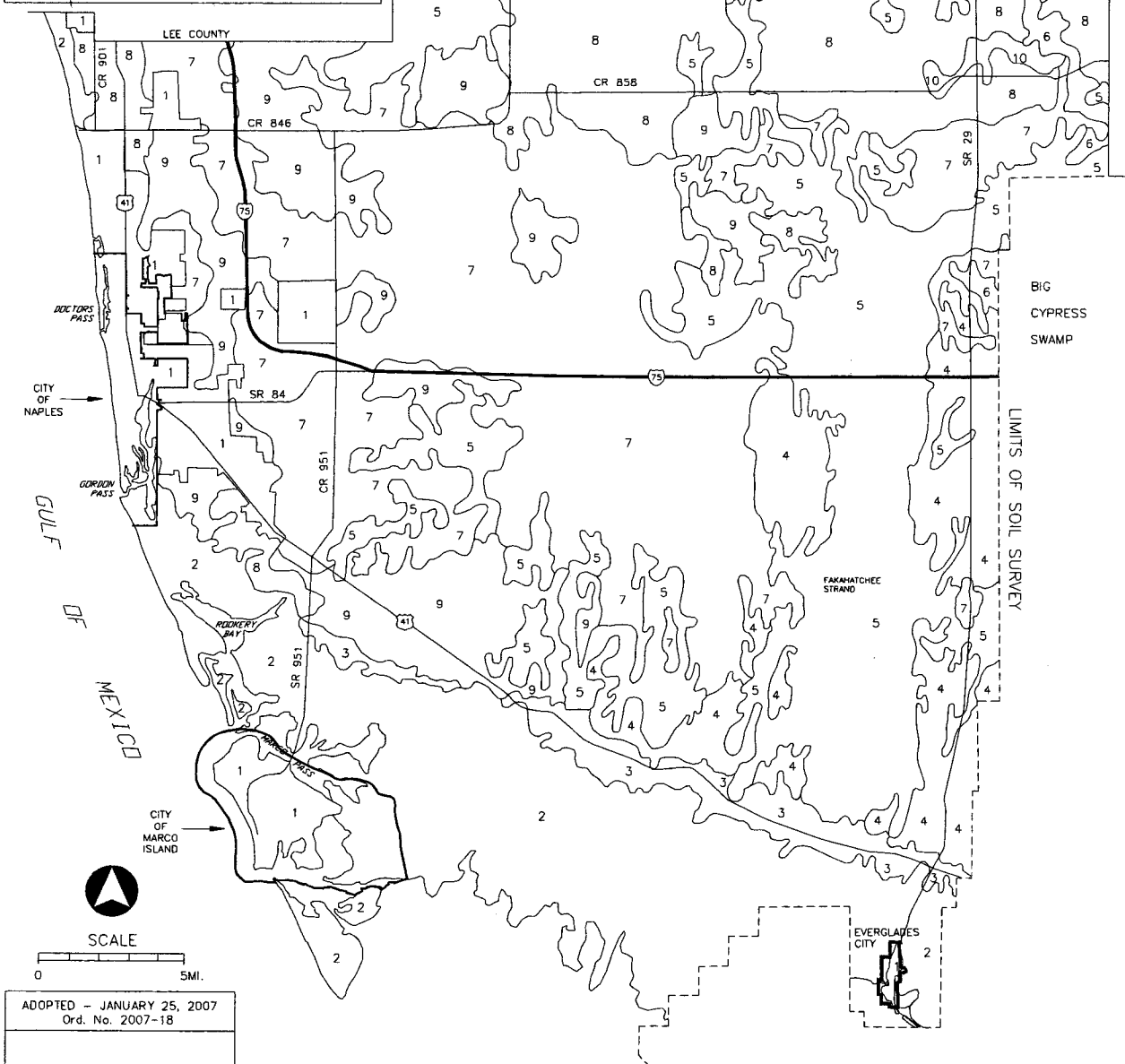

ADOPTED - JANUARY 25, 2007
Ord. No. 2007-18

SOURCE: U.S. DEPARTMENT OF AGRICULTURE, SOIL CONSERVATION SERVICE, JUNE 1988
PREPARED BY: GRAPHICS AND TECHNICAL SUPPORT SECTION
COMMUNITY DEVELOPMENT AND ENVIRONMENTAL SERVICES DIVISION
DATE: 3/2008 FILE: LU-94-2008.DWG

EACH AREA OUTLINED ON THIS MAP CONSISTS OF MORE THAN ONE KIND OF SOIL. THE MAP IS THUS MEANT FOR GENERAL PLANNING RATHER THAN A BASIS FOR DECISIONS ON THE USE OF SPECIFIC TRACTS.

FUTURE LAND USE MAP EXISTING COMMERCIAL MINERAL EXTRACTION SITES Collier County Florida

LEGEND	
	● EXTRACTION SITES
1. STEWART	6. ORANGE TREE
2. BIG ISLAND EXCAVATING/ LONGAN LAKES	7. SUNNILAND
3. SR846 LAND TRUST	8. GOLDEN GATE
4. WINCHESTER	9. WILLOW RUN
5. AVE MARIA	10. SEA-CON
NOTE: EXCLUDES SITES ≤ 10 ACRES.	

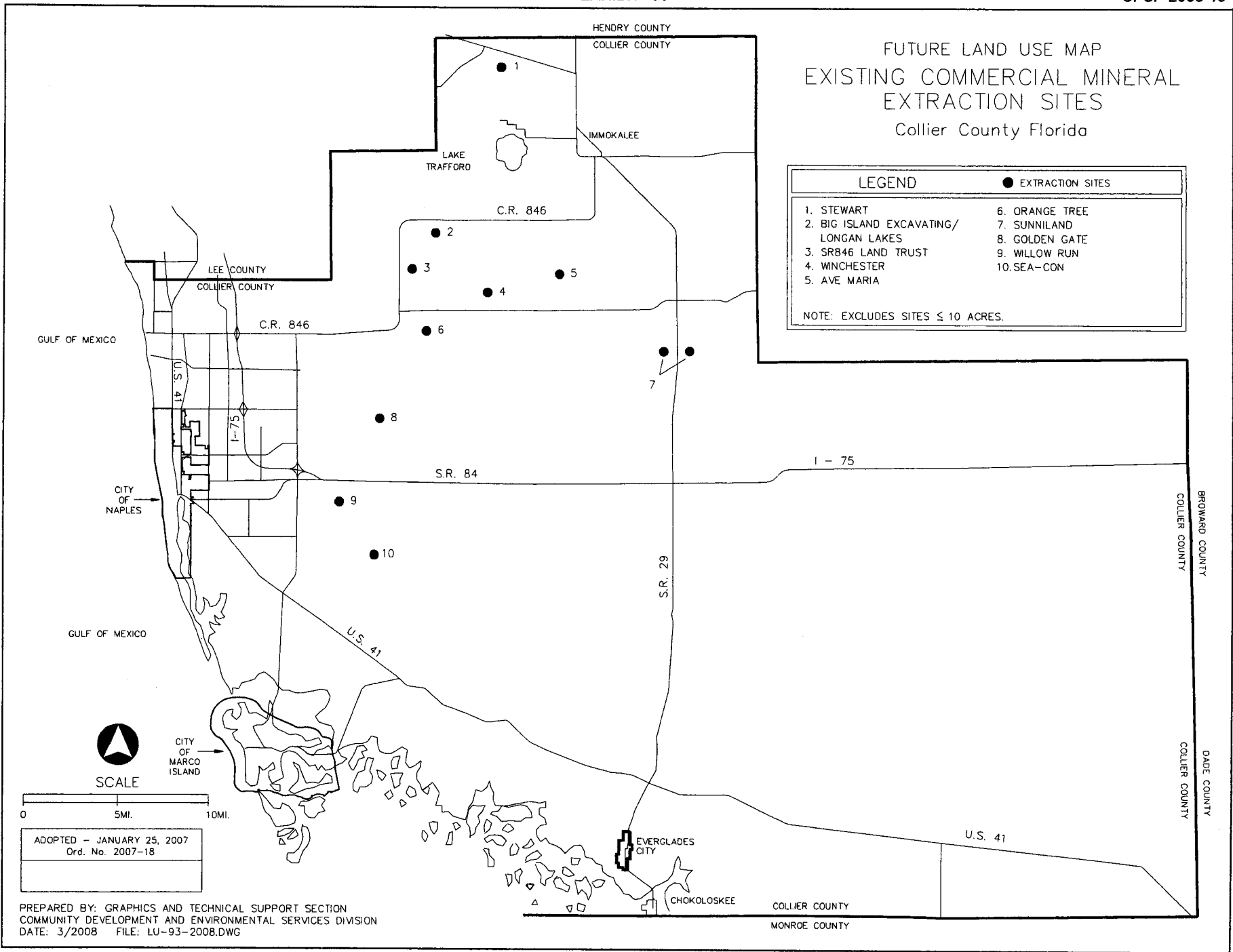

SCALE

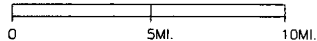



ADOPTED - JANUARY 25, 2007
Ord. No. 2007-18

PREPARED BY: GRAPHICS AND TECHNICAL SUPPORT SECTION
COMMUNITY DEVELOPMENT AND ENVIRONMENTAL SERVICES DIVISION
DATE: 3/2008 FILE: LU-93-2008.DWG

GOODLETTE/PINE RIDGE COMMERCIAL INFILL SUBDISTRICT

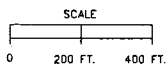
COLLIER COUNTY, FLORIDA



LEGEND	
	GOODLETTE/PINE RIDGE COMMERCIAL INFILL SUBDISTRICT

PREPARED BY: GRAPHICS AND TECHNICAL SUPPORT SECTION
 COMMUNITY DEVELOPMENT AND ENVIRONMENTAL SERVICES DIVISION
 DATE: 3/2008 FILE: CPSP-2006-13A.DWG

LIVINGSTON ROAD / VETERANS MEMORIAL BOULEVARD COMMERCIAL INFILL SUBDISTRICT

COLLIER COUNTY, FLORIDA

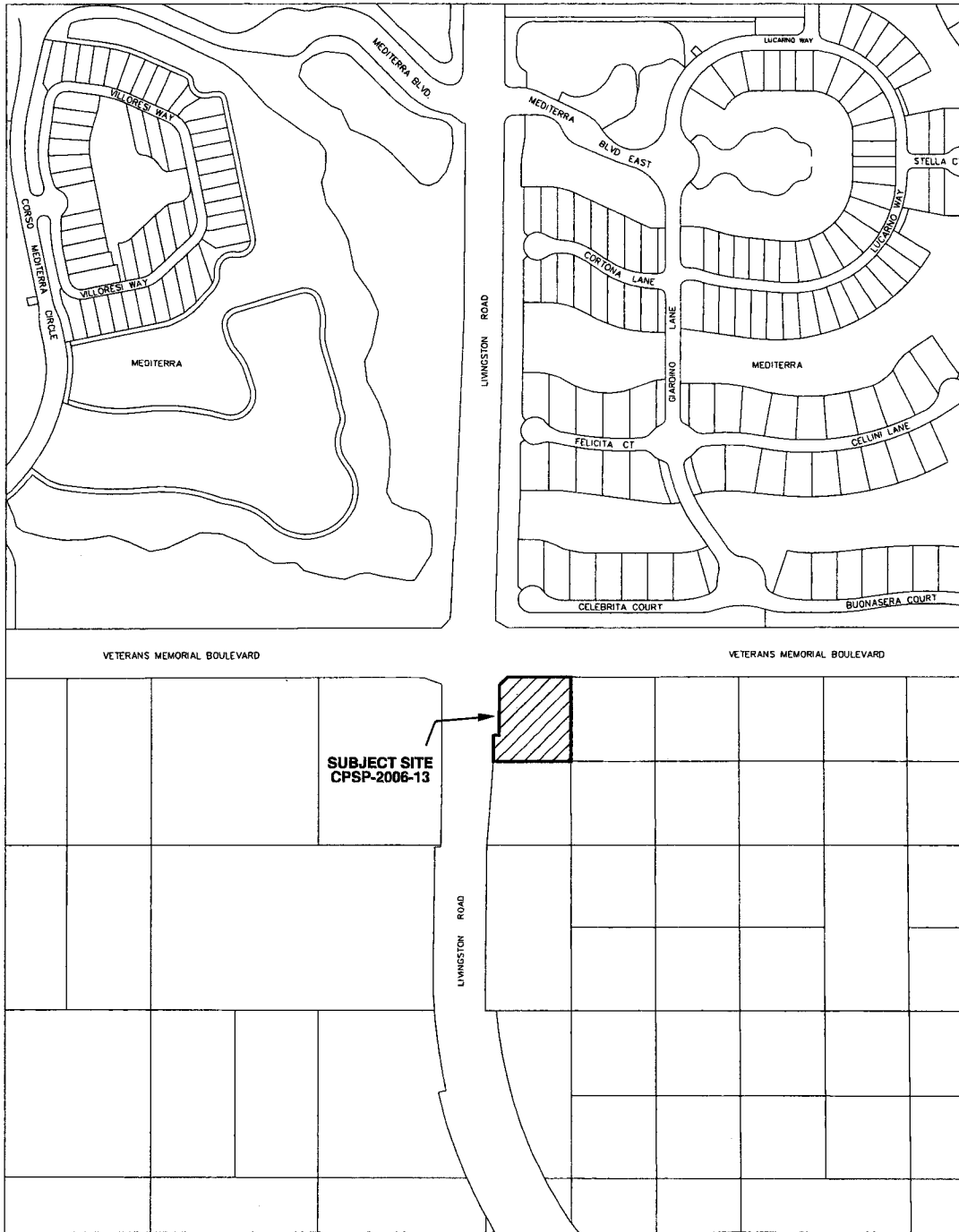

LEGEND



SUBDISTRICT

SCALE

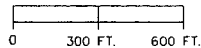

PREPARED BY: GRAPHICS AND TECHNICAL SUPPORT SECTION
 COMMUNITY DEVELOPMENT AND ENVIRONMENTAL SERVICES DIVISION
 DATE: 3/2008 FILE: CP-2003-3A-2008.DWG

GOLDEN GATE AREA MASTER PLAN STUDY AREAS

COLLIER COUNTY, FLORIDA

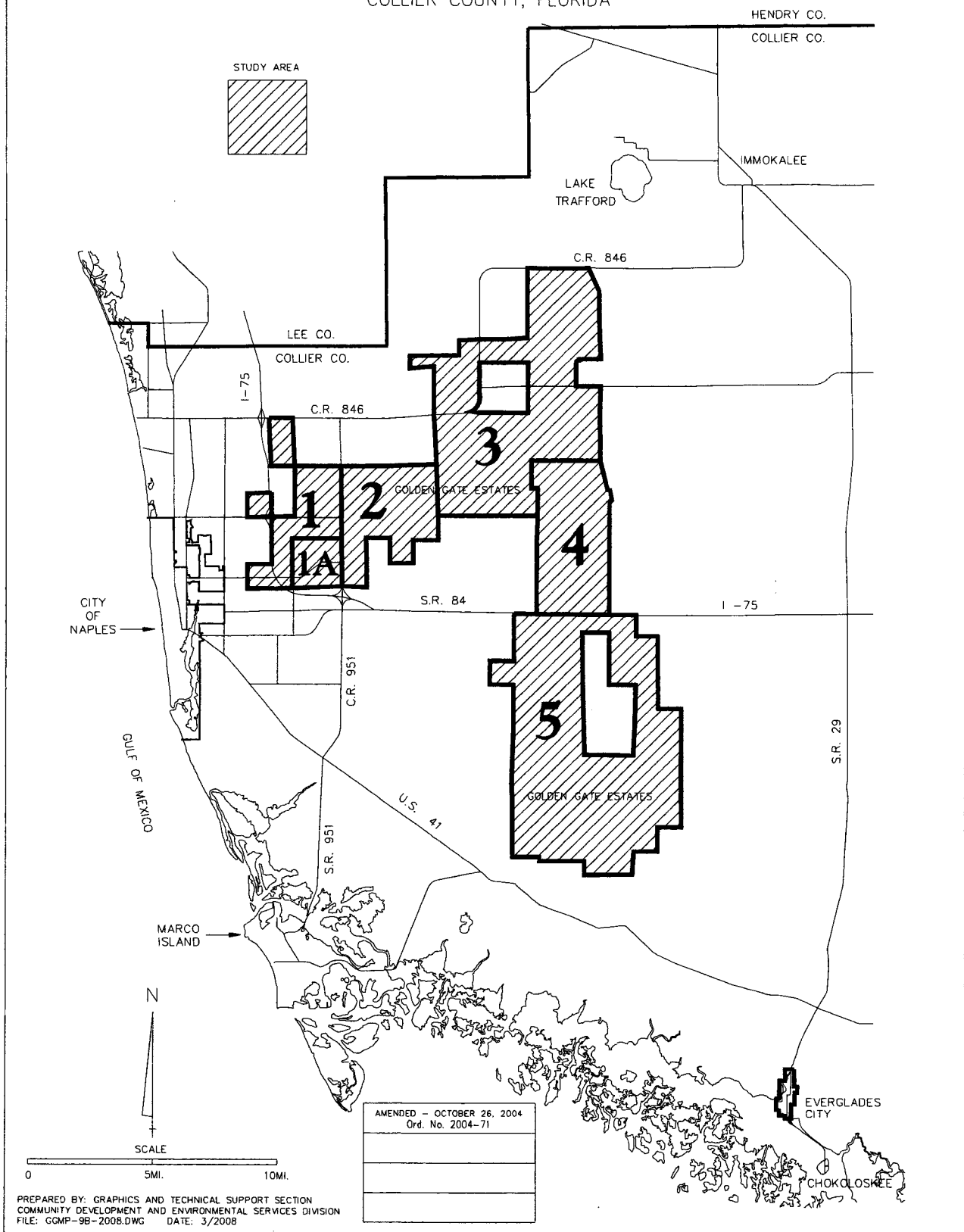

GOLDEN GATE AREA FUTURE LAND USE MAP

LEGEND

URBAN DESIGNATION	ESTATES DESIGNATION	AGRICULTURAL/RURAL DESIGNATION
<ul style="list-style-type: none"> URBAN RESIDENTIAL SUBDISTRICT HIGH DENSITY RESIDENTIAL SUBDISTRICT COMMUNITY CENTER COMMERCIAL SUBDISTRICT 	<ul style="list-style-type: none"> URBAN RESIDENTIAL SUBDISTRICT RESIDENTIAL ESTATES SUBDISTRICT CONDITIONAL USES SUBDISTRICT NEIGHBORHOOD CENTER SUBDISTRICT COMMERCIAL DISTRICT INTERCHANGE ACTIVITY CENTER SUBDISTRICT (AS DESCRIBED IN THE FUTURE LAND USE ELEMENT IN THE CDP) PINE RIDGE ROAD MIXED USE SUBDISTRICT PANHANDLE BOULEVARD COMMERCIAL SUBDISTRICT COMMERCIAL WESTERN ESTATES (MFL) SUBDISTRICT GOLDEN GATE ESTATES COMMERCIAL (MFL) SUBDISTRICT 	<ul style="list-style-type: none"> RURAL SETTLEMENT AREA DISTRICT

OVERLAYS AND SPECIAL FEATURES

- SPRINGING GOLDEN GATE ESTATES NATURAL RESOURCE PROTECTION AREA OVERLAY
- RESIDENTIAL DENSITY BAND

NOTE: THIS MAP CANNOT BE INTERPRETED WITHOUT THE GOALS, OBJECTIVES, POLICIES AND LAND USE DESIGNATION DESCRIPTION SECTION OF THE GOLDEN GATE AREA MASTER PLAN.

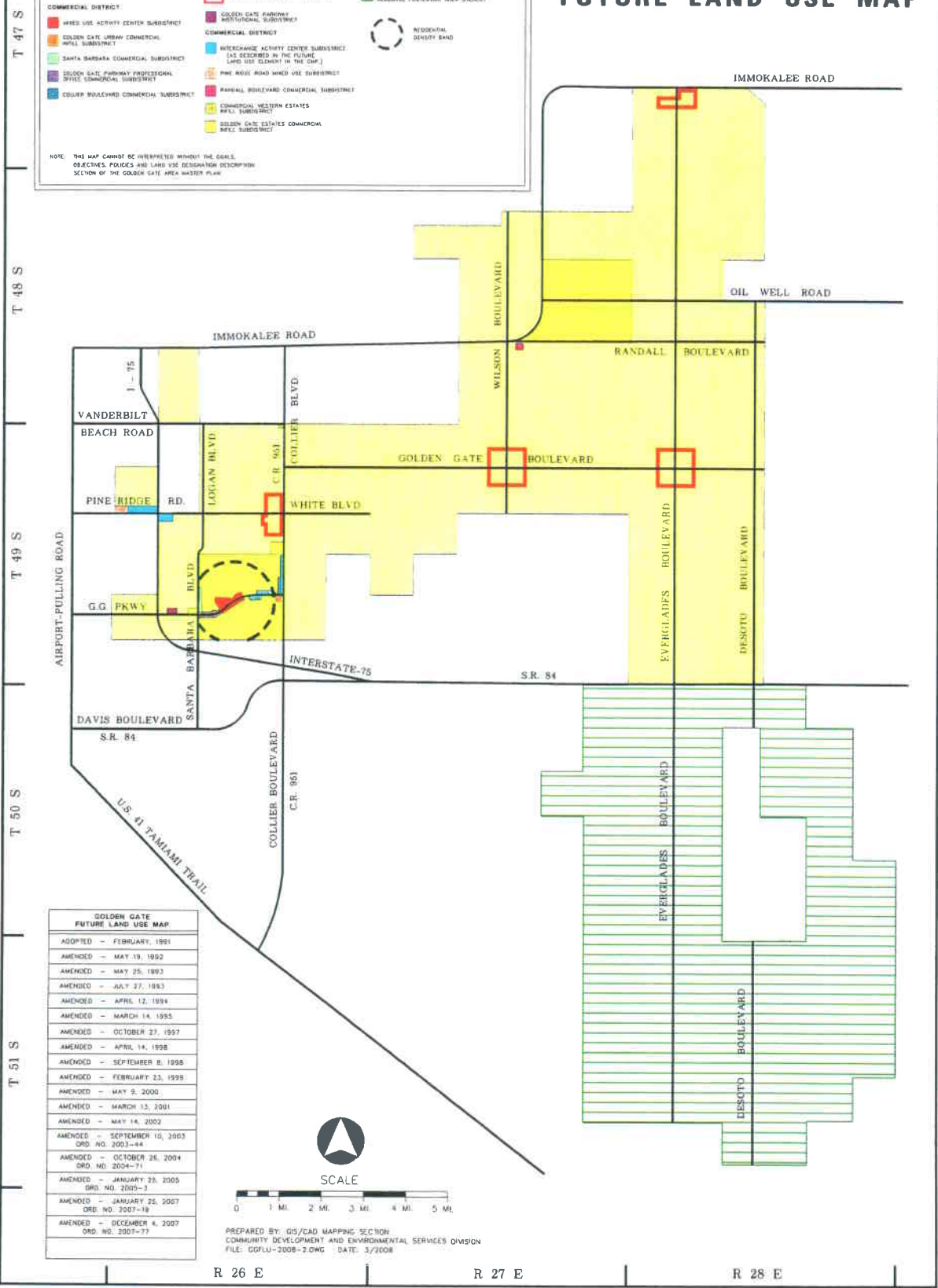

GOLDEN GATE FUTURE LAND USE MAP	
ADOPTED	- FEBRUARY, 1991
AMENDED	- MAY 19, 1992
AMENDED	- MAY 25, 1993
AMENDED	- JULY 27, 1993
AMENDED	- APRIL 17, 1994
AMENDED	- MARCH 14, 1995
AMENDED	- OCTOBER 27, 1997
AMENDED	- APRIL 14, 1998
AMENDED	- SEPTEMBER 8, 1998
AMENDED	- FEBRUARY 23, 1999
AMENDED	- MAY 9, 2000
AMENDED	- MARCH 15, 2001
AMENDED	- MAY 14, 2002
AMENDED	- SEPTEMBER 10, 2003 ORD. NO. 2003-44
AMENDED	- OCTOBER 26, 2004 ORD. NO. 2004-71
AMENDED	- JANUARY 23, 2005 ORD. NO. 2005-3
AMENDED	- JANUARY 25, 2007 ORD. NO. 2007-18
AMENDED	- DECEMBER 4, 2007 ORD. NO. 2007-77



PREPARED BY: GIS/CAD MAPPING SECTION
COMMUNITY DEVELOPMENT AND ENVIRONMENTAL SERVICES DIVISION
FILE: GDFLU-2006-2.DWG DATE: 3/2008

HIGH DENSITY RESIDENTIAL SUBDISTRICT 1989 BOUNDARIES OF ACTIVITY CENTER

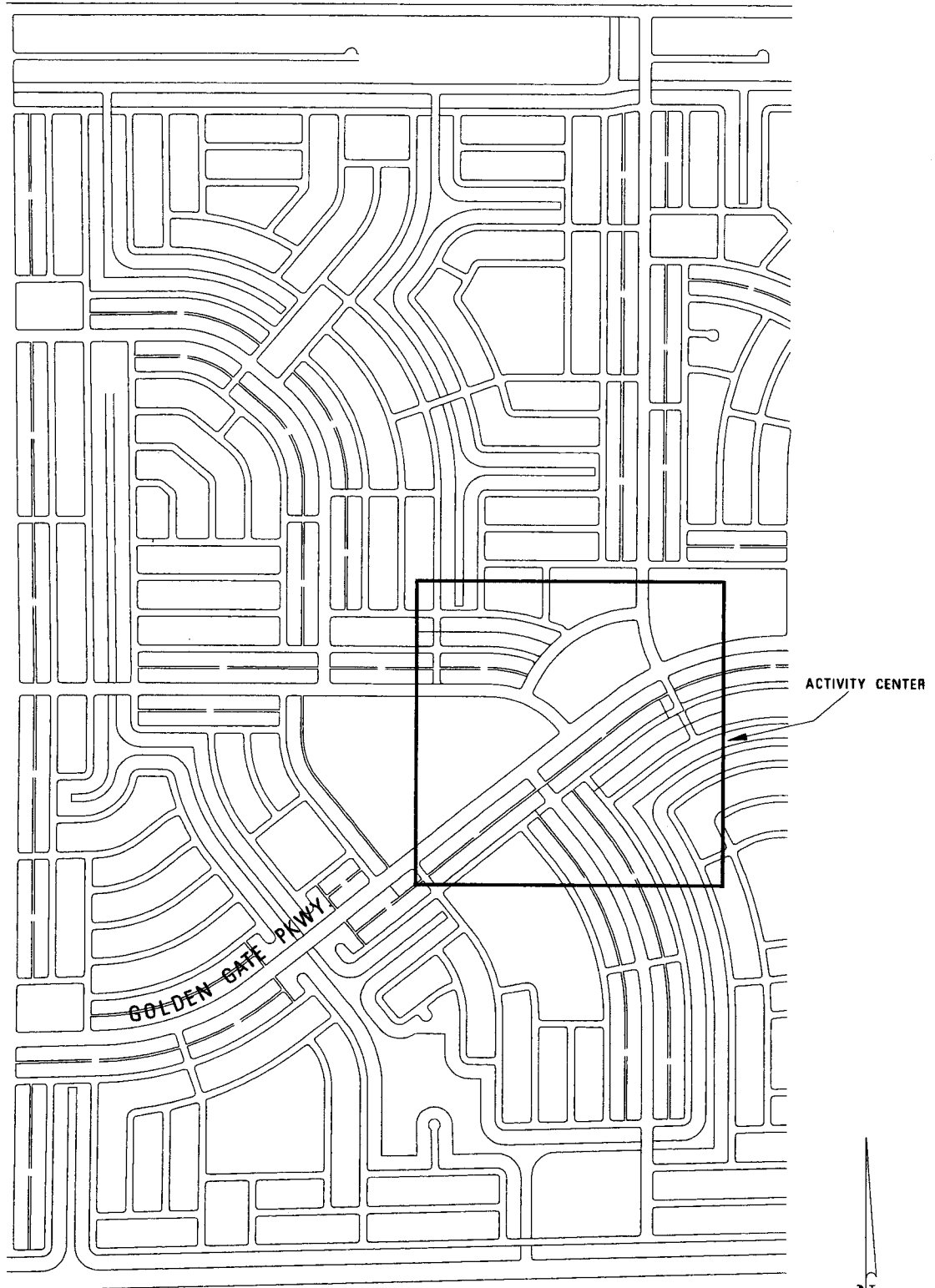

PREPARED BY: GRAPHICS AND TECHNICAL SUPPORT SECTION
COMMUNITY DEVELOPMENT AND ENVIRONMENTAL SERVICES DIVISION
FILE: GGMP-6B-2008.DWG DATE: 3/2008

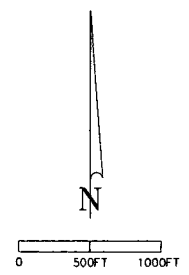

DOWNTOWN CENTER COMMERCIAL SUBDISTRICT
COLLIER COUNTY, FLORIDA

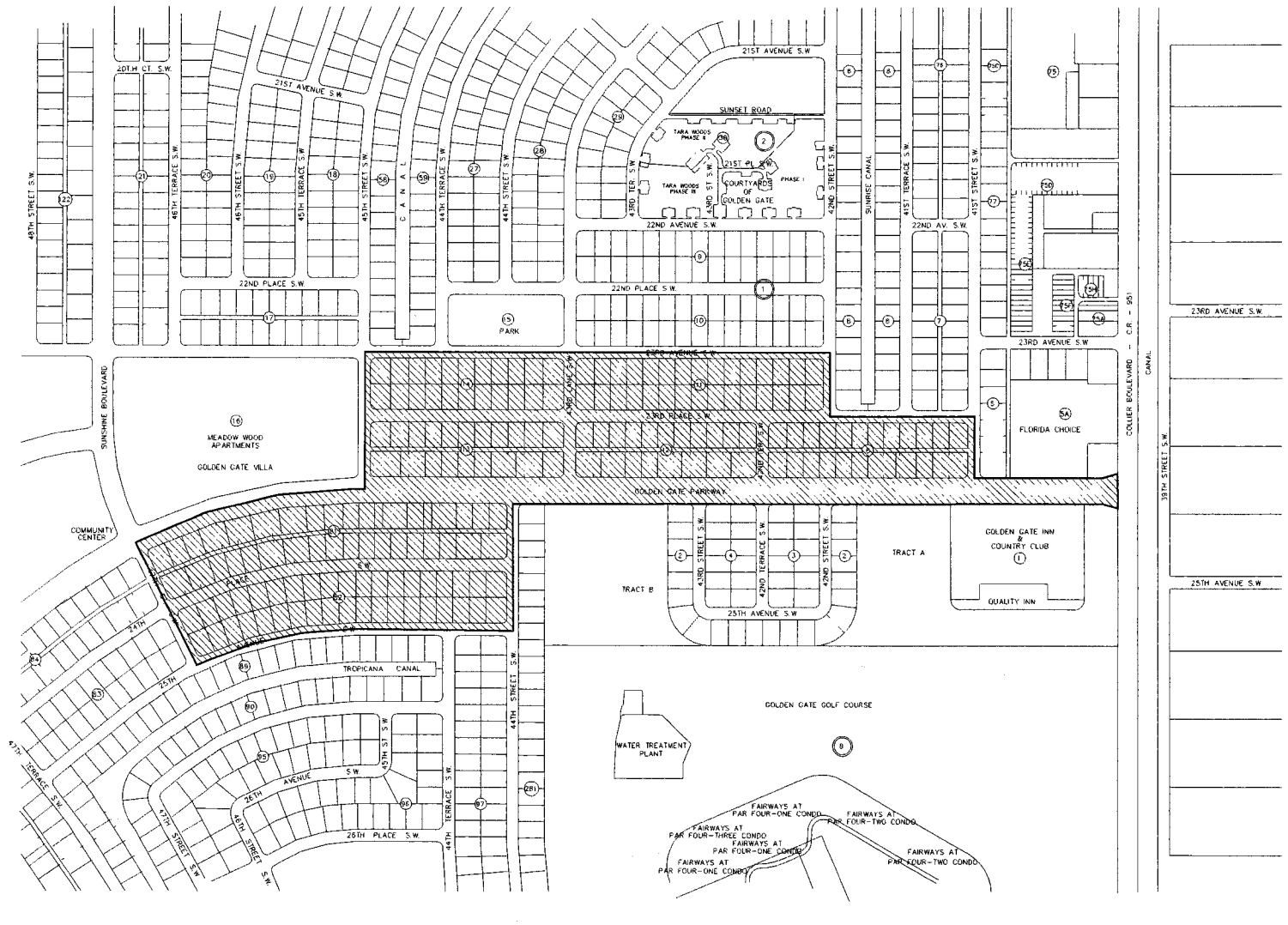

PREPARED BY: GRAPHICS AND TECHNICAL SUPPORT SECTION
COMMUNITY DEVELOPMENT AND ENVIRONMENTAL SERVICES DIVISION
FILE: GGMP-52A-2008.DWG DATE: 3/2008

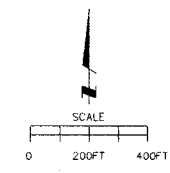

ADOPTED - OCTOBER 26, 2004 (Ord. No. 2004-71)
AMENDED - JANUARY 25, 2007 (Ord. No. 2007-19)

LEGEND	
	DOWNTOWN CENTER COMMERCIAL SUBDISTRICT

URBAN MIXED USE ACTIVITY CENTER
GOLDEN GATE PARKWAY AND CORONADO PARKWAY
COLLIER COUNTY, FLORIDA

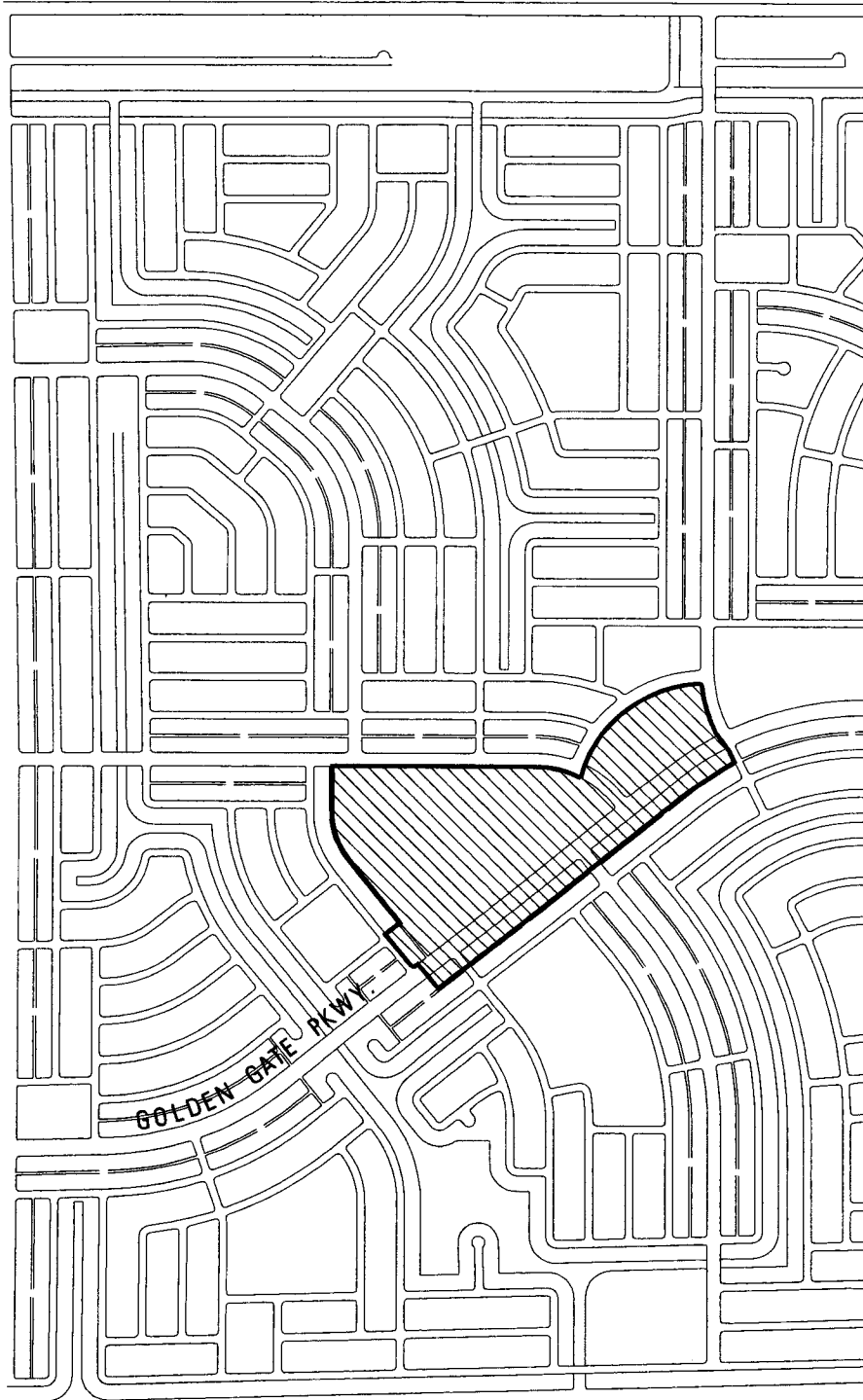

AMENDED - JANUARY 25, 2005
Ord. No. 2005-3

AMENDED - JANUARY 25, 2007
(Ord. No. 2007-19)

PREPARED BY: GRAPHICS AND TECHNICAL SUPPORT SECTION
COMMUNITY DEVELOPMENT AND ENVIRONMENTAL SERVICES DIVISION
FILE: CPSS-2004-1B-2008.DWG DATE: 3/2008

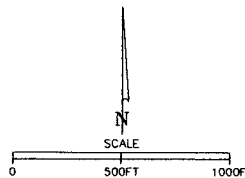

URBAN MIXED USE ACTIVITY CENTER
GOLDEN GATE PARKWAY AND CORONADO PARKWAY

LEGEND

 ACTIVITY CENTER BOUNDARIES

GOLDEN GATE URBAN COMMERCIAL INFILL SUBDISTRICT AND GOLDEN GATE ESTATES COMMERCIAL INFILL SUBDISTRICT COLLIER COUNTY, FLORIDA

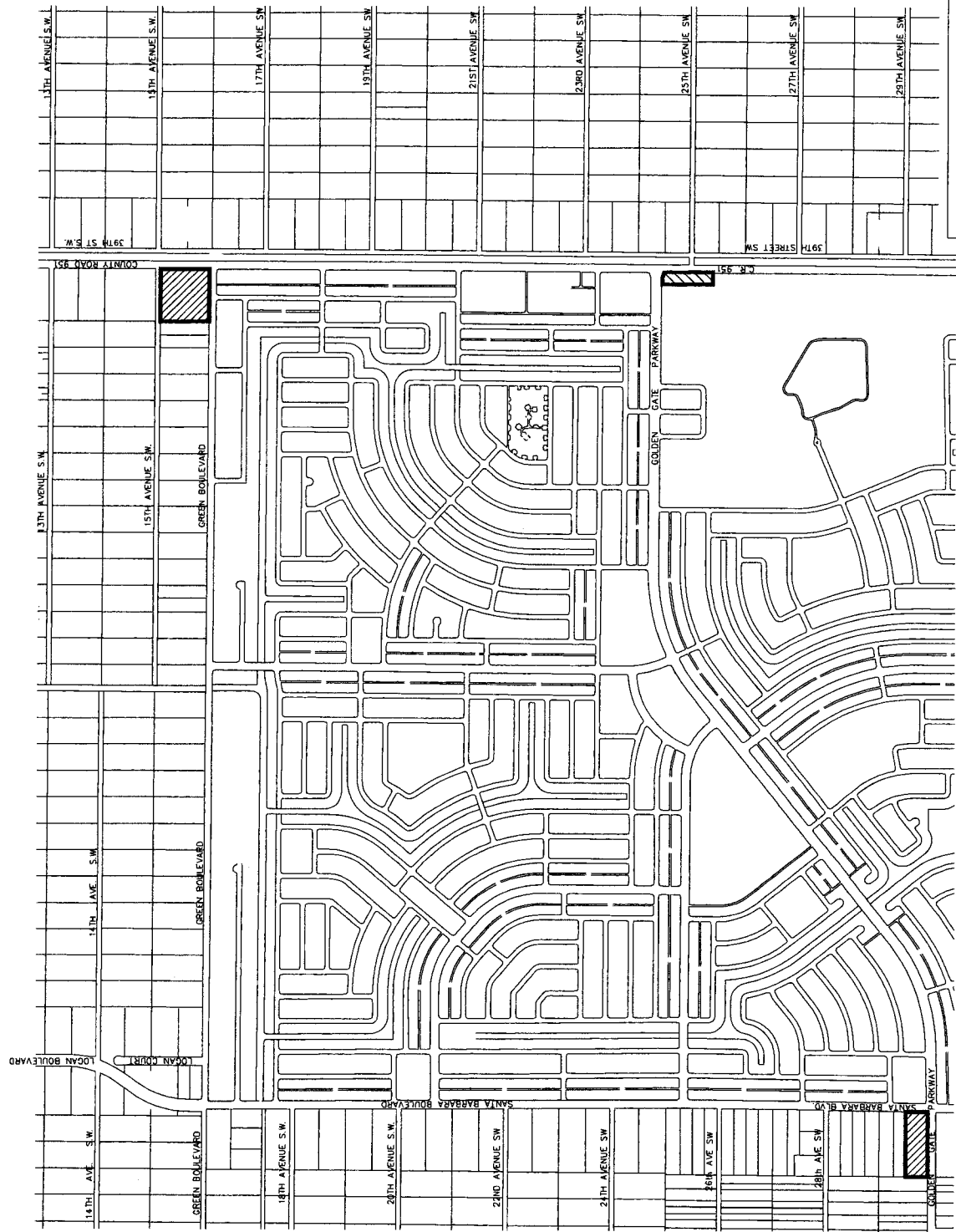

AMENDED - SEPTEMBER 10, 2003
Ord. No. 2003-44

AMENDED - JANUARY 25, 2007
(Ord. No. 2007-19)

PREPARED BY: GRAPHICS AND TECHNICAL SUPPORT SECTION
COMMUNITY DEVELOPMENT AND ENVIRONMENTAL SERVICES DIVISION
FILE: CP-2000-7A-2008.DWG DATE: 3/2008

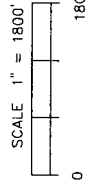

LEGEND

GOLDEN GATE URBAN COMMERCIAL INFILL SUBDISTRICT

GOLDEN GATE ESTATES COMMERCIAL INFILL SUBDISTRICT

SANTA BARBARA COMMERCIAL SUBDISTRICT
COLLIER COUNTY, FLORIDA

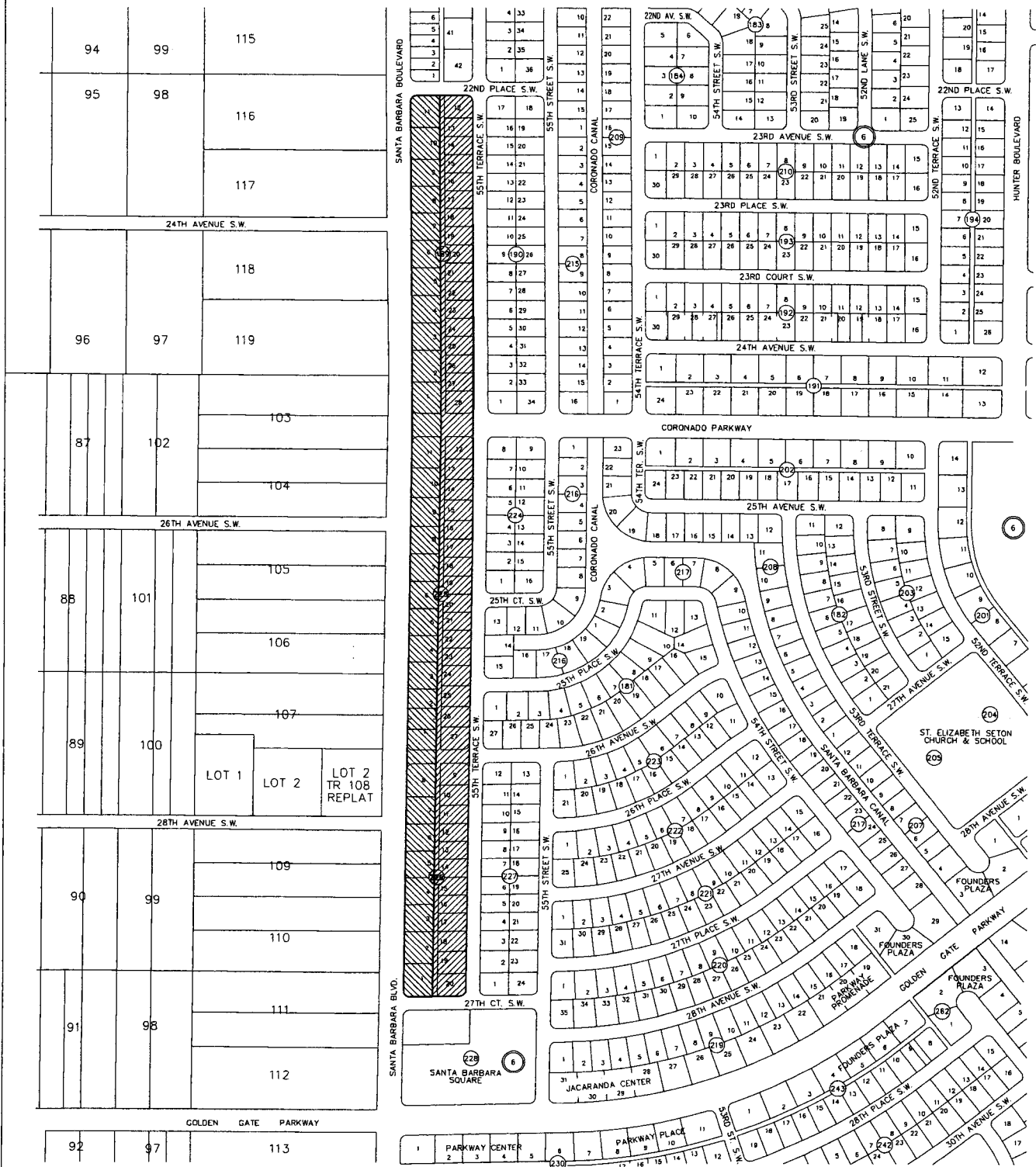

PREPARED BY: GRAPHICS AND TECHNICAL SUPPORT SECTION
 COMMUNITY DEVELOPMENT AND ENVIRONMENTAL SERVICES DIVISION
 FILE: CPSP-2004-7G-2008.DWG DATE: 3/2008

AMENDED - OCTOBER 25, 2004
 (Ord. No. 2004-71)

AMENDED - JUNE 7, 2005
 (Ord. No. 2005-25)

SANTA BARBARA COMMERCIAL SUBDISTRICT
LEGEND

	ORIGINAL SUBDISTRICT		SUBDISTRICT EXPANSION
--	----------------------	--	-----------------------

GOLDEN GATE PARKWAY PROFESSIONAL OFFICE COMMERCIAL SUBDISTRICT
Collier County, Florida

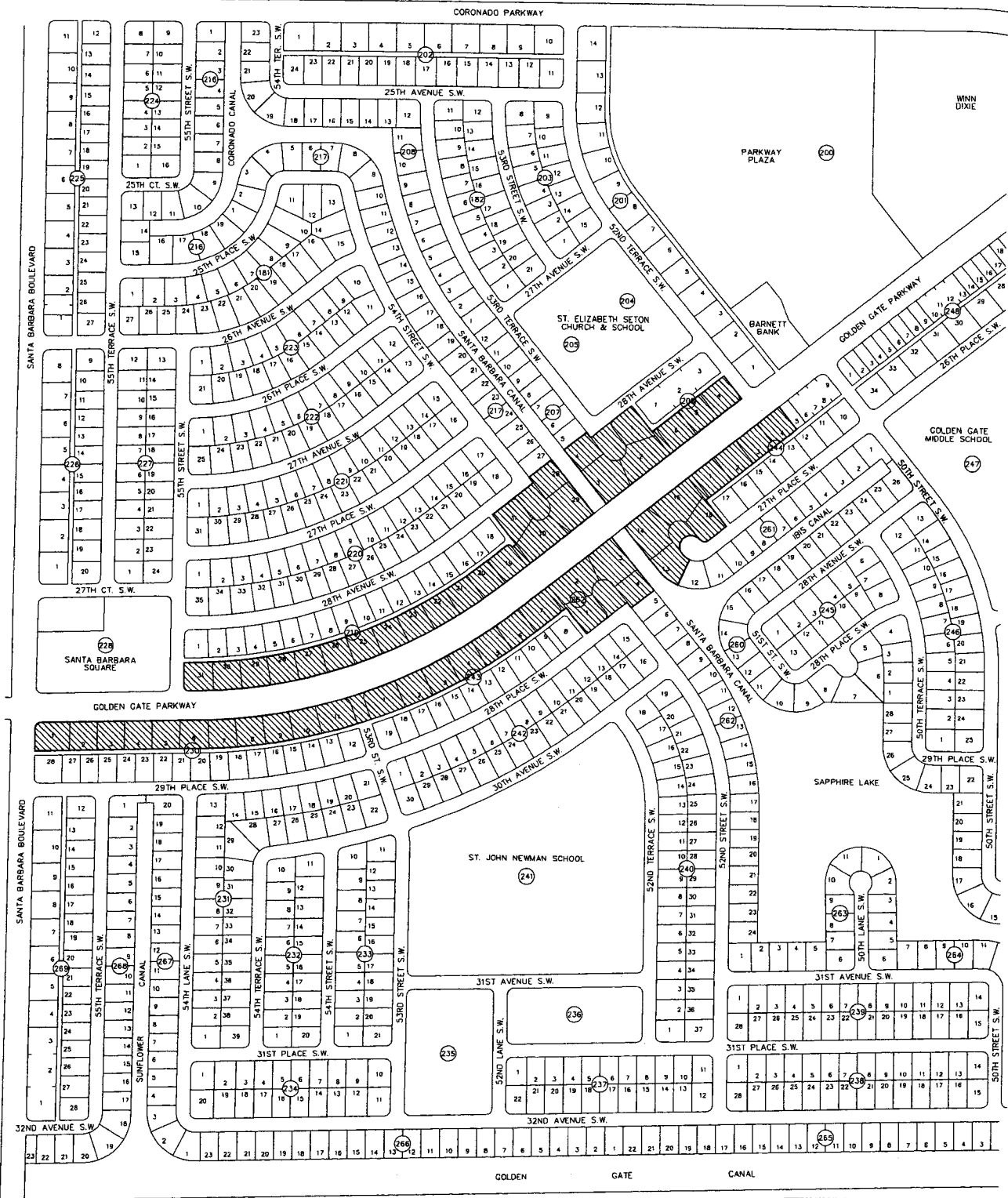

PREPARED BY: GRAPHICS AND TECHNICAL SUPPORT SECTION
 COMMUNITY DEVELOPMENT AND ENVIRONMENTAL SERVICES DIVISION
 FILE: CPSP-2004-7F-2008.DWG DATE: 3/2008

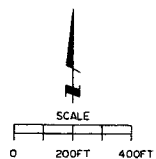

AMENDED - JANUARY 25, 2005
 (Ord. No. 2005-03)

AMENDED - JUNE 7, 2005
 (Ord. No. 2005-25)

LEGEND

 PROFESSIONAL OFFICE SUBDISTRICT

COLLIER BOULEVARD COMMERCIAL SUBDISTRICT
COLLIER COUNTY, FLORIDA

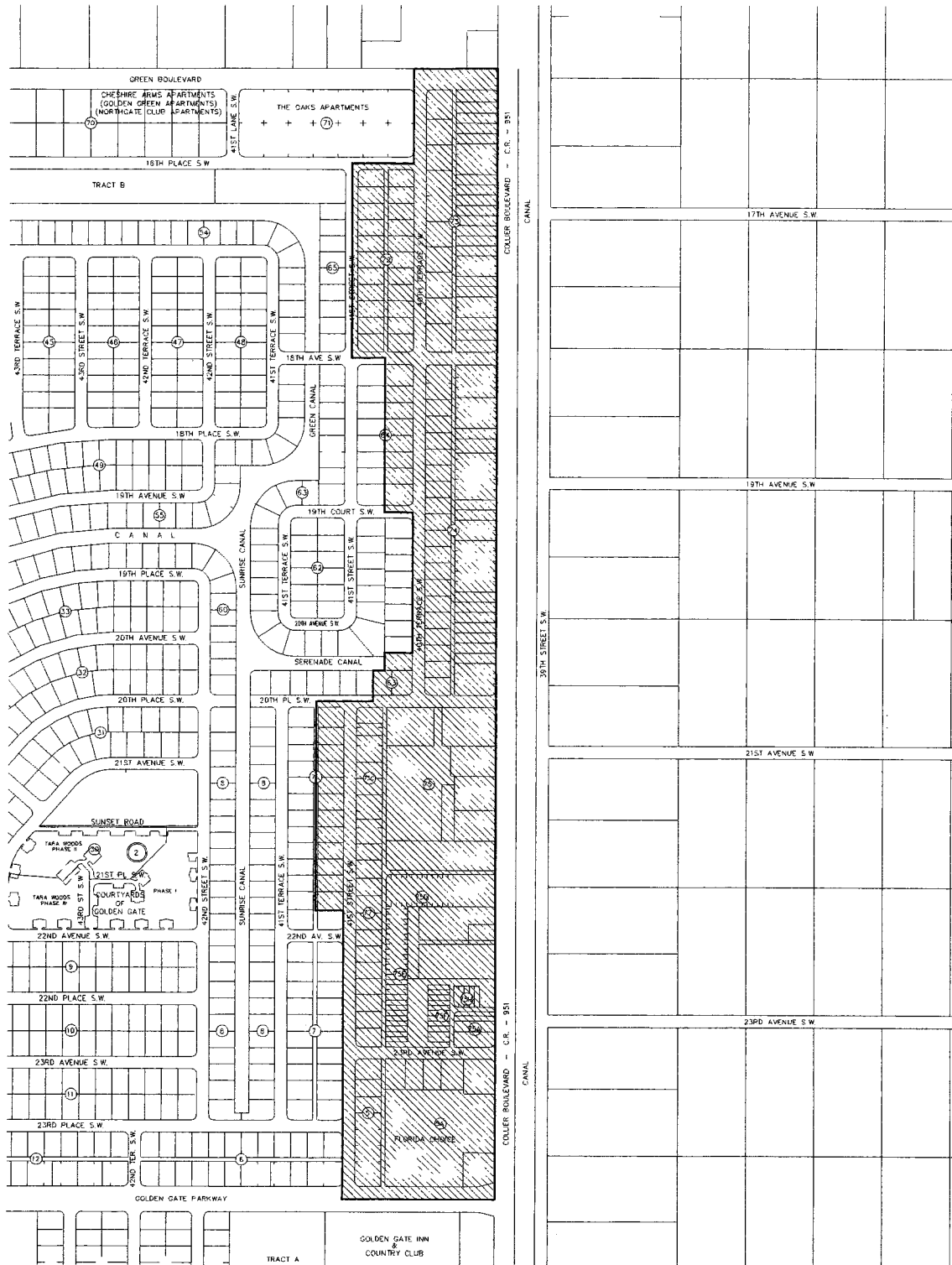

PREPARED BY: GRAPHICS AND TECHNICAL SUPPORT SECTION
COMMUNITY DEVELOPMENT AND ENVIRONMENTAL SERVICES DIVISION
FILE: GGMP-51A-2008.DWG DATE: 3/2008

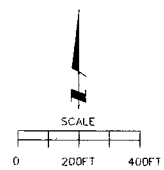

ADOPTED - OCTOBER 26, 2004
(Ord. No. 2004-71)

AMENDED - JANUARY 25, 2007
(Ord. No. 2007-19)

LEGEND

**COLLIER BOULEVARD
COMMERCIAL
SUBDISTRICT**

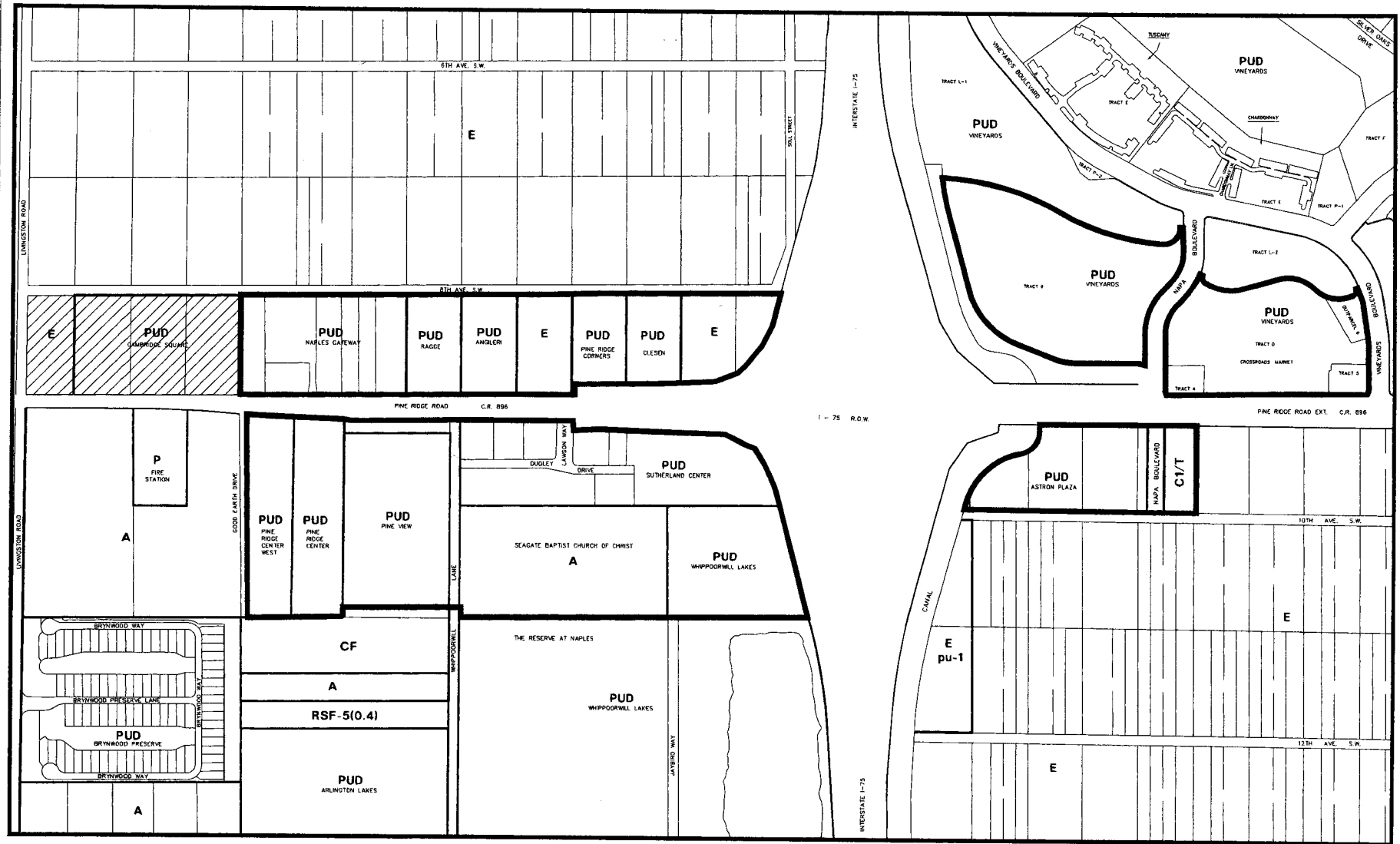

AMENDED - SEPTEMBER 10, 2003
(Ord. No. 2003-44)

AMENDED - JANUARY 25, 2007
(Ord. No. 2007-19)

DRAWN BY: GRAPHICS AND TECHNICAL SUPPORT SECTION
COMMUNITY DEVELOPMENT AND ENVIRONMENTAL SERVICES DIVISION
FILE: GGMP-PRIC-AC-3-2008.DWG DATE: 3/2008

PINE RIDGE ROAD (C.R. 896) - INTERCHANGE
ACTIVITY CENTER
AND
PINE RIDGE ROAD MIXED USE SUBDISTRICT

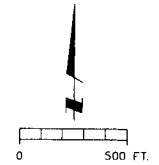

LEGEND	
	ACTIVITY CENTER BOUNDARY
	EXISTING ZONING
	PINE RIDGE ROAD MIXED USE SUBDISTRICT

GOLDEN GATE ESTATES NEIGHBORHOOD CENTERS

Collier County, Florida

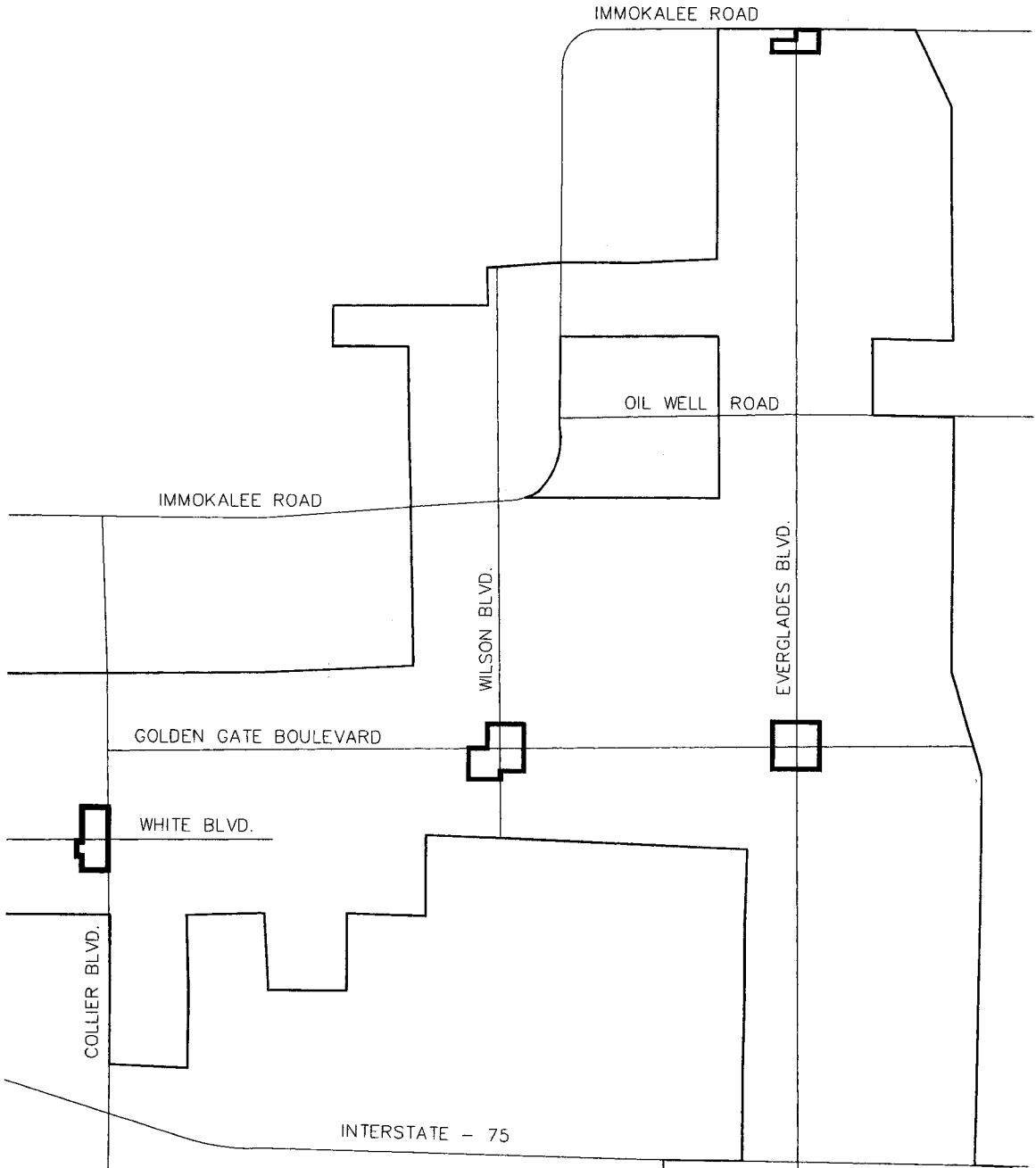

AMENDED - SEPTEMBER 10, 2003 (Ord. No. 2003-44)
AMENDED - OCTOBER 26, 2004 (Ord. No. 2004-71)
AMENDED - JANUARY 25, 2007 (Ord. No. 2007-19)

PREPARED BY: GRAPHICS AND TECHNICAL SUPPORT SECTION
 COMMUNITY DEVELOPMENT AND ENVIRONMENTAL SERVICES DIVISION
 FILE: GCMP-47-2008.DWG DATE: 3/2008

GOLDEN GATE ESTATES NEIGHBORHOOD CENTERS	
LEGEND	
—	NEIGHBORHOOD CENTERS

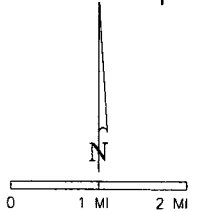

WILSON BOULEVARD/GOLDEN GATE BOULEVARD CENTER

Collier County, Florida

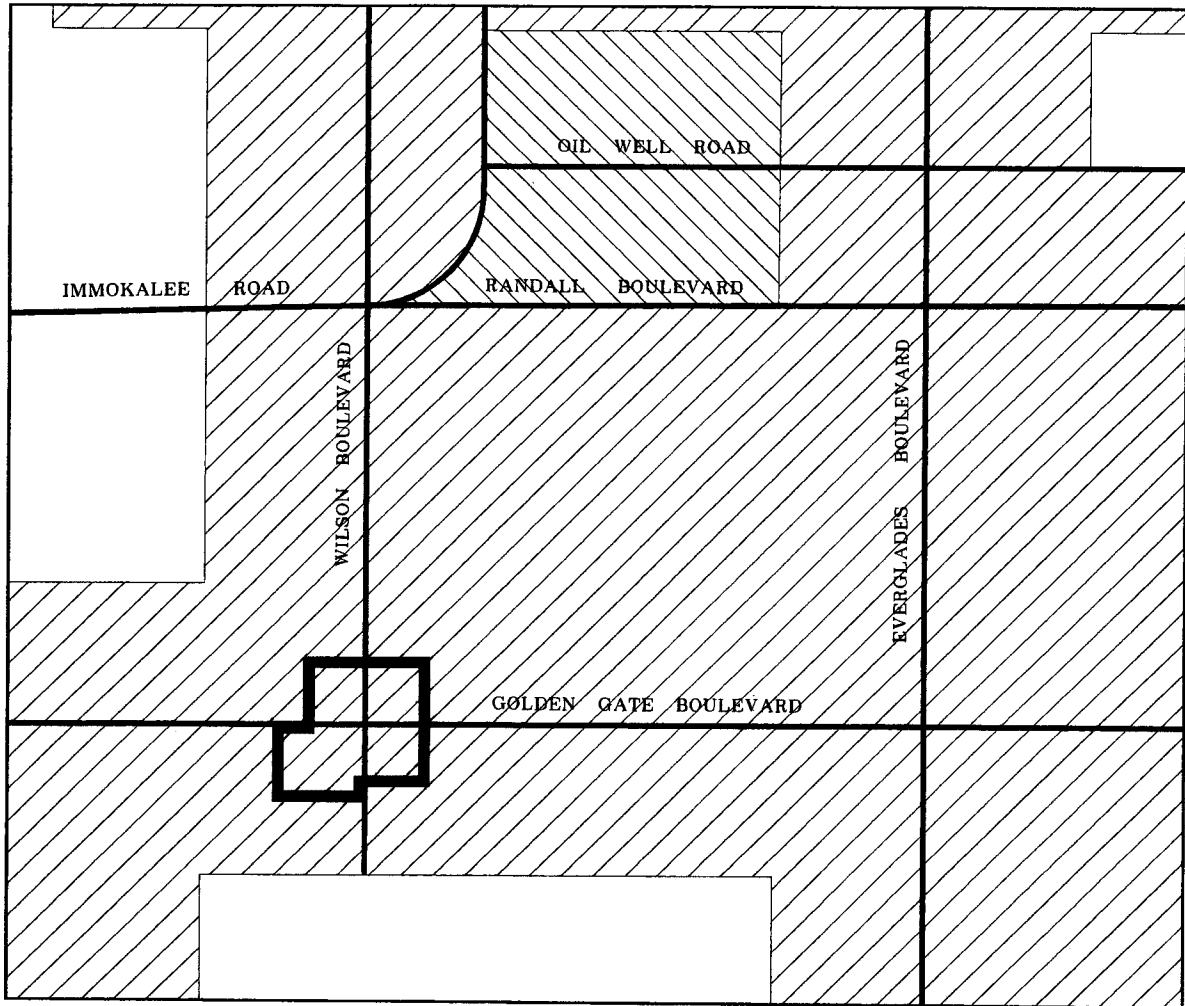

ADOPTED - SEPTEMBER 10, 2003 (Ord. No. 2003-44)
AMENDED - JANUARY 25, 2007 (Ord. No. 2007-19)
AMENDED - DECEMBER 4, 2007 (Ord. No. 2007-76)

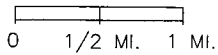

PREPARED BY: GRAPHICS AND TECHNICAL SUPPORT SECTION
 COMMUNITY DEVELOPMENT AND ENVIRONMENTAL SERVICES DIVISION
 FILE: GGMP-43-2008.DWG DATE: 3/2008



LEGEND

	GOLDEN GATE ESTATES		SETTLEMENT AREA
	NEIGHBORHOOD CENTER		

GOLDEN GATE BOULEVARD/EVERGLADES BOULEVARD CENTER

Collier County, Florida

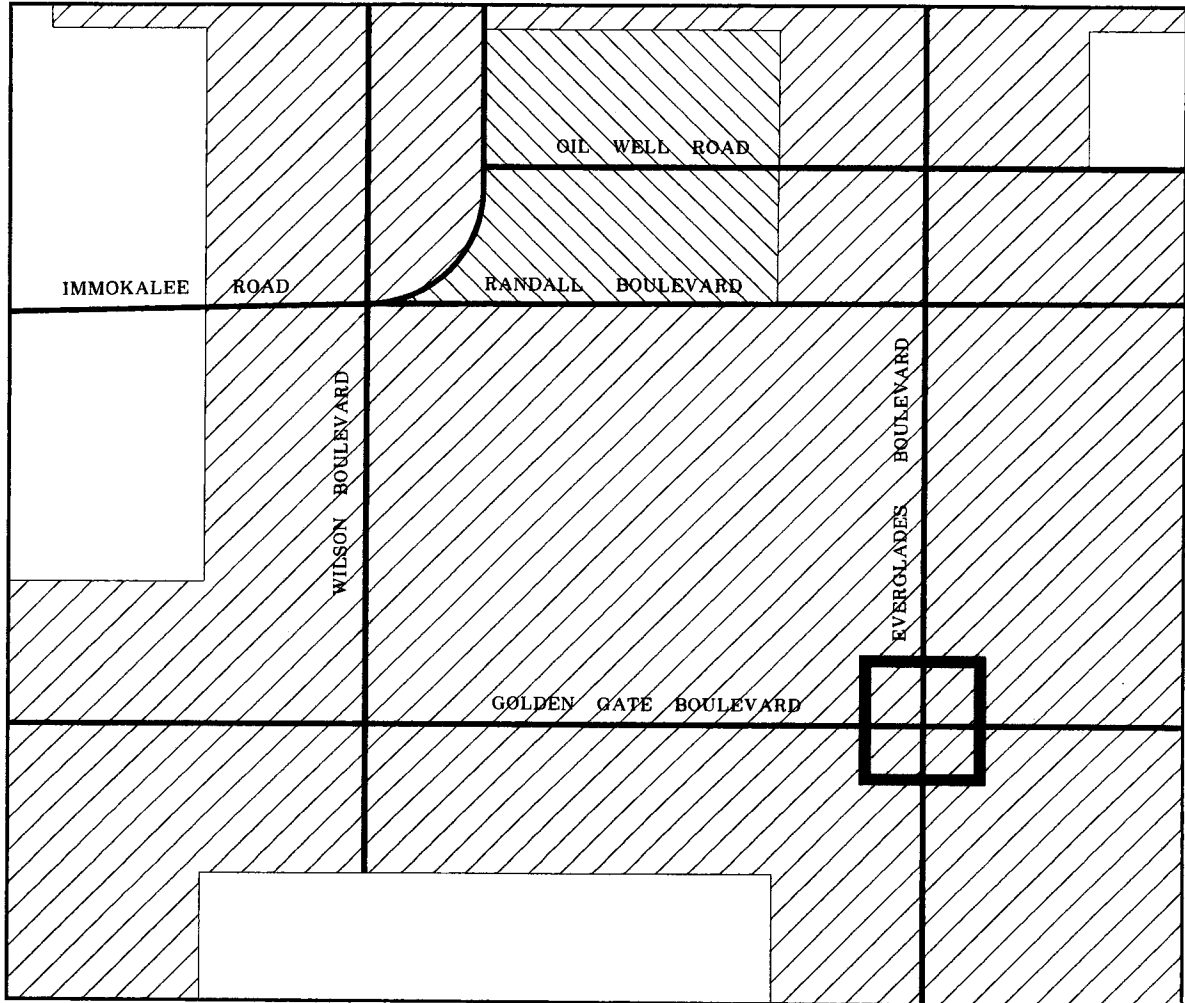

ADOPTED - SEPTEMBER 10, 2003
(Ord. No. 2003-44)

AMENDED - JANUARY 25, 2007
(Ord. No. 2007-19)

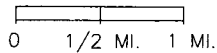

PREPARED BY: GRAPHICS AND TECHNICAL SUPPORT SECTION
COMMUNITY DEVELOPMENT AND ENVIRONMENTAL SERVICES DIVISION
FILE: CGMP-45-2008.DWG DATE: 3/2008

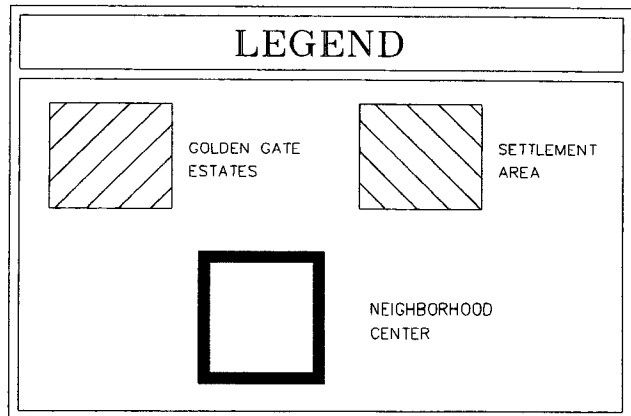

IMMOKALEE ROAD/EVERGLADES BOULEVARD CENTER

Collier County, Florida

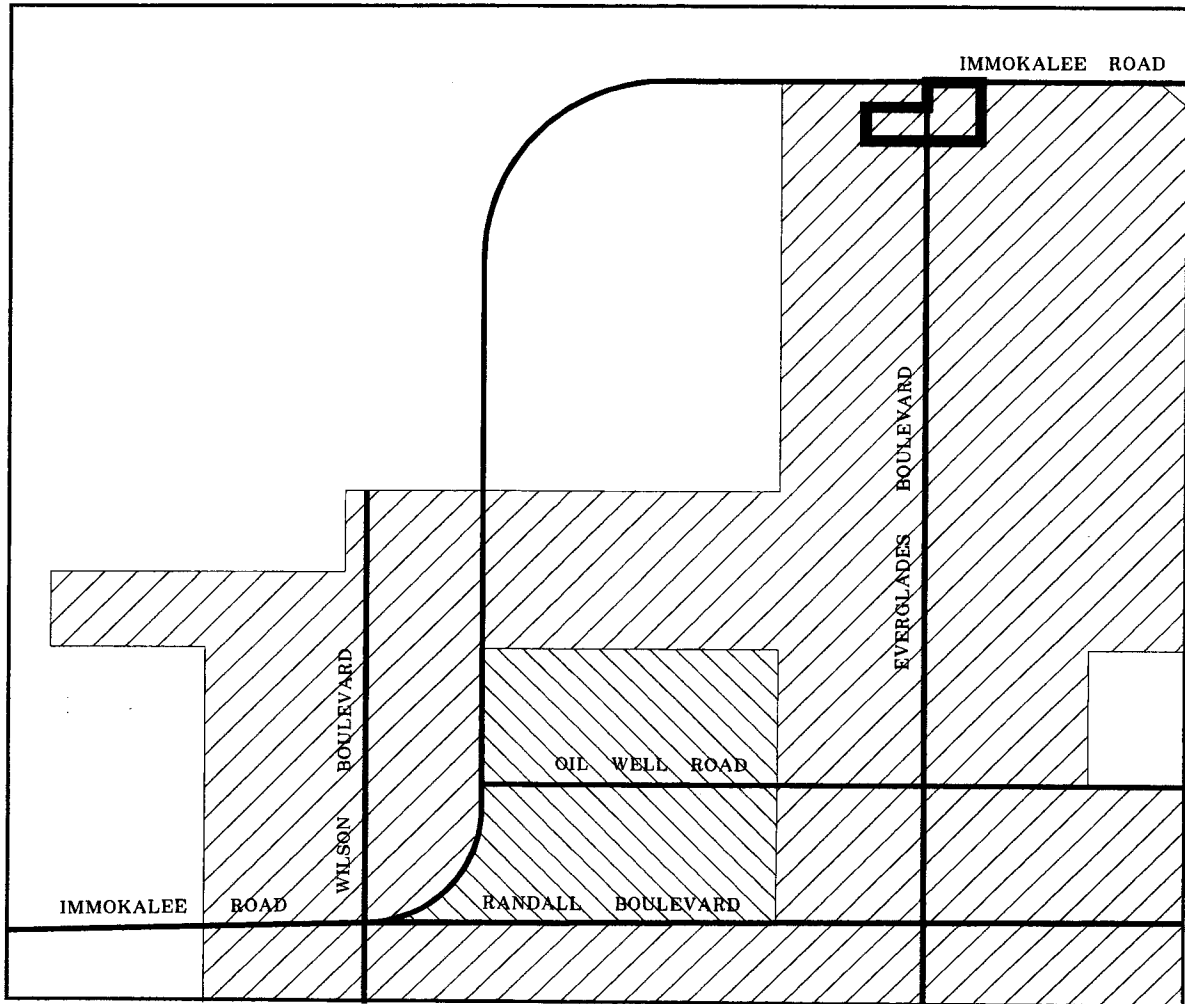

AMENDED - SEPTEMBER 10, 2003 (Ord. No. 2003-44)
AMENDED - OCTOBER 26, 2004 (Ord. No. 2004-71)
AMENDED - JANUARY 25, 2007 (Ord. No. 2007-19)

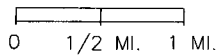

PREPARED BY: GRAPHICS AND TECHNICAL SUPPORT SECTION
 COMMUNITY DEVELOPMENT AND ENVIRONMENTAL SERVICES DIVISION
 FILE: GGMP-44-2008.DWG DATE: 3/2008

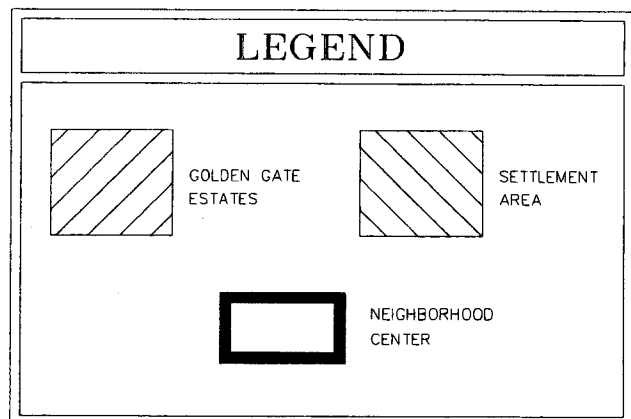

RANDALL BOULEVARD COMMERCIAL SUBDISTRICT

Collier County, Florida

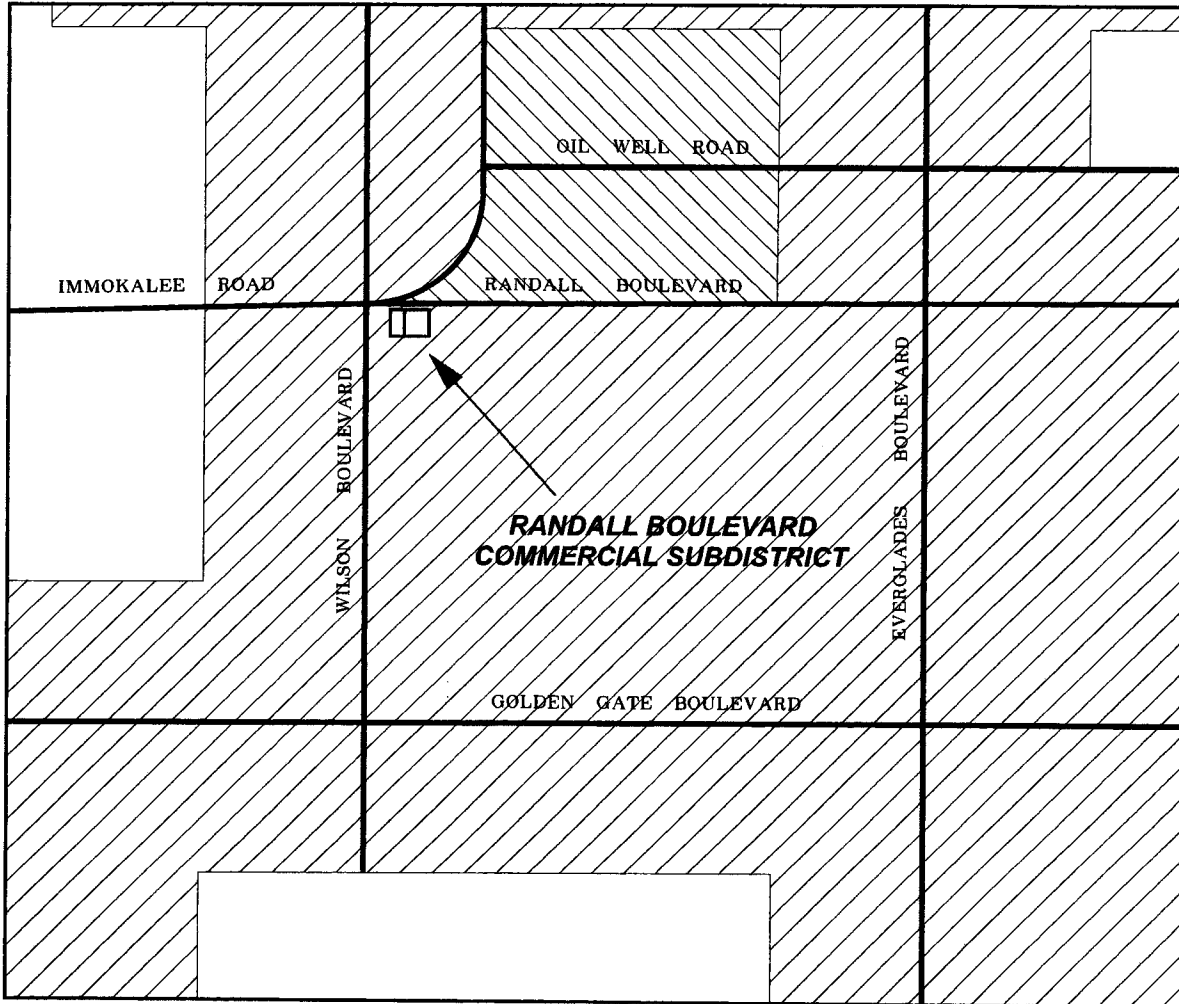

AMENDED - SEPTEMBER 10, 2003
(Ord. No. 2003-44)

AMENDED - JANUARY 25, 2007
(Ord. No. 2007-19)

0 1/2 MI. 1 MI.

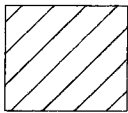
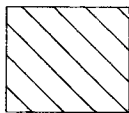

LEGEND

	GOLDEN GATE ESTATES		SETTLEMENT AREA
-------------------------------------------------------------------------------------	---------------------	---------------------------------------------------------------------------------------	-----------------

COMMERCIAL WESTERN ESTATES INFILL SUBDISTRICT

Collier County, Florida

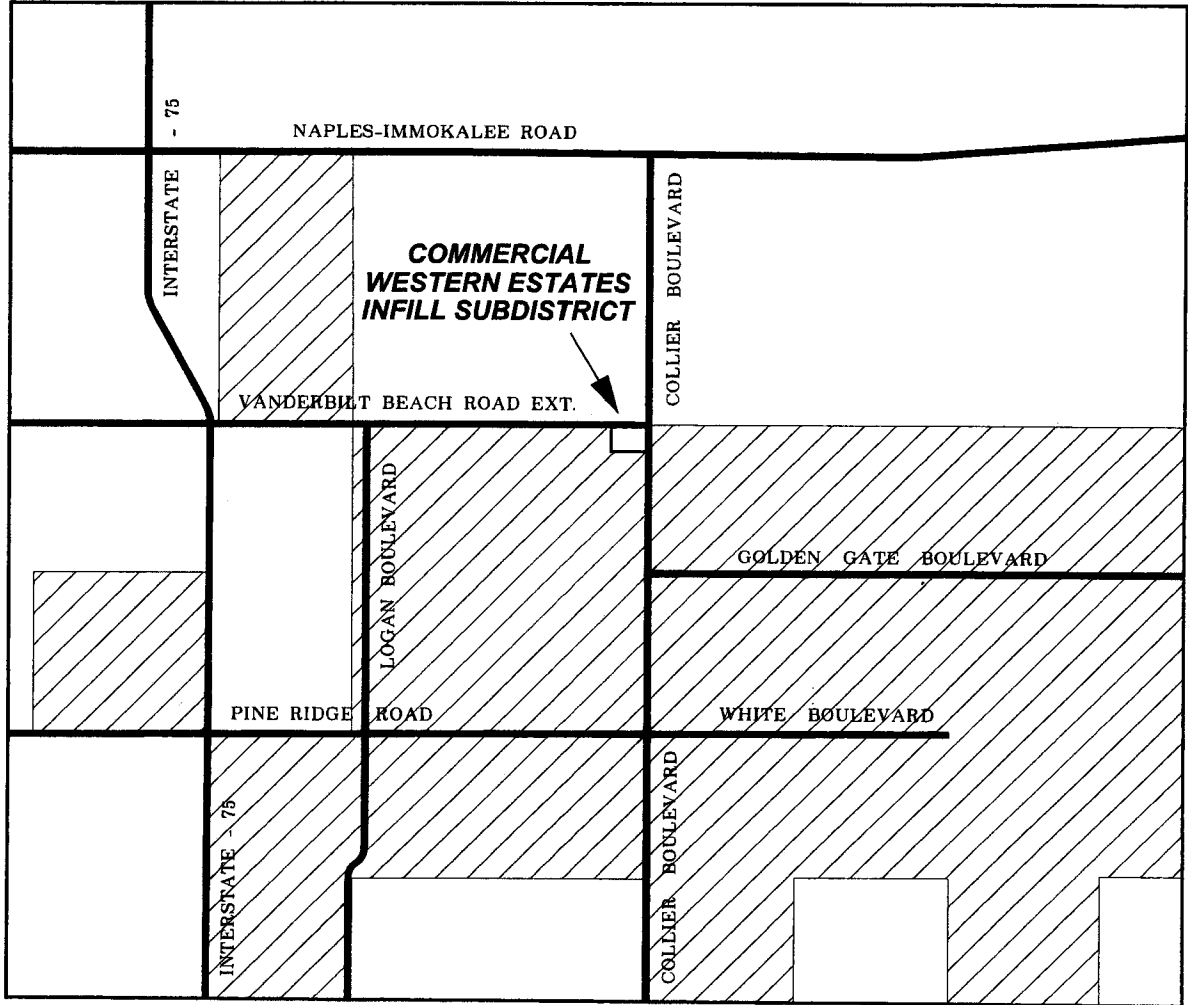

AMENDED - SEPTEMBER 10, 2003 (Ord. No. 2003-44)
AMENDED - OCTOBER 26, 2004 (Ord. No. 2004-71)
AMENDED - JANUARY 25, 2007 (Ord. No. 2007-19)

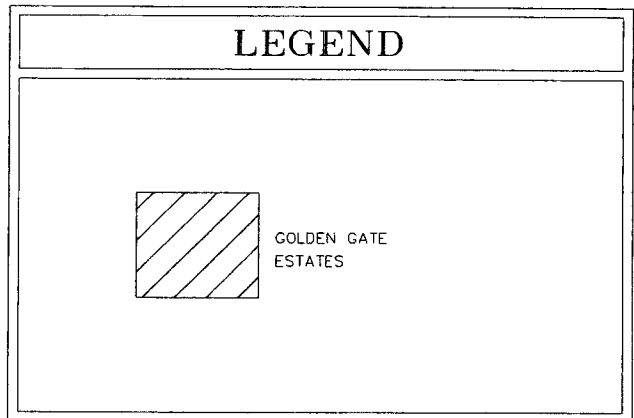
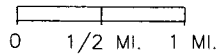

GOLDEN GATE PARKWAY INTERCHANGE CONDITIONAL USES AREA

Collier County, Florida

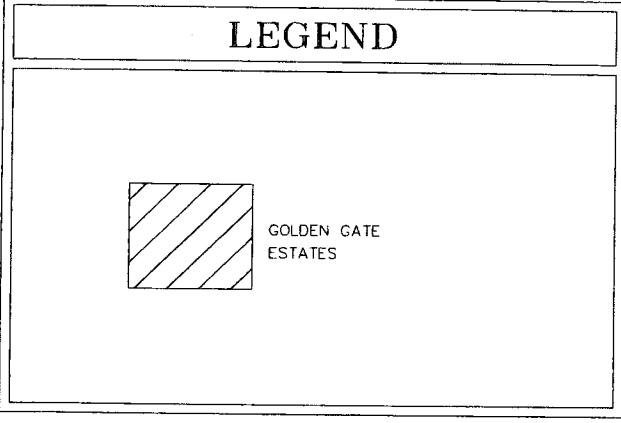
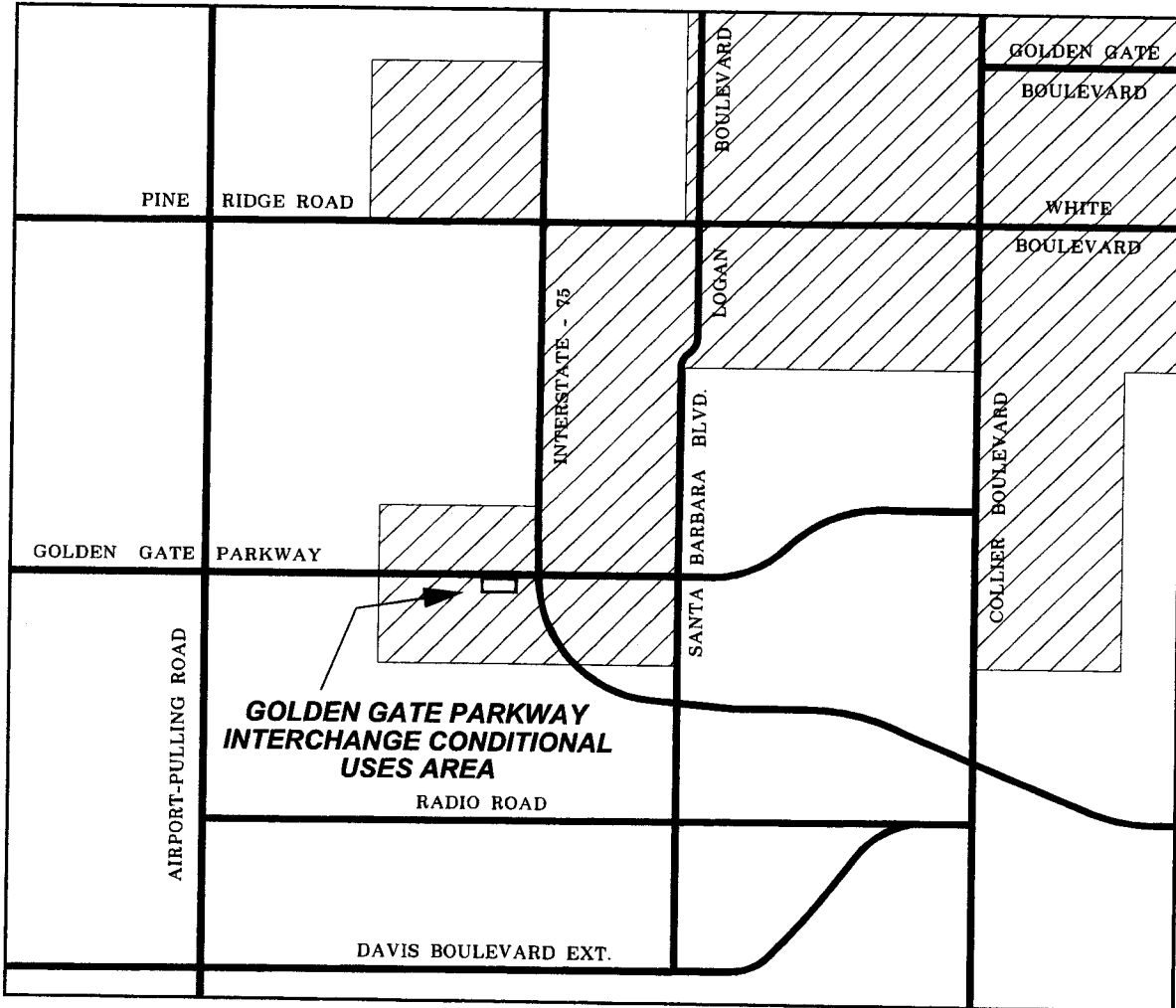

ADOPTED - SEPTEMBER 10, 2003
(Ord. No. 2003-44)

AMENDED - JANUARY 25, 2007
(Ord. No. 2007-19)

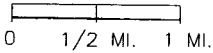

PREPARED BY: GRAPHICS AND TECHNICAL SUPPORT SECTION
COMMUNITY DEVELOPMENT AND ENVIRONMENTAL SERVICES DIVISION
FILE: GGMP-49-2008.DWG DATE: 3/2008

COLLIER BOULEVARD/PINE RIDGE ROAD CENTER

Collier County, Florida

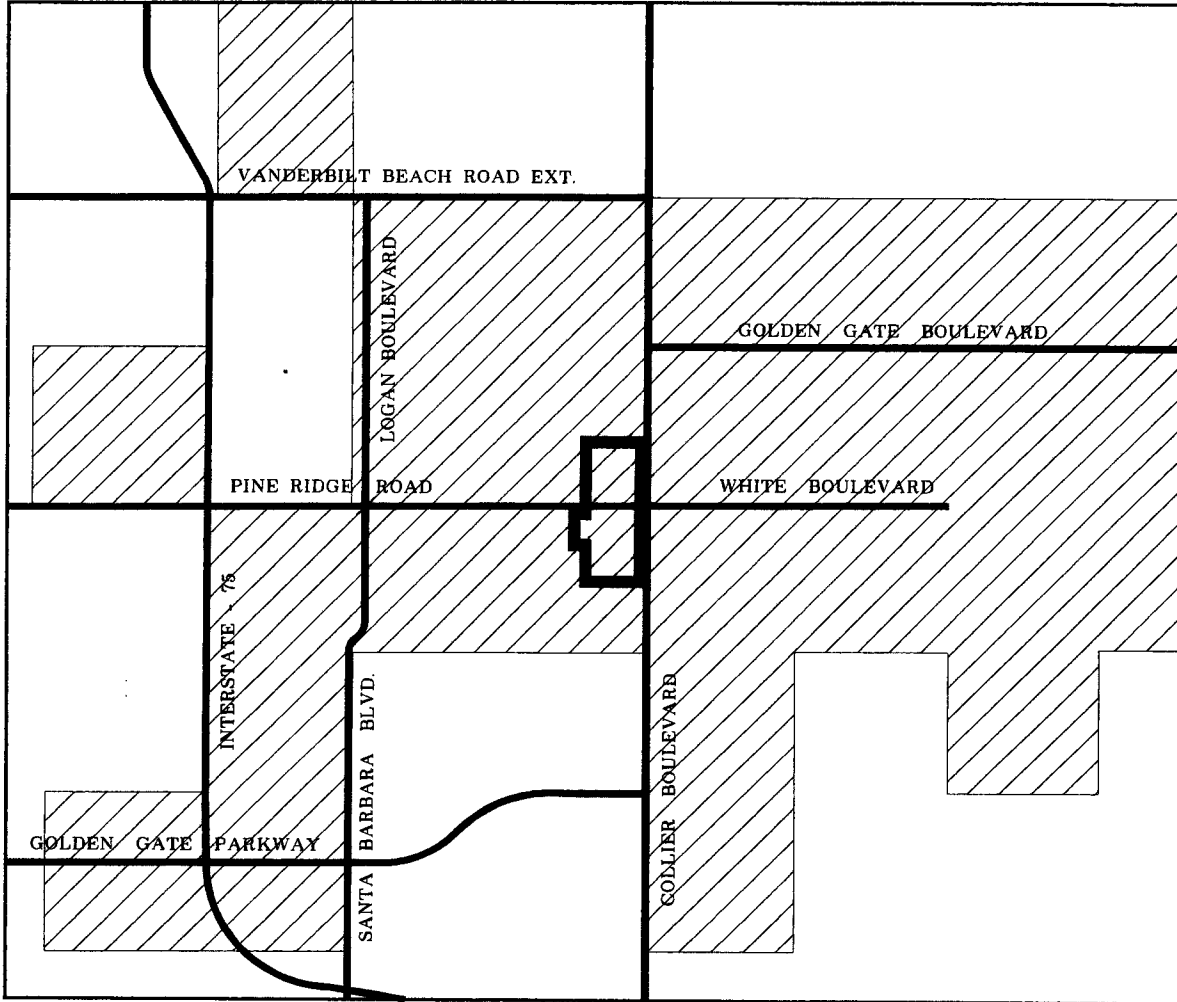

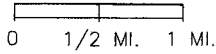

ADOPTED - SEPTEMBER 10, 2003
(Ord. No. 2003-44)

AMENDED - JANUARY 25, 2007
(Ord. No. 2007-19)

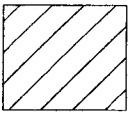

LEGEND

	GOLDEN GATE ESTATES		NEIGHBORHOOD CENTER
-------------------------------------------------------------------------------------	---------------------	---------------------------------------------------------------------------------------	---------------------