

NORTH BELLE MEADE OVERLAY MAP

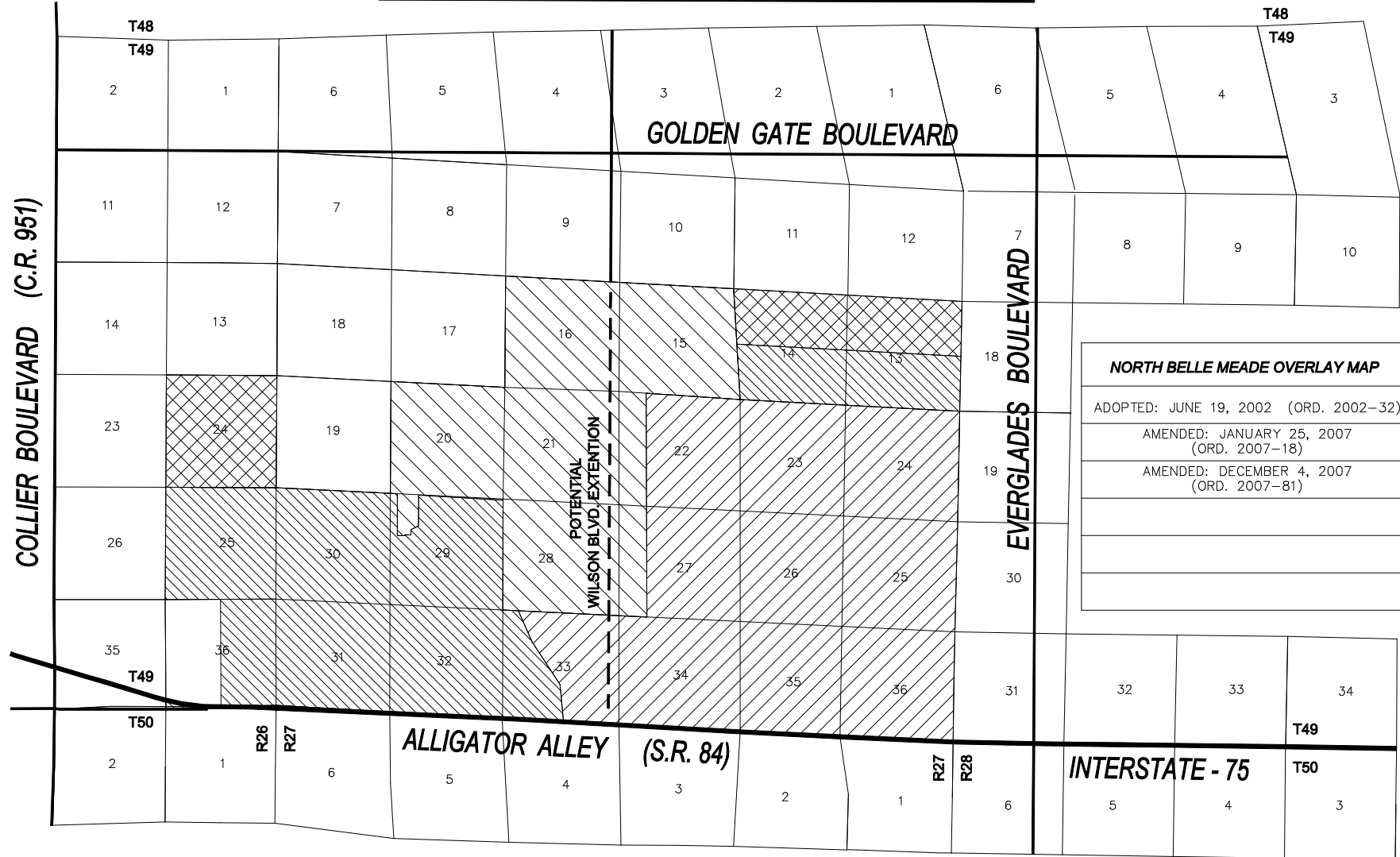

NORTH BELLE MEADE OVERLAY MAP
ADOPTED: JUNE 19, 2002 (ORD. 2002-32)
AMENDED: JANUARY 25, 2007 (ORD. 2007-18)
AMENDED: DECEMBER 4, 2007 (ORD. 2007-81)

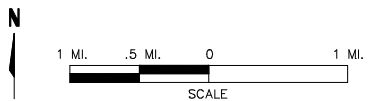

LEGEND			
	SENDING		NEUTRAL
	NRPA SENDING		RECEIVING

PREPARED BY: GRAPHICS AND TECHNICAL SUPPORT SECTION
 COMMUNITY DEVELOPMENT AND ENVIRONMENTAL SERVICES DIVISION
 DATE: 12/2007 FILE: NBM-OVERLAY-MAP-2007-3.DWG

NOTE: THIS MAP CANNOT BE INTERPRETED WITHOUT THE GOALS, OBJECTIVES AND POLICIES OF THE COLLIER COUNTY GROWTH MANAGEMENT PLAN.